

DETAIL 1  
1/2"=1'-0"

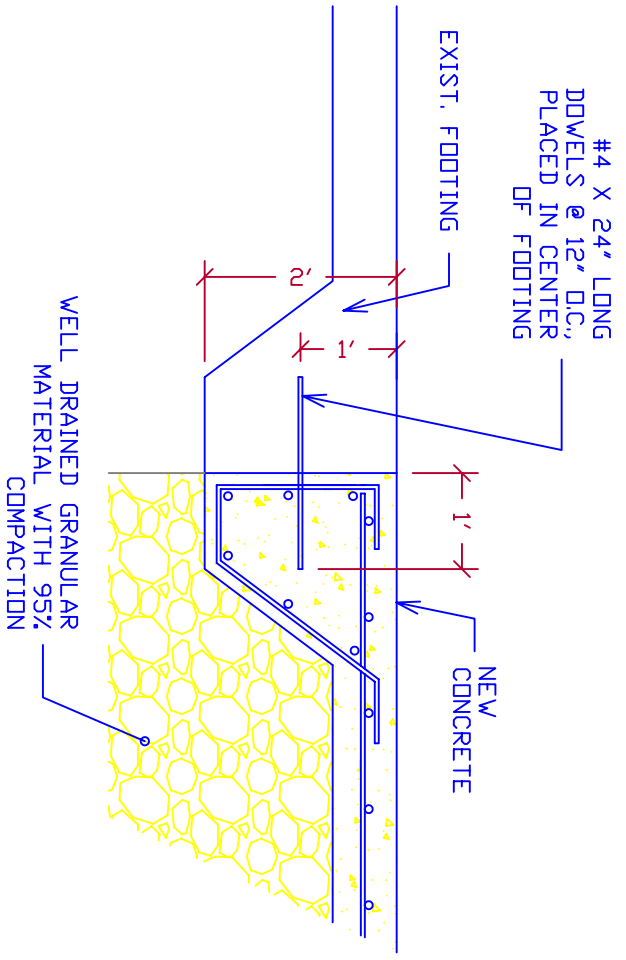

DETAIL 2  
1/2"=1'-0"

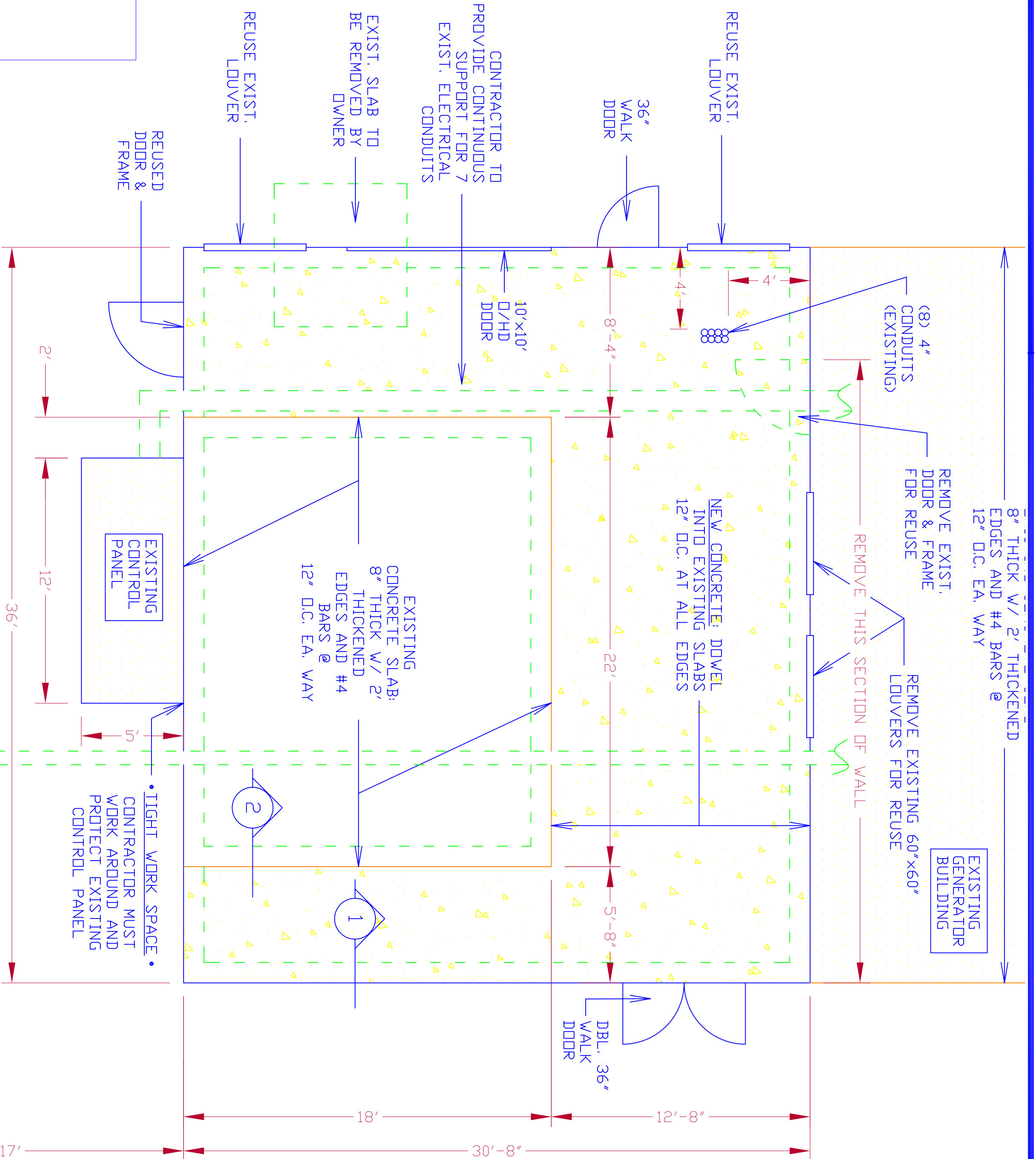
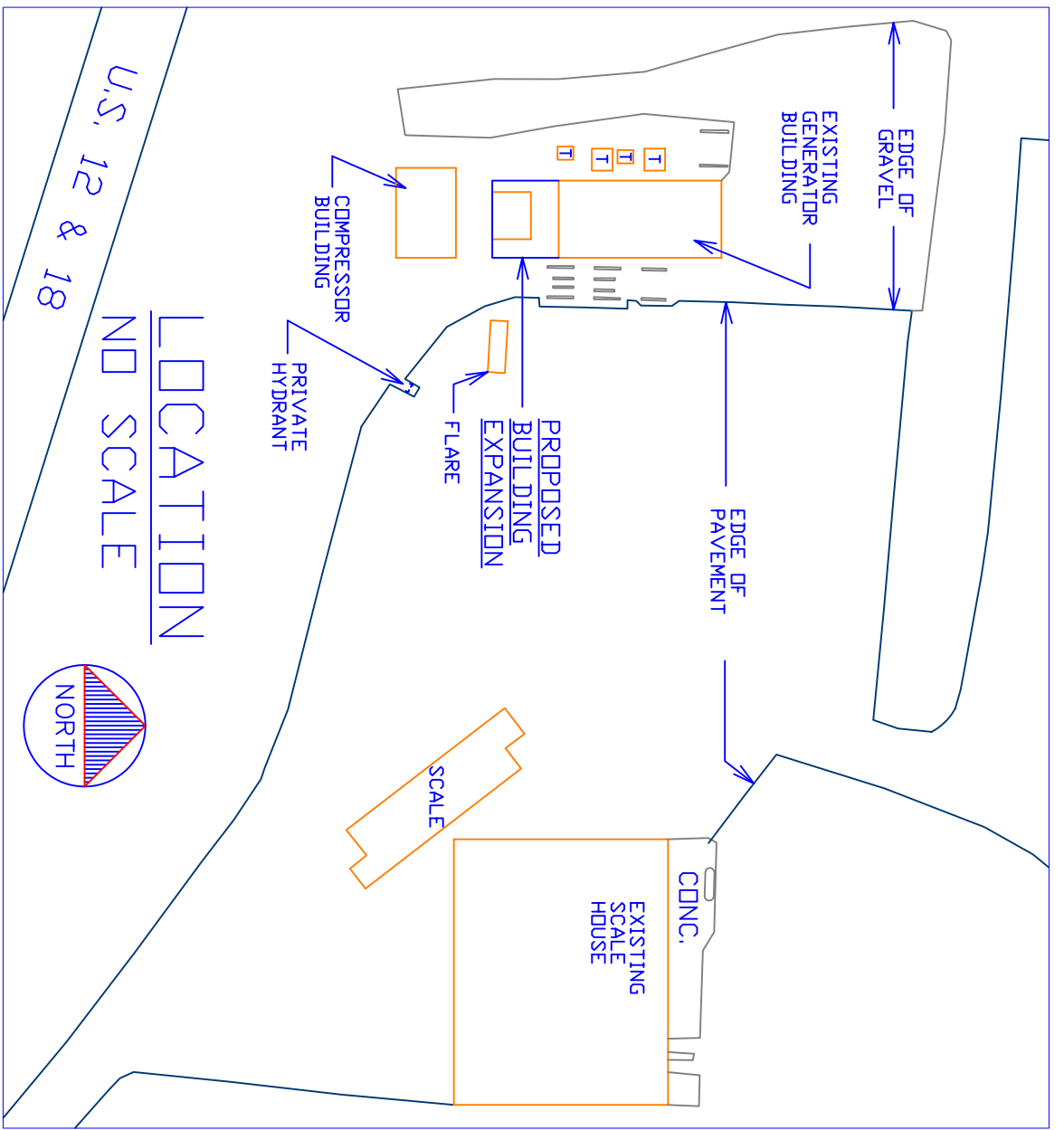

- NOTES:
- ADDITION TO MATCH EXISTING 12' EA.VE, 5'x12' ROOF SLOPE
  - FIELD VERIFY ALL DIMENSIONS
  - CONTRACTOR SHALL FIELD VERIFY ALL BURIED UTILITIES

- TIGHT WORK SPACE. CONTRACTOR MUST WORK AROUND AND PROTECT EXISTING CONTROL PANEL
- CONTRACTOR TO PROVIDE CONTINUOUS SUPPORT FOR EXIST. 8" SCHED. 10 GAS LINE

SITE PLAN  
1/4"=1'-0"

GEN. BLDG. EXPANSION  
RODEFELD LANDFILL #2  
7102 HWY. 12 & 18  
DANE COUNTY, WISCONSIN

DEPARTMENT OF PUBLIC WORKS  
DANE COUNTY WISCONSIN

Design By: JEW  
Drawn By: JRL  
Approved By: MD  
Bid No.: 810007  
Date: 3/5/10  
Scale: AS NOTED

Sheet 1  
of 1