

LEGEND

- 975 --- EXISTING GRADE (5' CONTOUR)
- 970 --- EXISTING GRADE (1' CONTOUR)
- — — — — PROPERTY LINE
- ==== PAVED ROAD
- UNPAVED ROAD
- ===== FIRE ACCESS ROAD
- ▭ CULVERT/STORM SEWER
- FIELD INLET
- ▭ PERFORATED BIoretENTION BASIN UNDERDRAIN PIPING
- ▭ NON-PERFORATED BIoretENTION BASIN UNDERDRAIN PIPING
- — — — — SANITARY SEWER
- — — — — GAS
- — — — — ELECTRIC
- — — — — TELEPHONE
- — — — — WATER
- MANHOLE
- ⊗ WATER VALVE
- ⊙ LIGHT POLE
- ⊕ HYDRANT
- ⊞ ELECTRICAL JUNCTION BOX
- ⊞ LANDFILL TEST WELL (APPROXIMATE)
- ⊞ TRANSFORMER
- x — x — x — FENCE

CONTROL POINT INFORMATION

CP NO.	NORTHING	EASTING	ELEVATION	DESCRIPTION
1	365358.675	2095877.944	984.874	NW CORNER OF SECTION 14, ALUM. MON. SET NEAR THE SOUTH R.O.W. LINE OF CROSS COUNTRY ROAD WEST OF THE DRIVEWAY FOR 6861 CROSS COUNTRY ROAD.
2	365351.827	2095841.804	1006.992	NW CORNER OF NE 1/4 SECTION 14, ALUM. MON. SET NEAR THE SOUTH R.O.W. LINE OF CROSS COUNTRY ROAD.
3	362348.280	2098689.950	953.310	BRASS CAP SET IN CONCRETE MARKED WITH ORANGE FIBERGLASS POSTS LOCATED SOUTH OF CTR. HWY. NEAR ENTRANCE TO MILITARY RIDGE PARKING LOT.
4	365319.557	2101198.849	995.344	NE CORNER OF SECTION 14, BRASS CAP SET NEAR TEN SOUTH R.O.W. LINE OF CROSS COUNTRY ROAD.

- NOTES:
- EXISTING TOPOGRAPHY BASED ON SITE SURVEYS PERFORMED BY DANE COUNTY ON JUNE 12, 2013 (PERIMETER SWALE, GEOTHERMAL BERM, AND SOUTH OF FOOD SERVICE/ADMIN. BUILDING PARKING LOT), AND BY SCS ENGINEERS ON OCTOBER 26, 2011 (BR4, BR7, AND WEST DRY DETENTION BASIN) AND NOVEMBER 13, 14, AND 20, 2013 (REMAINING AREAS).
 - BUILDING, PARKING LOT, SIDEWALK AND ROAD LAYOUT FROM B17, INC. EROSION CONTROL PLAN DRAWING C4, DATED OCTOBER 16, 2012.
 - UTILITIES OBTAINED FROM B17, INC. UTILITIES PLAN DRAWING, DATED JULY 20, 2012, WITH MODIFICATIONS PROVIDED BY DANE COUNTY.
 - THE LOCATIONS OF EXISTING UTILITIES SHOWN ON THESE PLANS ARE APPROXIMATE. THERE MAY BE OTHER UTILITIES WITHIN THE PROJECT AREA THAT ARE NOT SHOWN. CONTRACTOR IS REQUIRED TO VERIFY SITE CONDITIONS AND SUBSURFACE UTILITIES PRIOR TO STARTING WORK. PRIVATE UTILITY LOCATORS OTHER THAN DIGERS HOTLINE MAY BE REQUIRED PER CONTRACT DOCUMENTS.

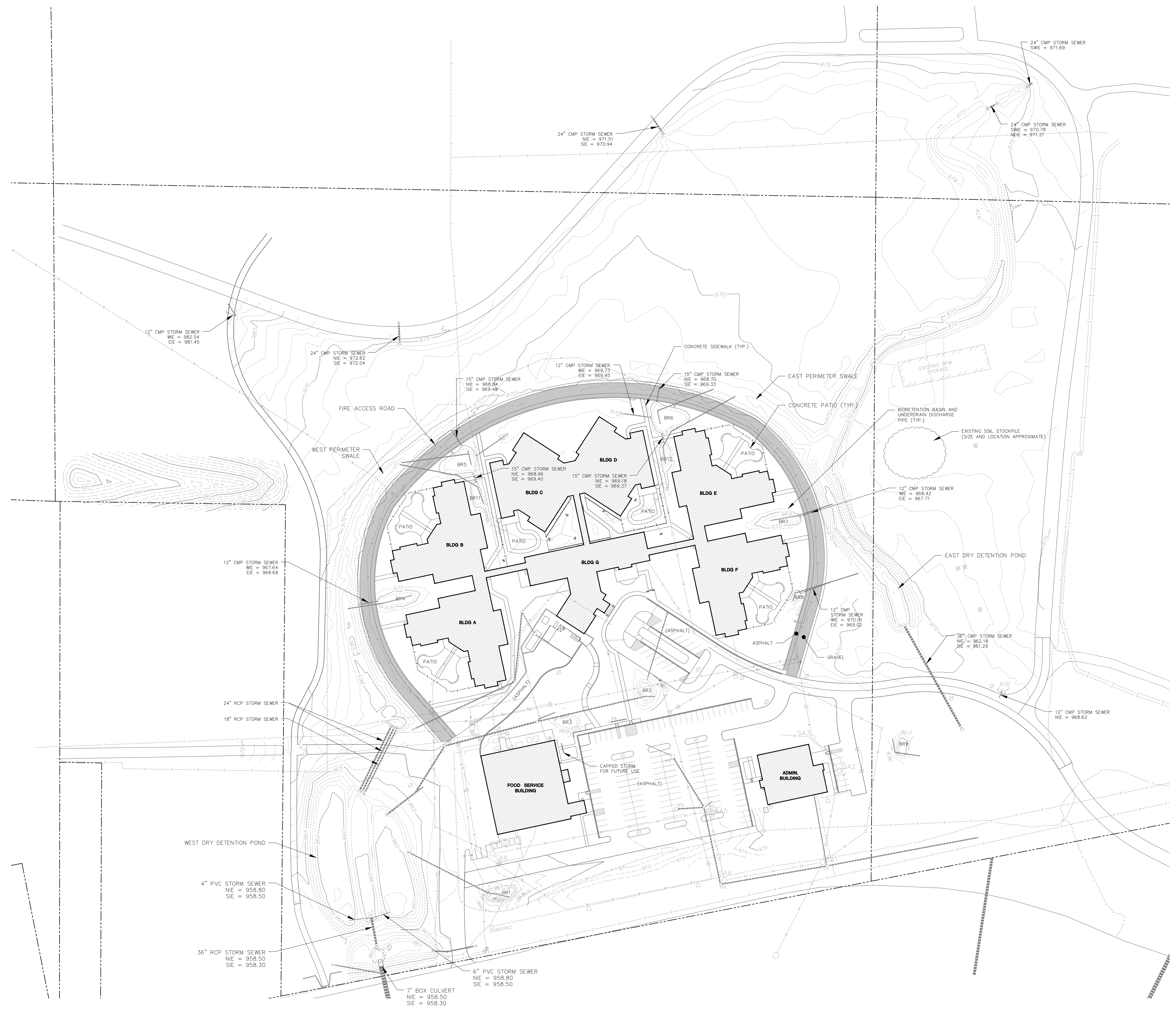
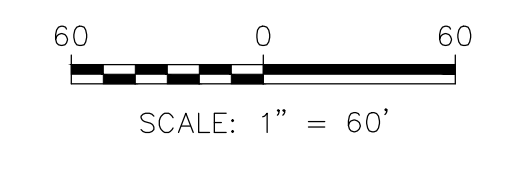

25212311.00.dwg
 07/22/14
 04/24/14

LEGEND	
	EXISTING GRADE (5' CONTOUR)
	EXISTING GRADE (1' CONTOUR)
	PROPOSED GRADE (5' CONTOUR)
	PROPOSED GRADE (1' CONTOUR)
	PROPERTY LINE
	EXISTING PAVED ROAD
	EXISTING UNPAVED ROAD
	EXISTING FIRE ACCESS ROAD
	EXISTING CULVERT/STORM SEWER
	EXISTING FIELD INLET
	EXISTING PERFORATED BIOTENTION BASIN UNDERDRAIN PIPING
	EXISTING NON-PERFORATED BIOTENTION BASIN UNDERDRAIN PIPING
	EXISTING SANITARY SEWER
	EXISTING GAS
	EXISTING ELECTRIC
	EXISTING TELEPHONE
	EXISTING WATER
	EXISTING MANHOLE
	EXISTING WATER VALVE
	EXISTING LIGHT POLE
	EXISTING HYDRANT
	EXISTING ELECTRICAL JUNCTION BOX (APPROXIMATE)
	EXISTING LANDFILL TEST WELL (APPROXIMATE)
	EXISTING TRANSFORMER (APPROXIMATE)
	EXISTING FENCE
	PROPOSED OUTLET PROTECTION (PERMANENT)
	PROPOSED SEDIMENT LOG (TEMPORARY)
	PROPOSED STONE WEEPER/SEDIMENT TRAP (PERMANENT AND TEMPORARY, AS NOTED)
	PROPOSED EROSION MAT (PERMANENT)
	PROPOSED INLET PROTECTION (TEMPORARY) (SEE EROSION CONTROL NOTE 13)
	PROPOSED SILT FENCE (TEMPORARY)

- EROSION CONTROL NOTES:**
- EROSION CONTROLS SHALL BE INSTALLED PRIOR TO GRADING ACTIVITIES AND SHALL BE PROPERLY MAINTAINED THROUGHOUT CONSTRUCTION UNTIL VEGETATION IS ESTABLISHED. EROSION CONTROL IS THE RESPONSIBILITY OF THE CONTRACTOR DURING CONSTRUCTION AND UNTIL ACCEPTANCE OF THE PROJECT BY THE OWNER.
 - ALL EROSION CONTROL MEASURES AND STORM WATER STRUCTURES SERVING THE SITE MUST BE INSPECTED AT LEAST WEEKLY AND WITHIN 24 HOURS OF A 0.5 INCH OR GREATER RAINFALL. NECESSARY MAINTENANCE AND REPAIRS SHALL BE PERFORMED WITHIN 24 HOURS OF THE INSPECTION.
 - EROSION AND SEDIMENT CONTROL MEASURES SHOWN ON THIS PLAN ARE THE MINIMUM REQUIRED PRECAUTIONS.
 - SEDIMENT REACHING THE PUBLIC ROAD SHALL BE REMOVED BY STREET CLEANING (NOT FLUSHING) BEFORE THE END OF EACH WORKDAY.
 - SITE STABILIZATION AND RESTORATION SHALL BE IN ACCORDANCE WITH "BADGER PRAIRIE STORM WATER FACILITY INSTALLATION SPECIFICATION AND THREE YEAR MANAGEMENT PLAN".
 - A ROW OF SILT FENCE SHALL BE PLACED DOWNSLOPE AND AT LEAST 10 FEET AWAY FROM ANY STOCKPILE. SOIL STOCKPILES THAT ARE INACTIVE FOR MORE THAN 7 CONSECUTIVE DAYS SHALL BE STABILIZED WITH SEED AND MULCH, EROSION MAT, POLYMER, OR COVERED WITH TARPS OR SIMILAR MATERIAL TO PREVENT OR REDUCE THE DISCHARGE OF SEDIMENT ERODING FROM THE STOCKPILE.
 - TEMPORARY STABILIZATION MEASURES SHALL COMMENCE WHEN LAND DISTURBING CONSTRUCTION ACTIVITIES HAVE TEMPORARILY CEASED AND WILL NOT RESUME FOR A PERIOD EXCEEDING 14 CALENDAR DAYS. TEMPORARY STABILIZATION MAY INCLUDE TEMPORARY SEEDING, MULCHING, OR WSDOT TYPE B SOIL STABILIZERS. TEMPORARY SEED SHALL BE IN ACCORDANCE WITH "BADGER PRAIRIE STORM WATER FACILITY INSTALLATION SPECIFICATION AND THREE YEAR MANAGEMENT PLAN".
 - ALL DISTURBED AREAS SHALL RECEIVE A MINIMUM 4 INCHES OF SALVAGED TOPSOIL/TOPSOIL-SEED, FERTILIZER, AND MULCH. RESTORATION SHALL OCCUR AS SOON AFTER THE DISTURBANCE AS PRACTICAL. PERSISTENT AREAS SHALL BE SEEDING IN ACCORDANCE WITH "BADGER PRAIRIE STORM WATER FACILITY INSTALLATION SPECIFICATION AND THREE YEAR MANAGEMENT PLAN".
 - INSTALL EROSION MAT (CLASS I, TYPE B) ON ALL SLOPES 3H:1V OR GREATER. SEE DETAIL WHERE VEGETATIVE MAT IS INSTALLED FOR FINAL RESTORATION AN ADDITIONAL, SEPARATE LAYER OF EROSION MAT IS NOT REQUIRED.
 - REMOVE AND SALVAGE EXISTING RIPRAP AT PROPOSED OUTLET PROTECTION LOCATIONS SHOWN. PLACE GEOTEXTILE AND SALVAGED/NEW RIPRAP IN ACCORDANCE WITH DETAIL.
 - REMOVE TEMPORARY EROSION CONTROLS UPON COMPLETION OF SITE STABILIZATION AS DIRECTED BY ENGINEER OR OWNER.
 - CONSTRUCT/REPAIR BIOTENTION BASINS AS NOTED ONCE CONTRIBUTING DRAINAGE AREA IS STABILIZED.
 - INLET PROTECTION TO CONFORM WITH WISCONSIN DEPARTMENT OF TRANSPORTATION TYPE A PROTECTION.

- NOTES:**
- EXISTING TOPOGRAPHY BASED ON SITE SURVEYS PERFORMED BY DANE COUNTY ON JUNE 12, 2013 (PERIMETER SWALE, GEOTHERMAL BERM, AND SOUTH OF FOOD SERVICE/ADMIN. BUILDING PARKING LOTS, AND BY SGS ENGINEERS ON OCTOBER 28, 2011 (BR4, BR7, AND WEST DRY DETENTION BASIN) AND NOVEMBER 13, 14, AND 20, 2013 (REMAINING AREAS).
 - BUILDING, PARKING LOT, SIDEWALK AND ROAD LAYOUT FROM B73, INC. EROSION CONTROL PLAN DRAWING CA, DATED OCTOBER 16, 2013.
 - UTILITIES OBTAINED FROM B73, INC. UTILITIES PLAN DRAWING, DATED JULY 20, 2012, WITH MODIFICATIONS PROVIDED BY DANE COUNTY.
 - THE LOCATIONS OF EXISTING UTILITIES SHOWN ON THESE PLANS ARE APPROXIMATE. THERE MAY BE OTHER UTILITIES WITHIN THE PROJECT AREA THAT ARE NOT SHOWN. CONTRACTOR IS REQUIRED TO VERIFY SITE CONDITIONS AND SUBSURFACE UTILITIES PRIOR TO STARTING WORK. PRIVATE UTILITY LOCATORS OTHER THAN BIGGERS HOTLINE MAY BE REQUIRED PER CONTRACT DOCUMENTS.

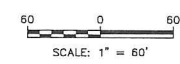

.\SYMBOLS\Diggershotline.jpg
 TO OBTAIN LOCATION OF PARTICIPANTS' UNDERGROUND FACILITIES BEFORE YOU DIG IN WISCONSIN
 TOLL FREE: (800) 242-8511
 TDD: (800) 542-2289
 ONLINE: WWW.DIGGERSHOTLINE.COM

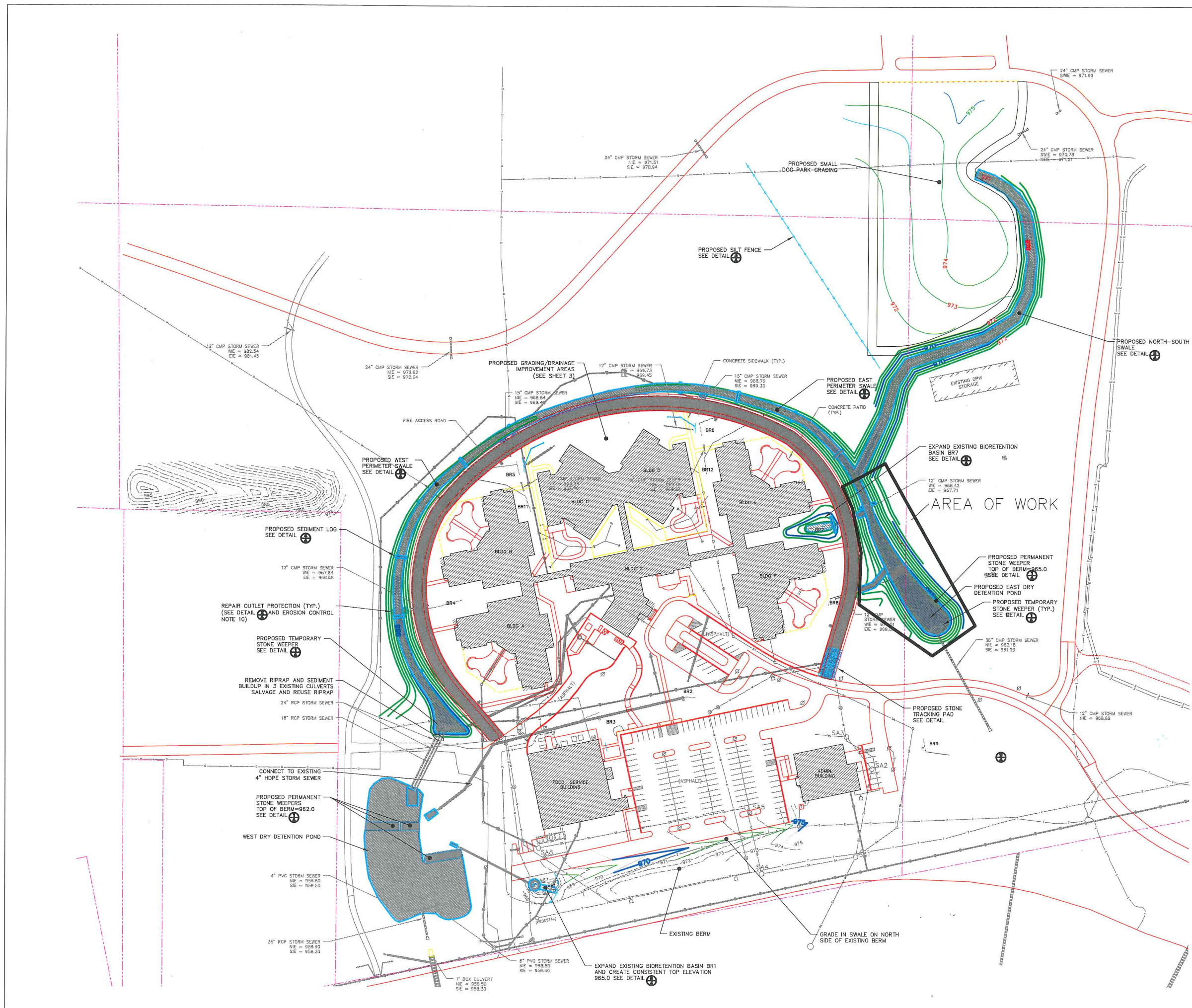

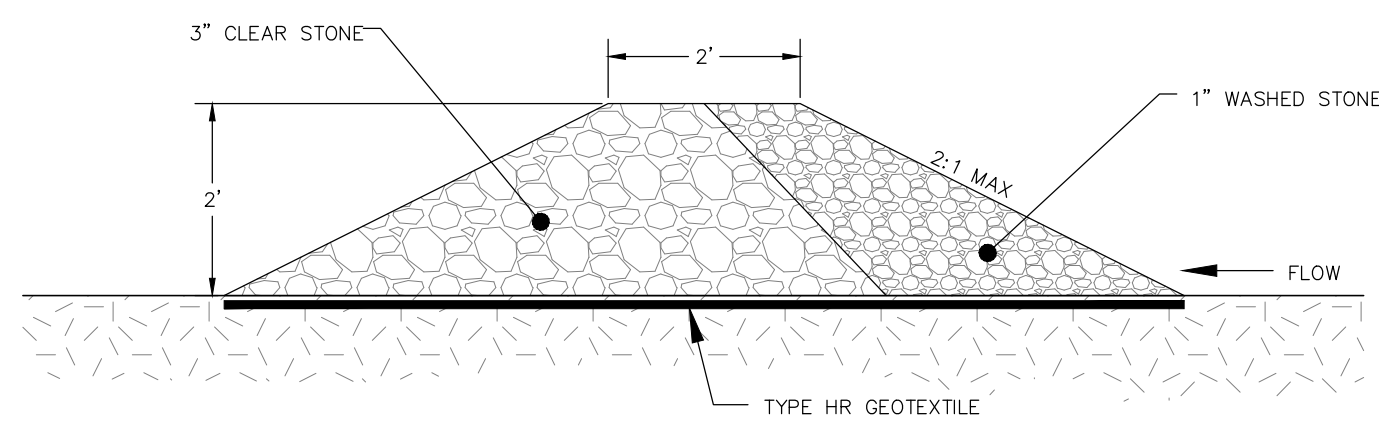

1
STONE WEEPER
1" = 2 FT

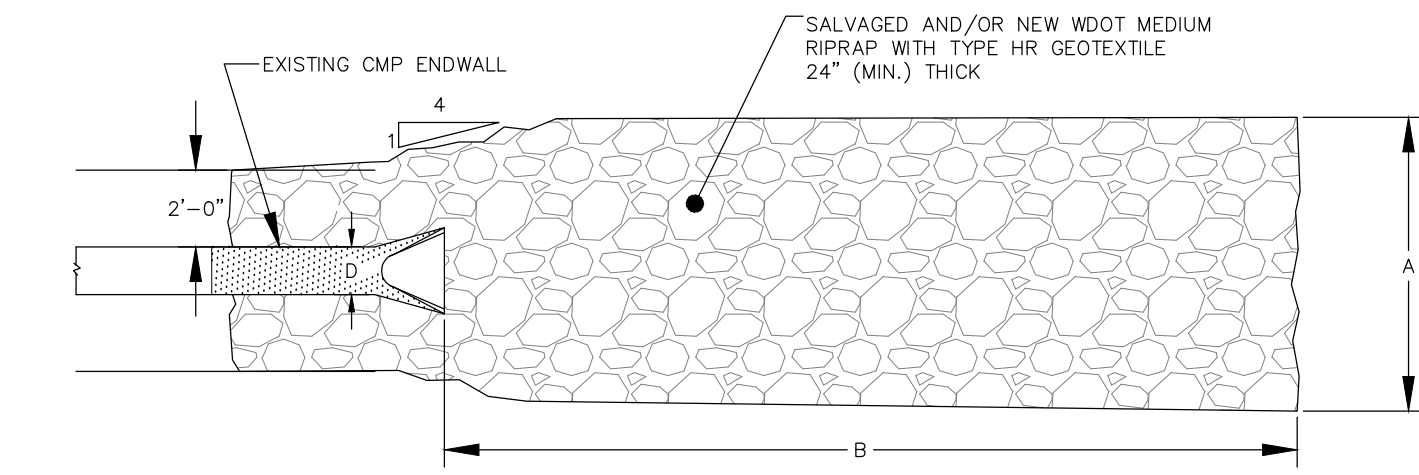

	A	B
DISCHARGE TO SWALE	3 x D	EXTEND ACROSS SWALE BOTTOM TO 8 FT ALONG OPPOSITE SLOPE
DISCHARGE INTO WEST DETENTION POND	20 FT	25 FT

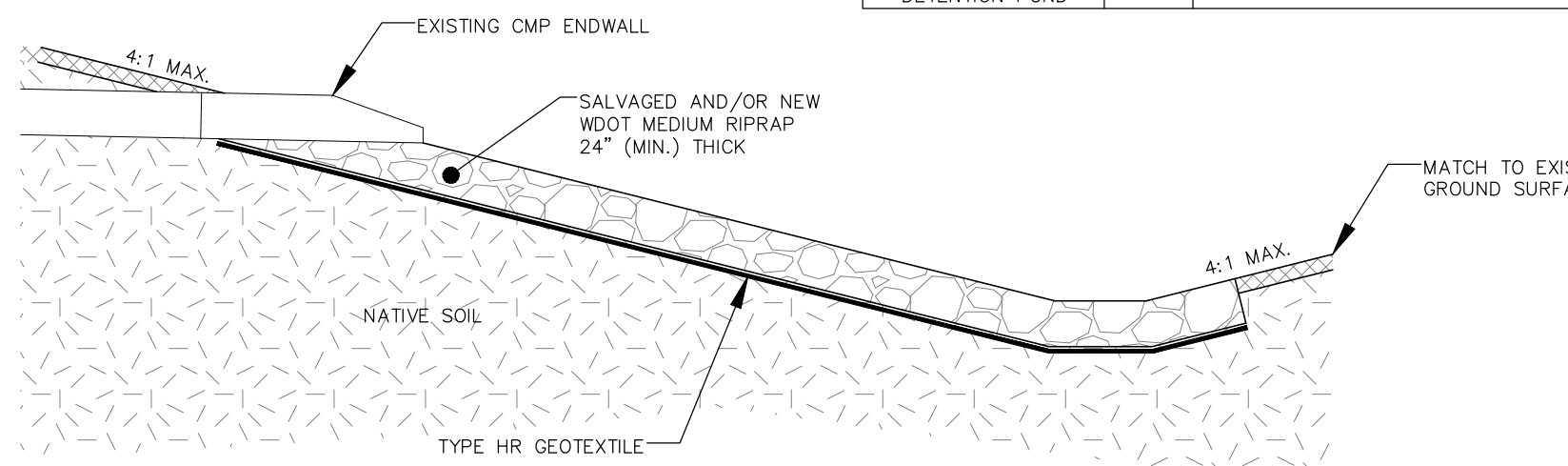

2
RIPRAP OUTLET PROTECTION
(NOT TO SCALE)

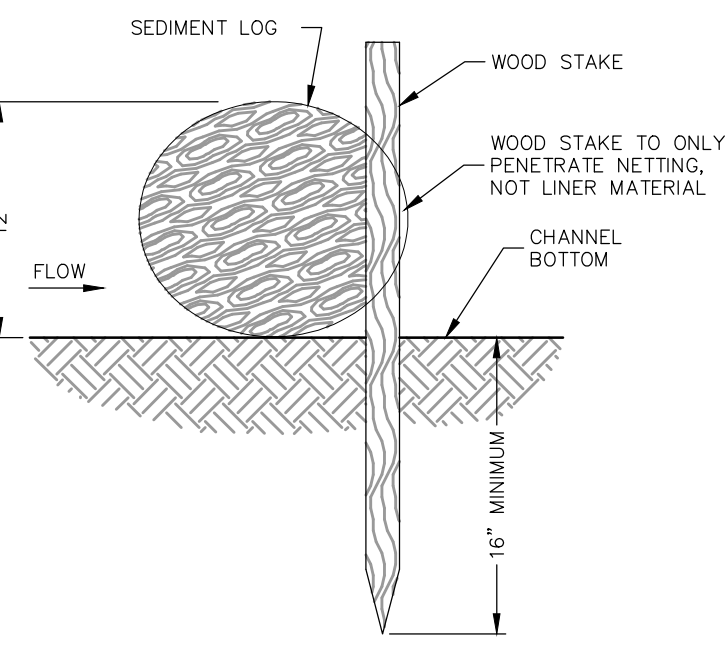
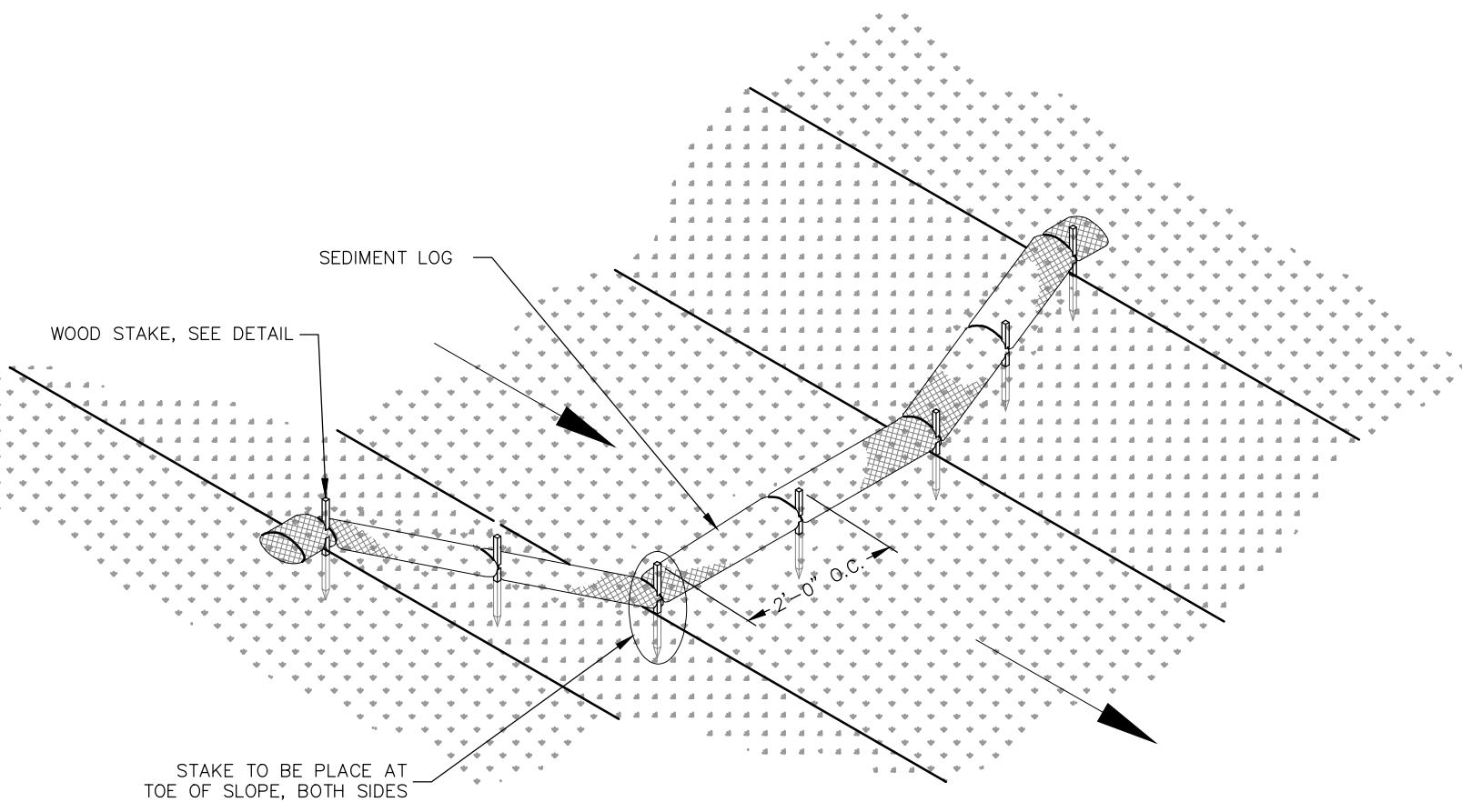

STAKE DETAIL (NO TRENCH)

4
SEDIMENT LOG DETAIL
NOT TO SCALE

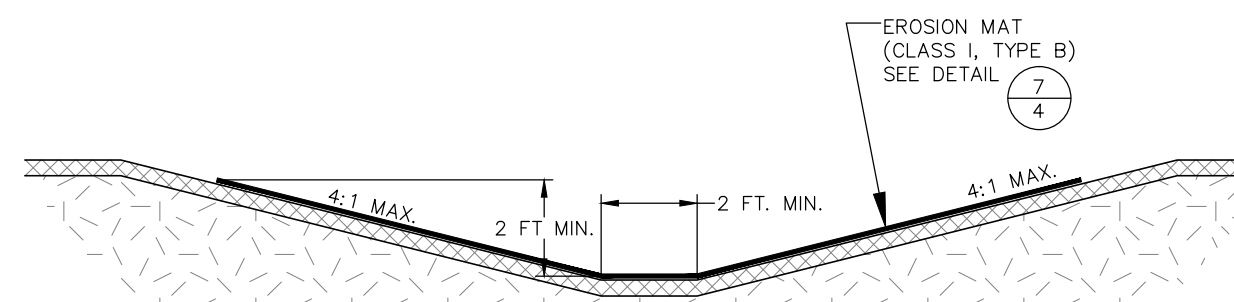

5
PERIMETER SWALE (TYP)
1" = 4 FT

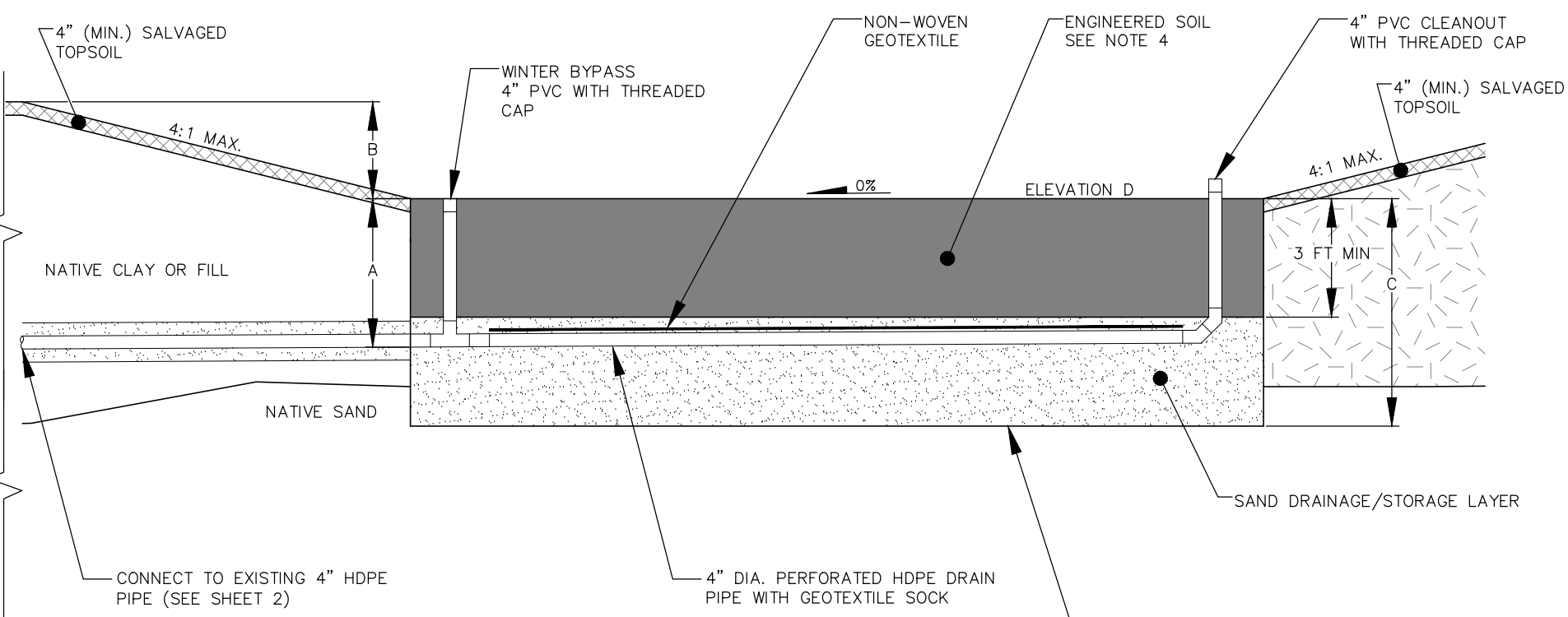

BIORETENTION BASIN	A (FT.)	B (FT.)	C (FT.)	D (FT.)	PLANTING AREA (SQ. FT.)	APPROXIMATE LENGTH (FT.)	APPROXIMATE WIDTH (FT.)
BR10	3	0.5	3	394.5	100	90	5

6
BR10 BIORETENTION DETAIL
NOT TO SCALE

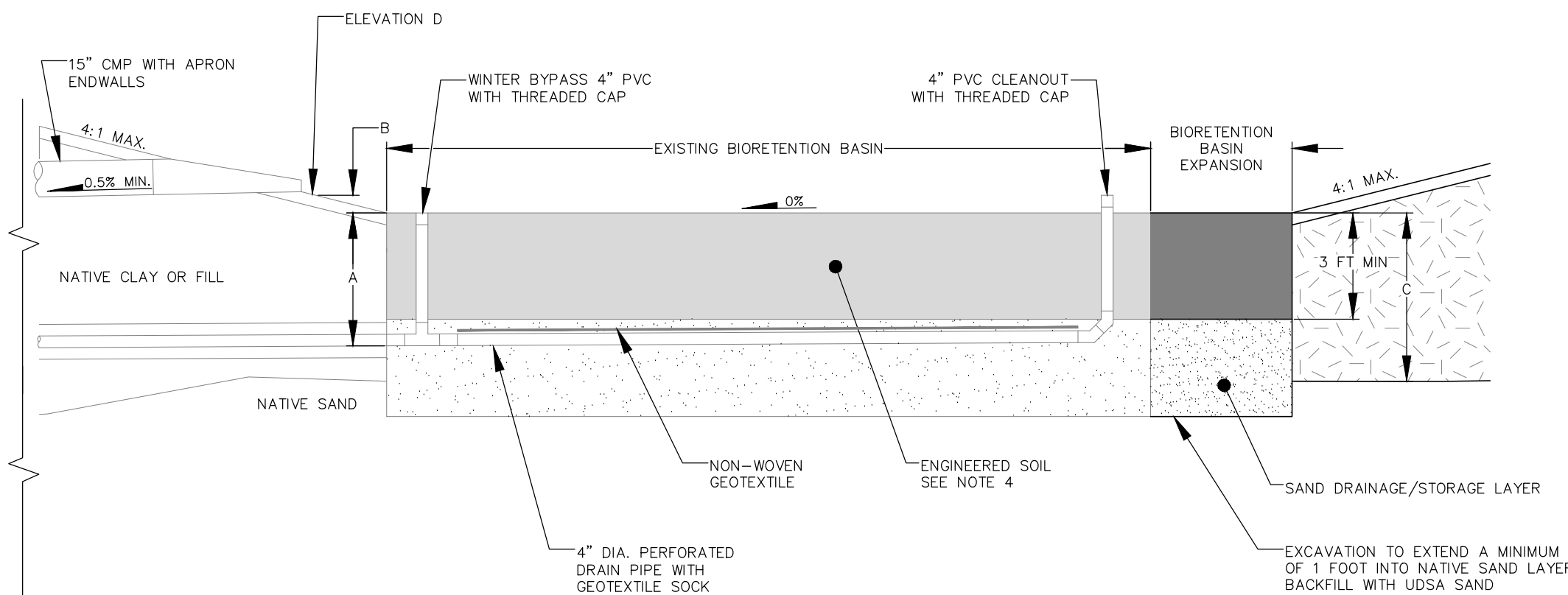

RAINGARDEN	A (FT.)	B (FT.)	C (FT.)	D (FT.)	PLANTING AREA (SQ. FT.)	APPROXIMATE LENGTH (FT.)	APPROXIMATE WIDTH (FT.)
BR7	3	0.5	3	394.5	100	90	5

EXPAND BR7 TO MEET PLANTING AREA. EXISTING PLANTING AREA IS APPROXIMATELY 350 SQUARE FEET.

8
BR7 BIORETENTION DETAIL
NOT TO SCALE

BIORETENTION BASIN NOTES FOR DETAILS

- RAIN GARDEN AND BIORETENTION PLANTING PLAN SPECIES
- ANDROPOGON GERARDI (BIG BLUESTEM)
 - SORGHASTRUM NUTANS (INDIAN GRASS)
 - SIPHIM LACINATUM (COMPASS PLANT)
 - RUBROECIA HIRTA (BLACK-EYED SUSAN)
 - EDHNAECIA PURPUREA (PURPLE CONFLOWER)
 - EUPATORIUM MACULATUM (LICE TAIL WEED)
- NOTES:
- PLUG SIZE PLANTS REQUIRED IN RAIN GARDENS AND BIORETENTION BASINS.
 - PLANTING DENSITY SHALL BE 1 PLANT PER SQUARE FOOT.
 - SURFACE MULCH LAYER SHALL CONSIST OF SHREDDED HARDWOOD MULCH OR CHIPS, AGED A MINIMUM OF 12 MONTHS, SHALL BE PLACED AT THE SURFACE OF THE RAIN GARDEN OR BIORETENTION AREA. THE MULCH SHALL BE 2 TO 3 INCHES IN DEPTH AND FREE OF FOREIGN MATERIAL, INCLUDING OTHER PLANT MATERIAL.
 - ENGINEERED SOIL SHALL COMPLY WITH MNR TECHNICAL STANDARD 1004.
 - CONSTRUCTION OF BIORETENTION BASINS SHALL BE IN ACCORDANCE WITH MNR TECHNICAL STANDARD 1004.

6
4 AND **8**
4

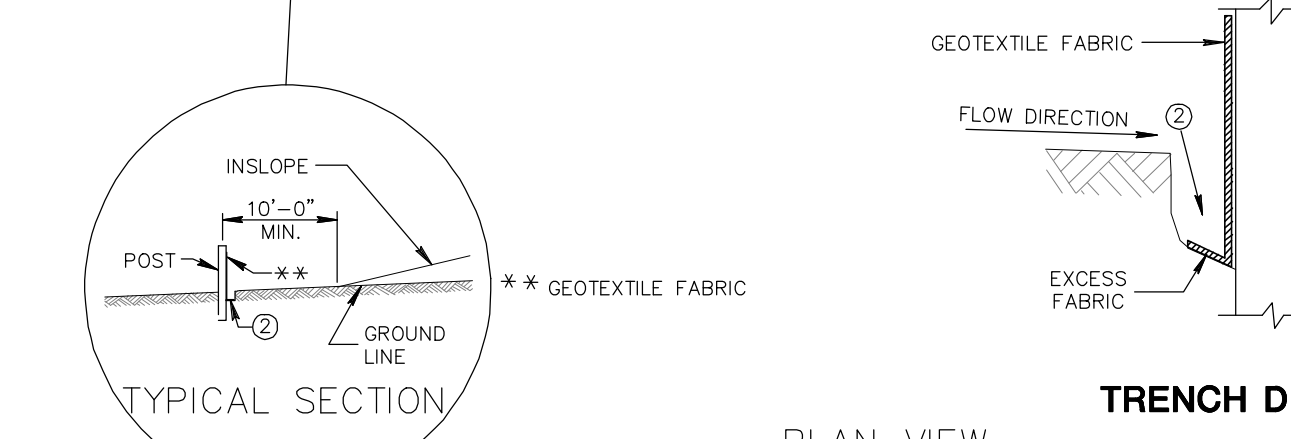
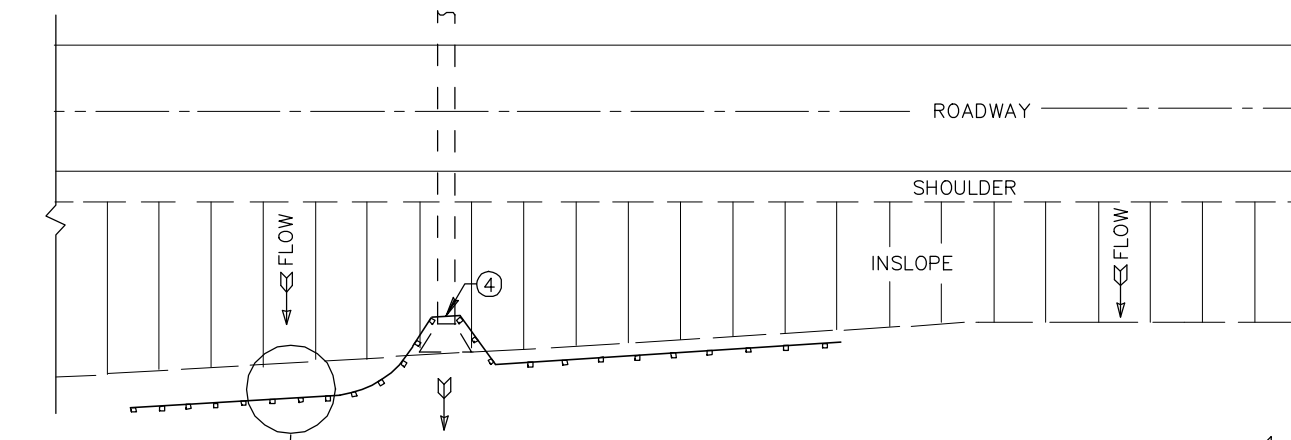

TYPICAL APPLICATION OF SILT FENCE

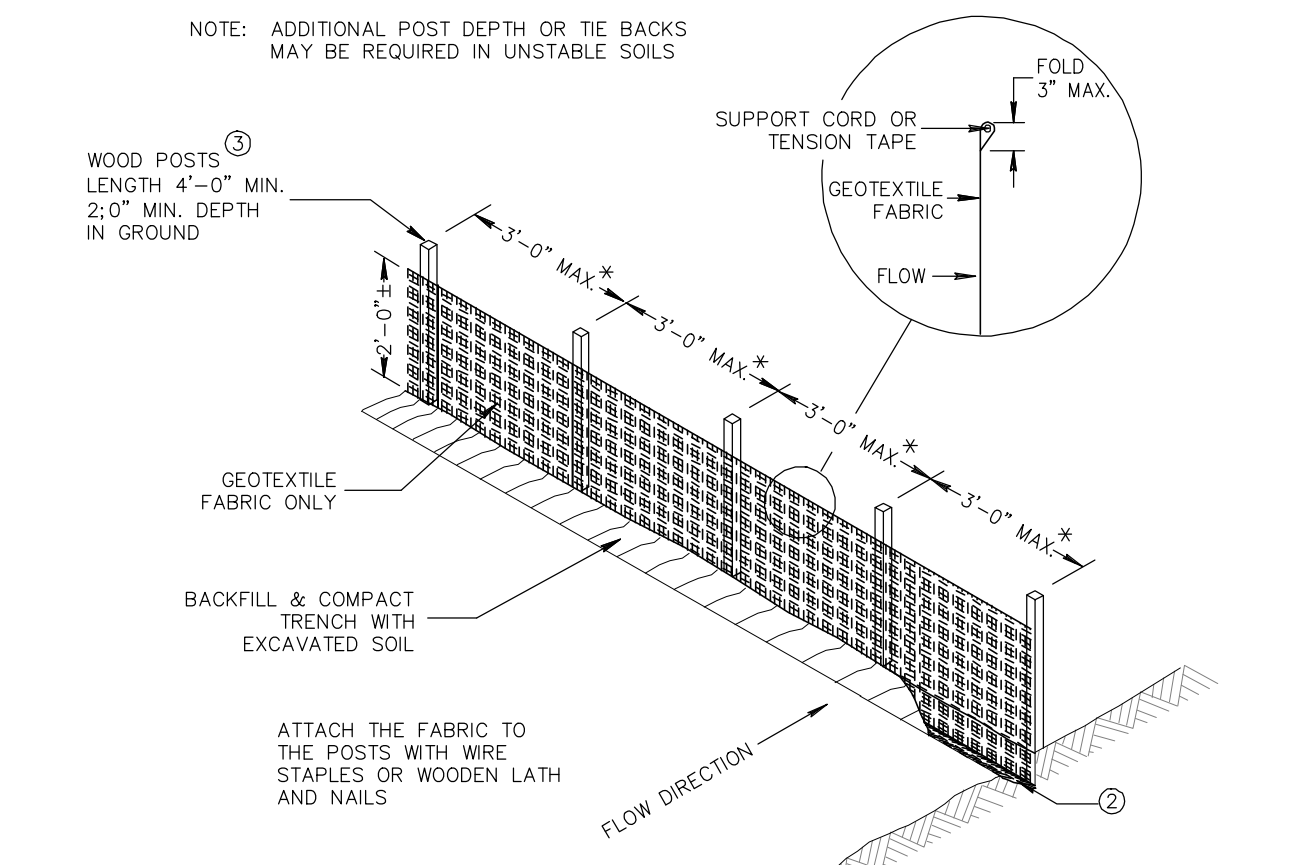

3
SILT FENCE DETAIL
(NOT TO SCALE)

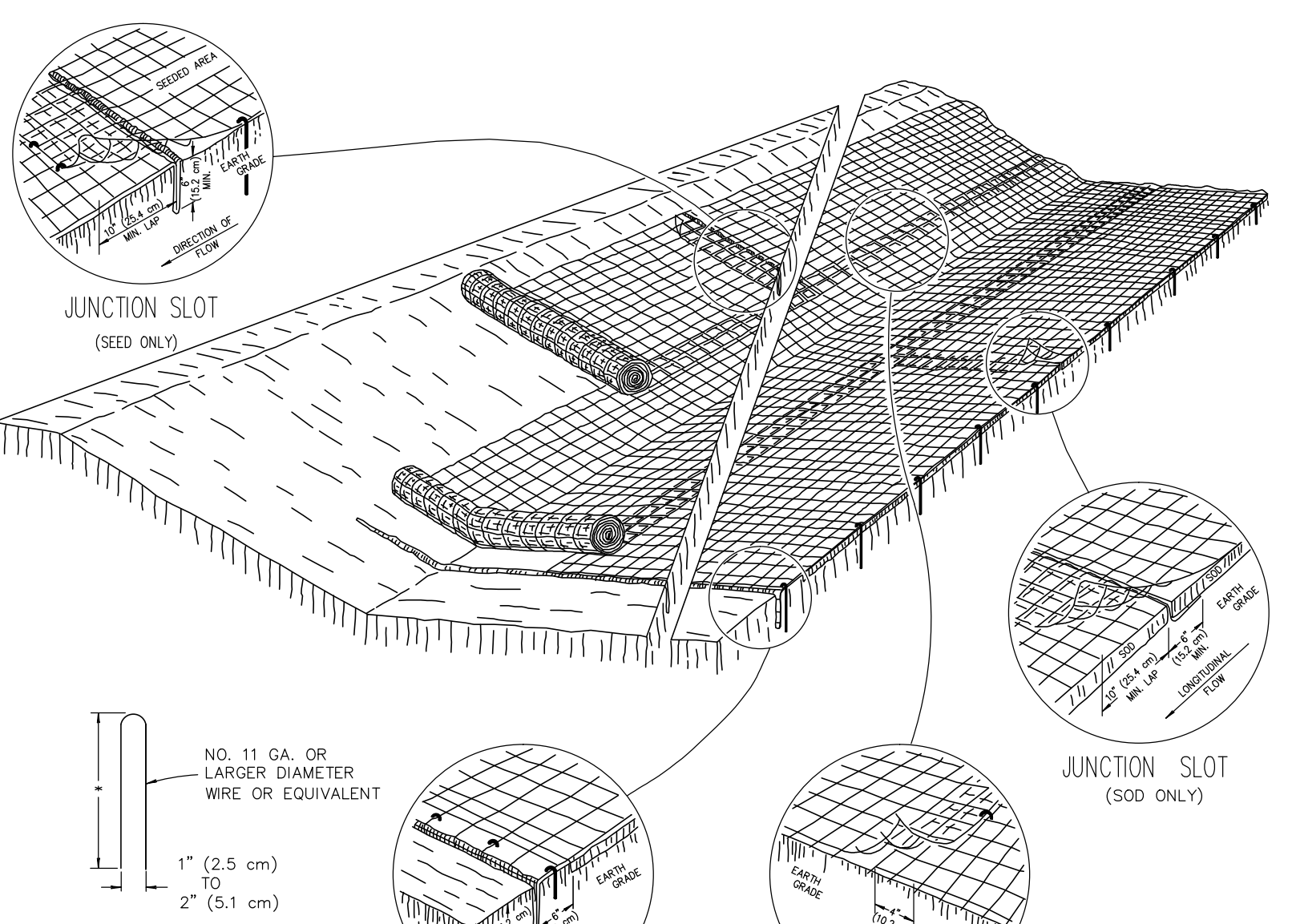

7
EROSION MAT DETAIL
(NOT TO SCALE)

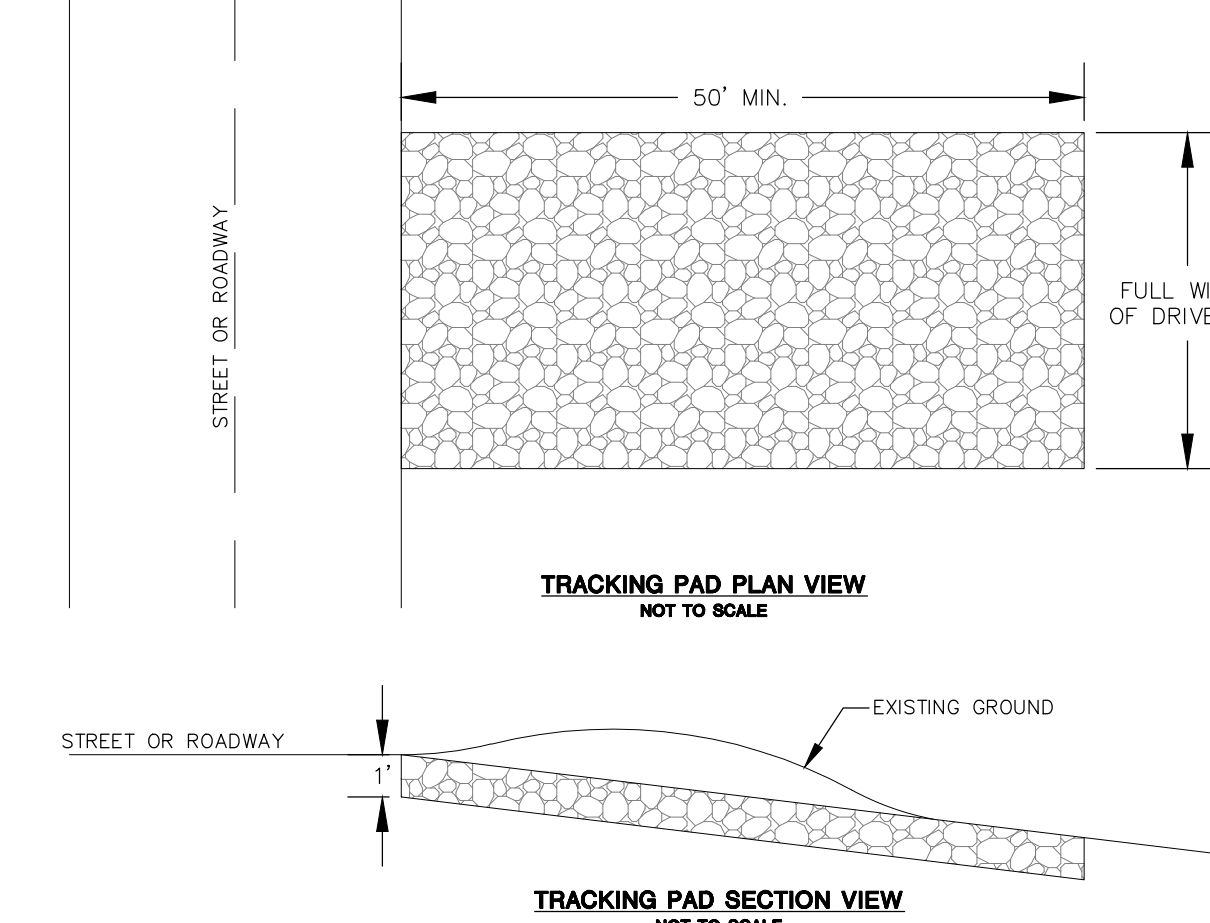

9
STONE TRACKING PAD DETAIL
NOT TO SCALE

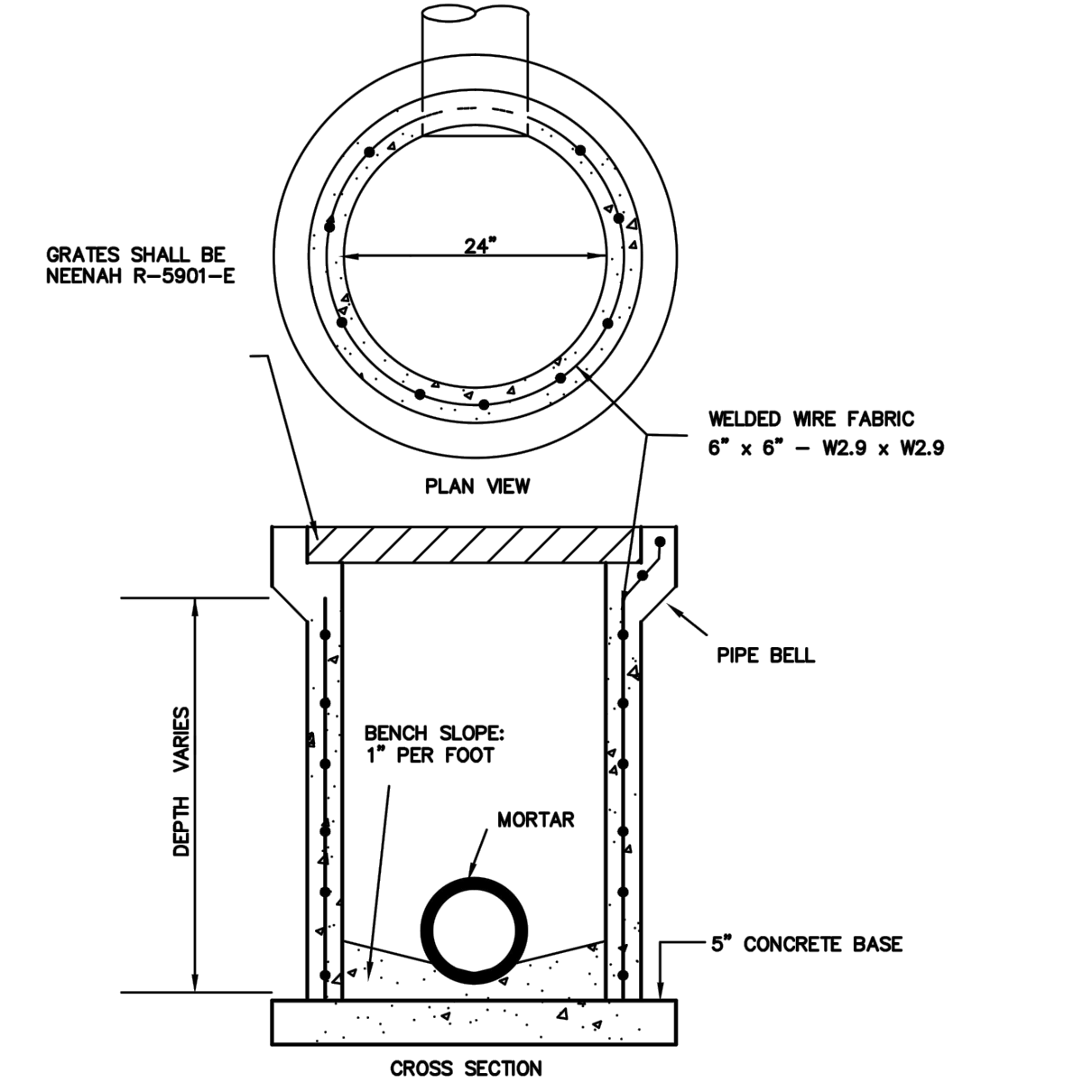

10
FIELD INLET DETAIL
NOT TO SCALE

GENERAL NOTES:

- DETAILS OF CONSTRUCTION NOT SHOWN ON THIS DRAWING SHALL CONFORM TO THE PERTINENT REQUIREMENTS OF THE STANDARD SPECIFICATIONS AND APPLICABLE SPECIAL PROVISIONS.
- HORIZONTAL BRACE REQUIRED WITH 2" x 4" WOODEN FRAME OR EQUIVALENT AT TOP OF POSTS.
- FOR MANUAL INSTALLATIONS THE TRENCH SHALL BE A MINIMUM OF 4" WIDE & 6" DEEP TO BURY AND ANCHOR THE GEOTEXTILE FABRIC. FOLD MATERIAL TO FIT TRENCH AND BACKFILL & COMPACT TRENCH WITH EXCAVATED SOIL.
- WOOD POSTS SHALL BE A MINIMUM SIZE OF 1 1/2" x 1 1/2" OF OAK OR HICKORY.
- SILT FENCE TO EXTEND ACROSS THE TOP OF THE PIPE.
- CONSTRUCT SILT FENCE FROM A CONTINUOUS ROLL IF POSSIBLE BY CUTTING LENGTHS TO AVOID JOINTS; IF A JOINT IS NECESSARY USE ONE OF THE FOLLOWING TWO METHODS: A) OVERLAP THE END POSTS AND TWIST OR ROTATE, AT LEAST 180 DEGREES; B) HOOK THE END OF EACH SILT FENCE LENGTH.
- PLACE JERSEY BARRIERS OR EQUIVALENT BEHIND (DOWNSLOPE SIDE) SILT FENCE AS NEEDED TO PROVIDE ADDITIONAL STABILITY.

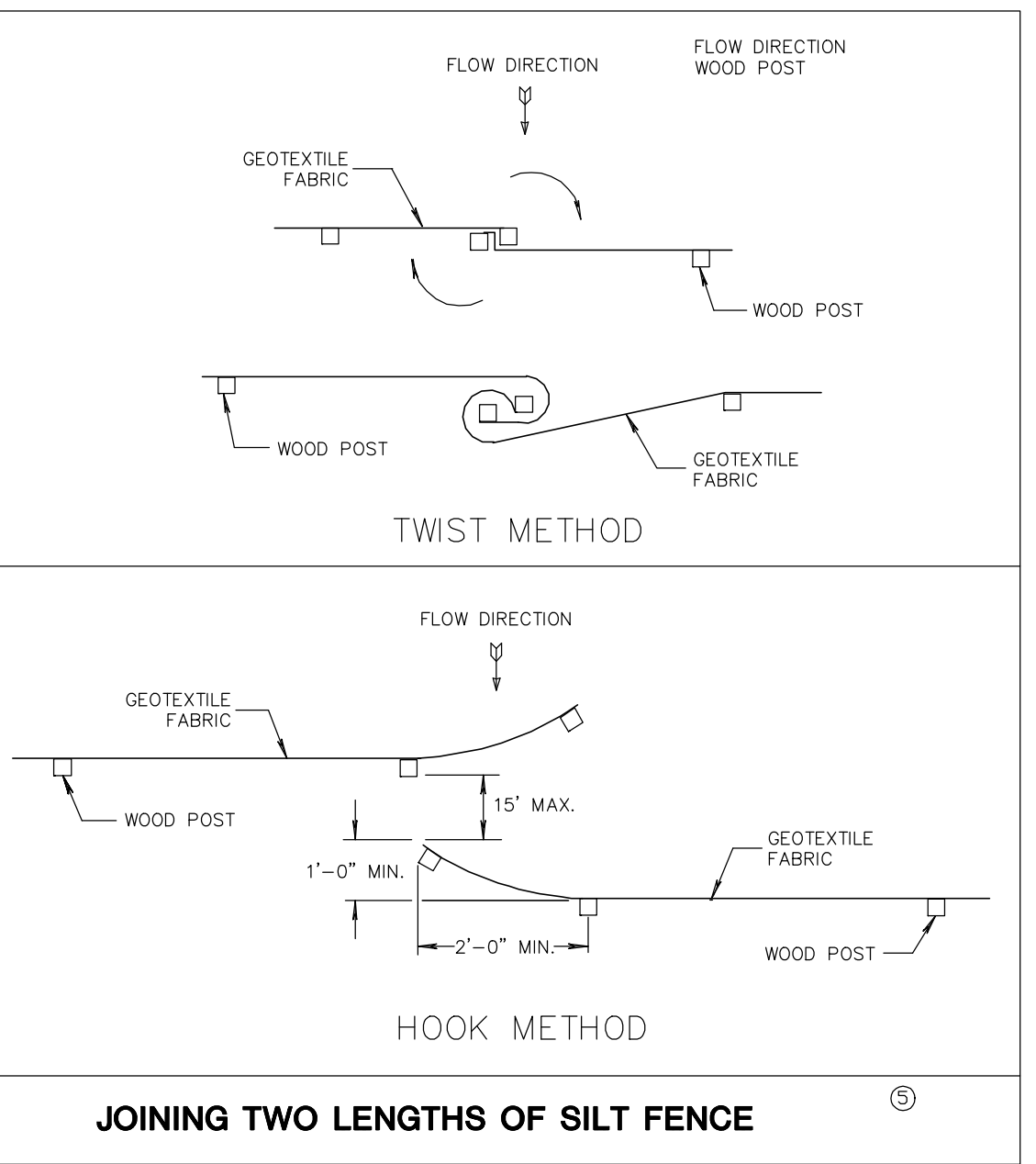

JOINING TWO LENGTHS OF SILT FENCE

EROSION MAT NOTES:

- DETAILS OF CONSTRUCTION, MATERIALS AND WORKMANSHIP NOT SHOWN ON THIS DRAWING SHALL CONFORM TO THE PERTINENT REQUIREMENTS OF THE SPECIFICATIONS
- VARIATIONS IN THE DIMENSIONS OR MATERIALS SHOWN HEREON SHALL BE PERTINENT IF THEY PROVIDE EQUIVALENT PROTECTION AND MATERIAL STRENGTH AND IF PRIOR APPROVAL OF THE ENGINEER IS OBTAINED.
- LAP JOINTS SHALL NOT BE PLACED IN THE BOTTOM OF V-SHAPED DITCHES.
- JUNCTION SLOTS ON ADJACENT STRIPS OF MATTING SHALL BE STAGGERED A MINIMUM OF 4 FEET (1.219 m) APART.
- EDGES OF THE EROSION MAT SHALL BE IMPRESSED IN THE SOIL.
- EROSION MAT WILL BE MEASURED AND PAID FOR IN ACCORDANCE WITH THE SPECIFICATION.
- EROSION MAT OVER SEEDING
- JUNCTION OR ANCHOR SLOTS SHALL BE AT MINIMUM INTERVALS OF 100 FEET (30.48 m) ON GRADES UP TO AND INCLUDING 3 PERCENT, AND 50 FEET (15.24 m) ON GRADES EXCEEDING 3 PERCENT.

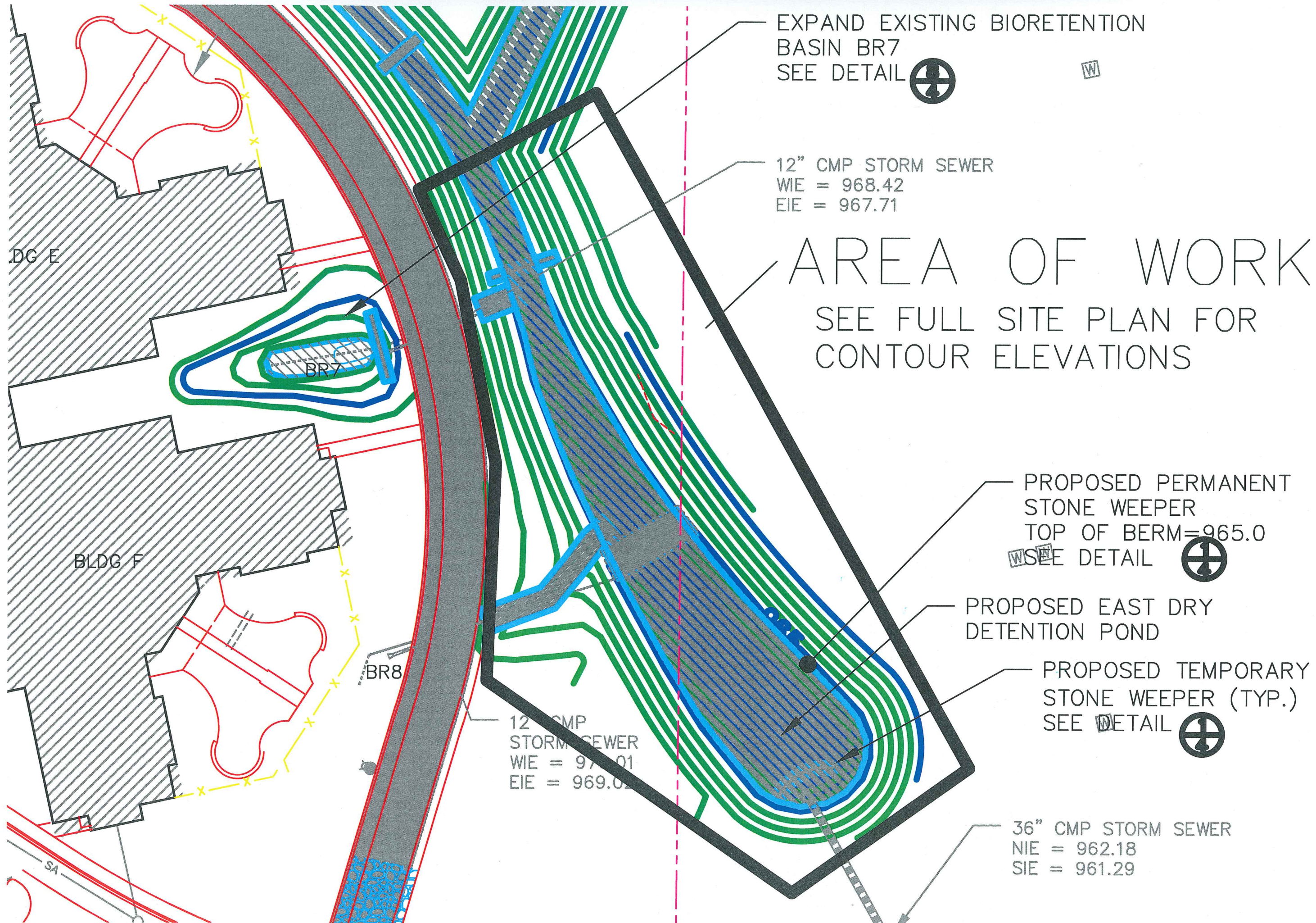

EXPAND EXISTING BIORETENTION
BASIN BR7
SEE DETAIL 

12" CMP STORM SEWER
WE = 968.42
EIE = 967.71

AREA OF WORK

SEE FULL SITE PLAN FOR
CONTOUR ELEVATIONS

PROPOSED PERMANENT
STONE WEEPER
TOP OF BERM=965.0
WSEE DETAIL 

PROPOSED EAST DRY
DETENTION POND

PROPOSED TEMPORARY
STONE WEEPER (TYP.)
SEE DETAIL 

12" CMP
STORM SEWER
WE = 971.01
EIE = 969.02

36" CMP STORM SEWER
NIE = 962.18
SIE = 961.29

BLDG E

BLDG F

BR8

BR7

SA