

CHEROKEE MARSH

MILL CREEK

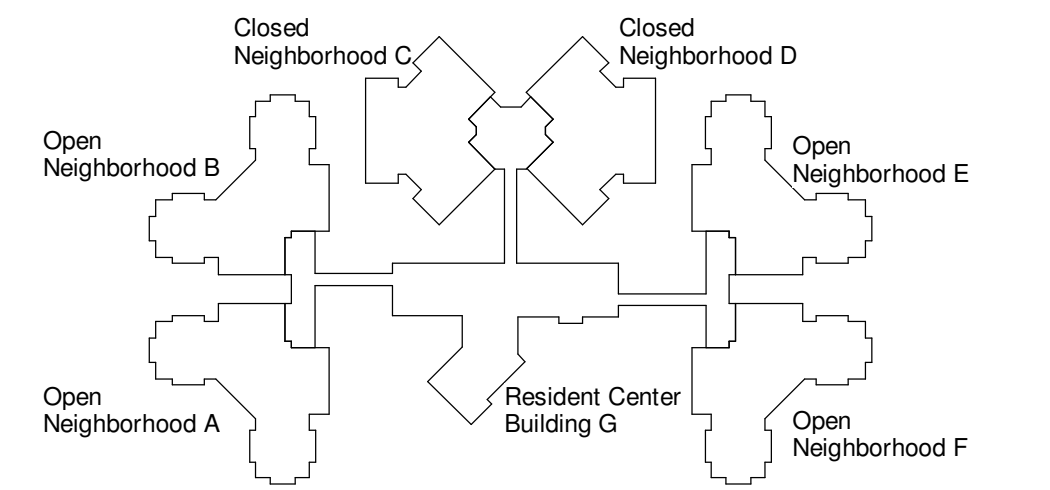

KEYPLAN

① Area A
1/8" = 1'-0"



Planning
Architecture
Engineering
Interior Design
Construction Management
Design Build

505 East Grant Street, Minneapolis, MN 55404-1490
T 612.332.4422 F 612.344.1282 hortyelving.com

Horty Elving & Associates, Inc.

New Badger Prairie Health Care Center
Dane County
Verona, Wisconsin

Drawn By AL

Checked By DJ

This drawing is the copyrighted work product of Architect and reuse, modification or reproduction of these documents without express written consent of Architect is prohibited. The architectural or related services performed or furnished by the Architect for this project are provided subject to the care and skill ordinarily exercised by members of the architectural profession practicing under similar circumstances at the same time and in the same locality. Architect makes no warranties, express or implied, in connection with its services.

DANE COUNTY BID NUMBER 108018

SIGNAGE MAIN LEVEL AREA A

Scale 1/8" = 1'-0" Issue Date 6/23/10

SN-1

HEA Project Number D61010

SUGAR RIVER

LAKE WINGRA

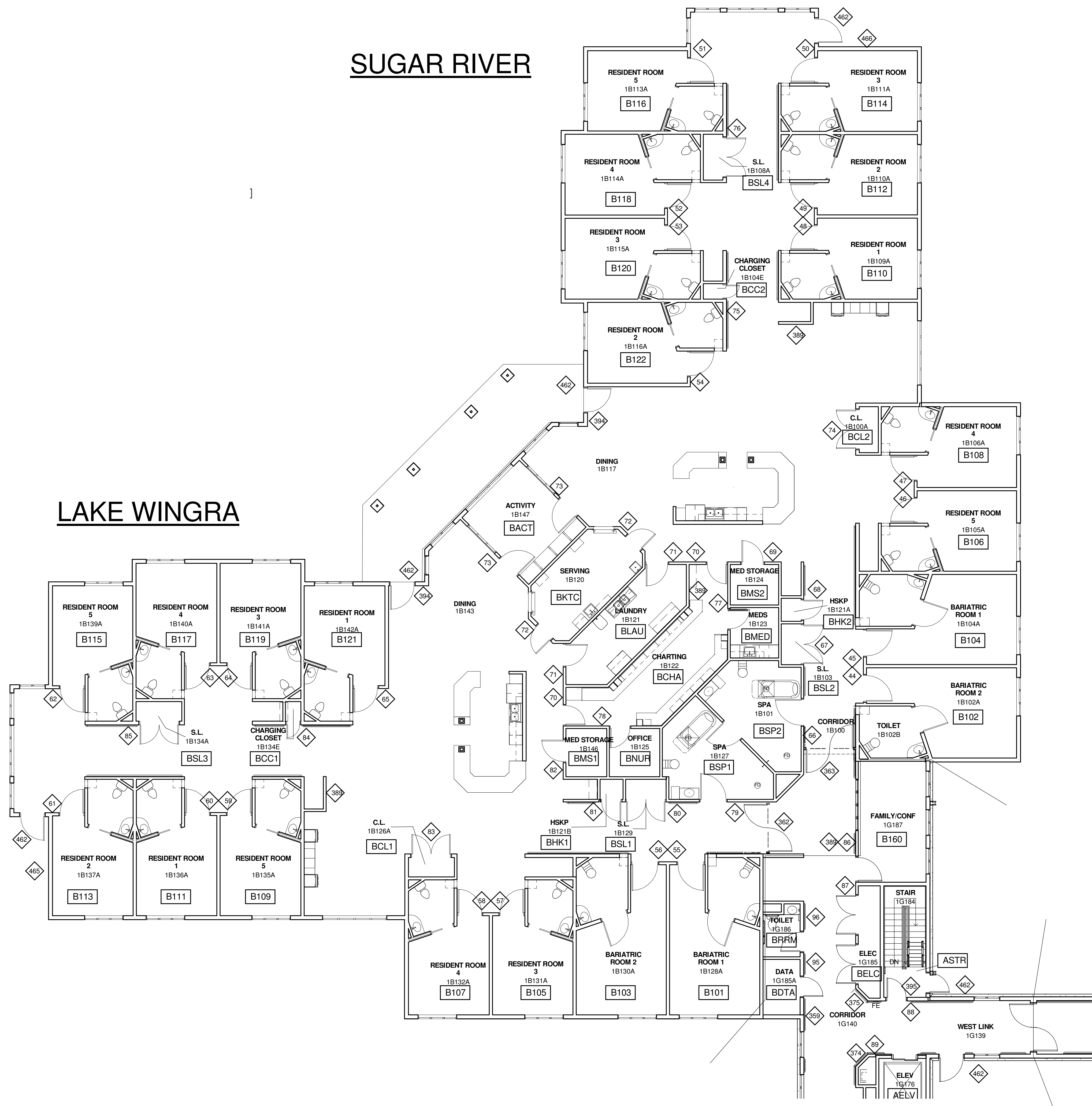

1 Area B
1/8" = 1'-0"

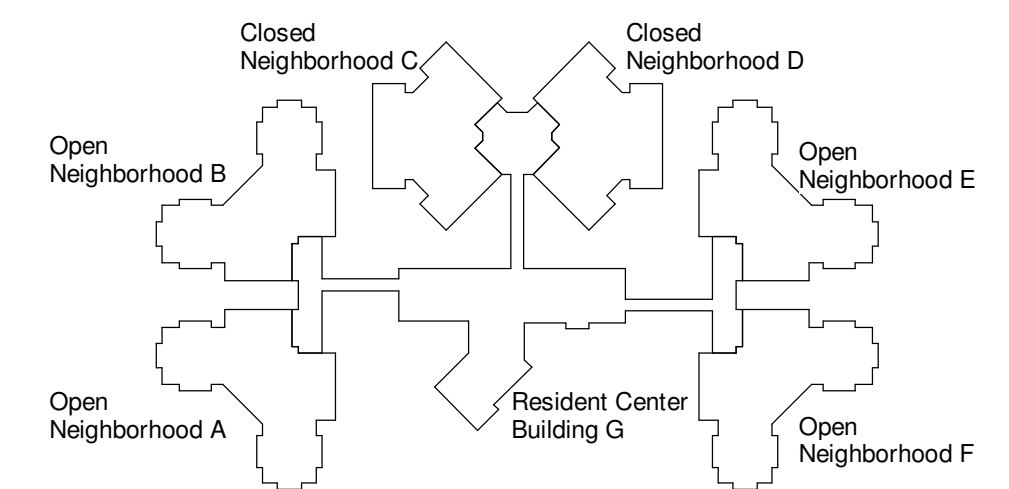

KEYPLAN



Planning
Architecture
Engineering
Interior Design
Construction Management
Design Build
Horty Elving & Associates, Inc.

505 East Grant Street, Minneapolis, MN 55404-1490
T 612.332.4422 F 612.344.1282 hortyelving.com

New Badger Prairie Health Care Center
Dane County
Verona, Wisconsin

Drawn By: AL Checked By: DJ

This drawing is the copyrighted work product of Architect and reuse, modification or reproduction of these documents without express written consent of Architect is prohibited. The architectural or related services performed or furnished by the Architect for this project are provided subject to the care and skill ordinarily exercised by members of the architectural profession practicing under similar circumstances at the same time and in the same locality. Architect makes no warranties, express or implied, in connection with its services.

DANE COUNTY BID NUMBER: 108018

SIGNAGE MAIN LEVEL AREA B
Scale: 1/8" = 1'-0" Issue Date: 6/23/10

SN-2
HEA Project Number: D61010

PICNIC POINT

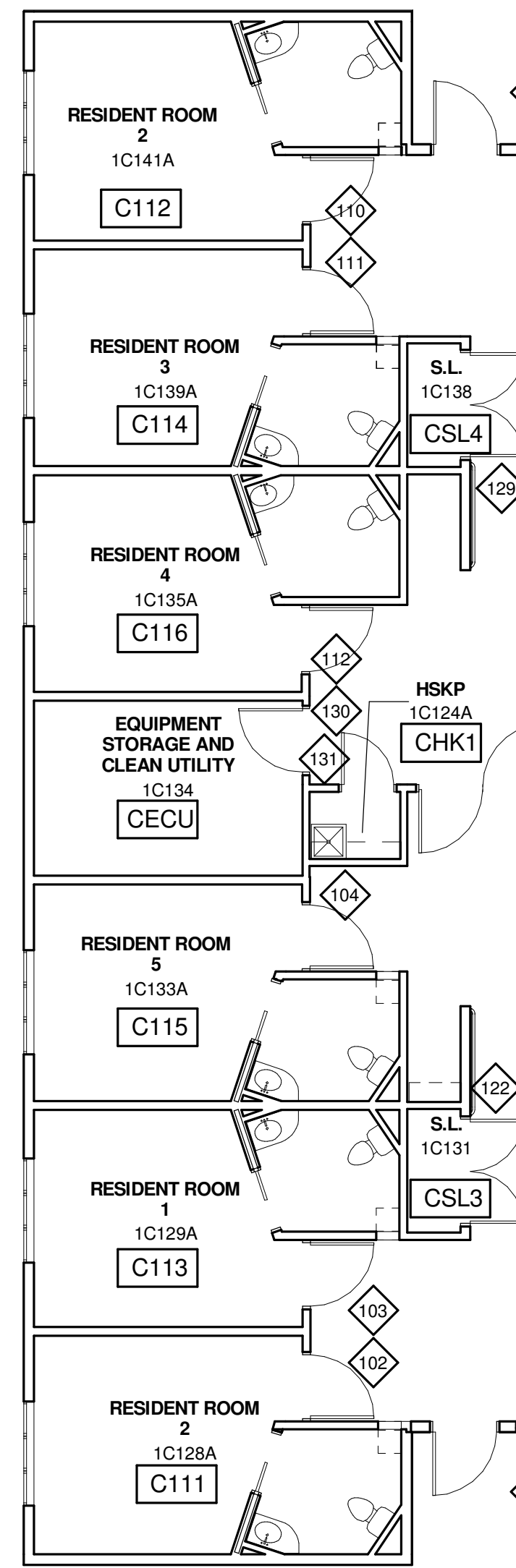

VILAS

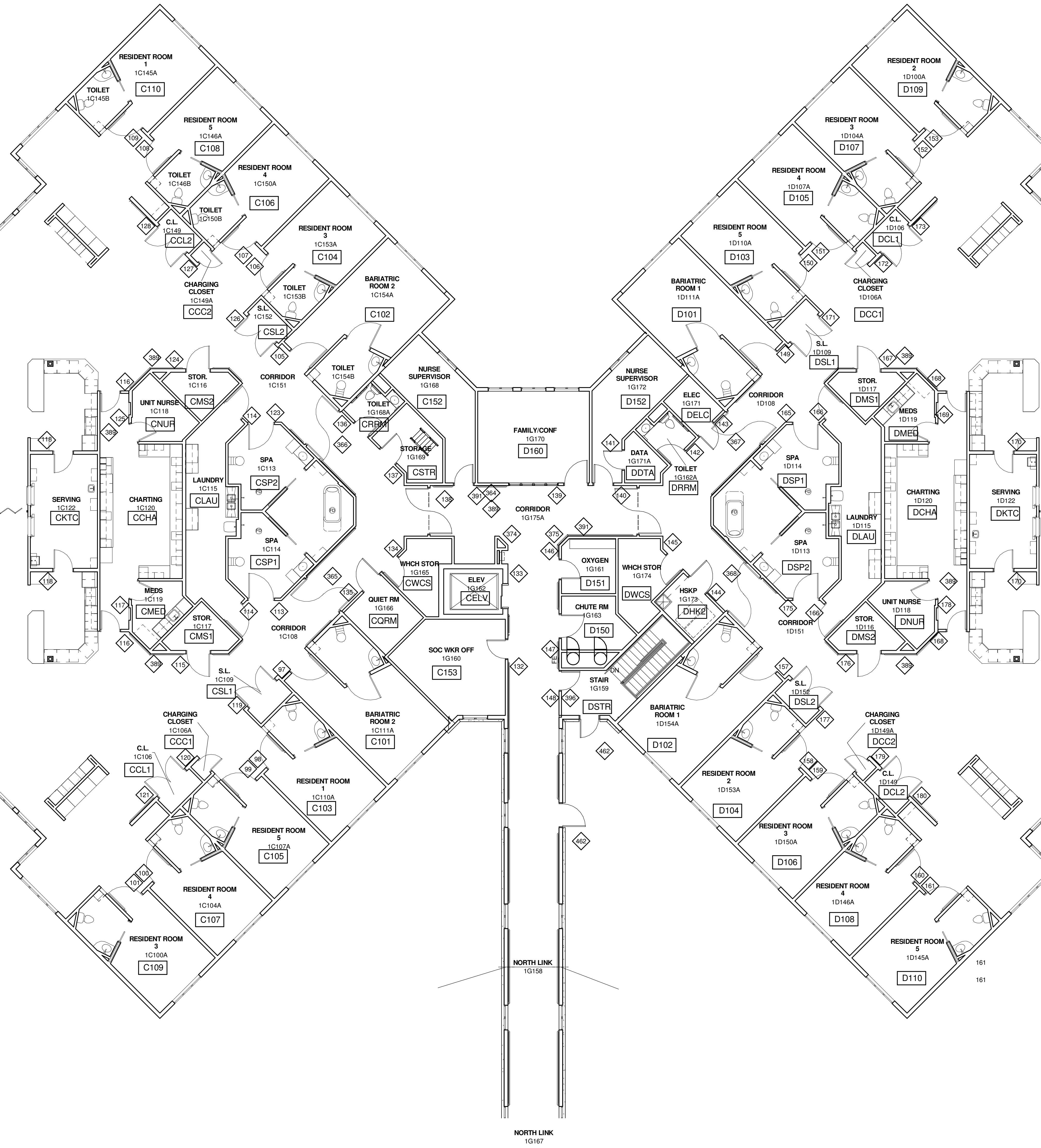

ARBORETUM

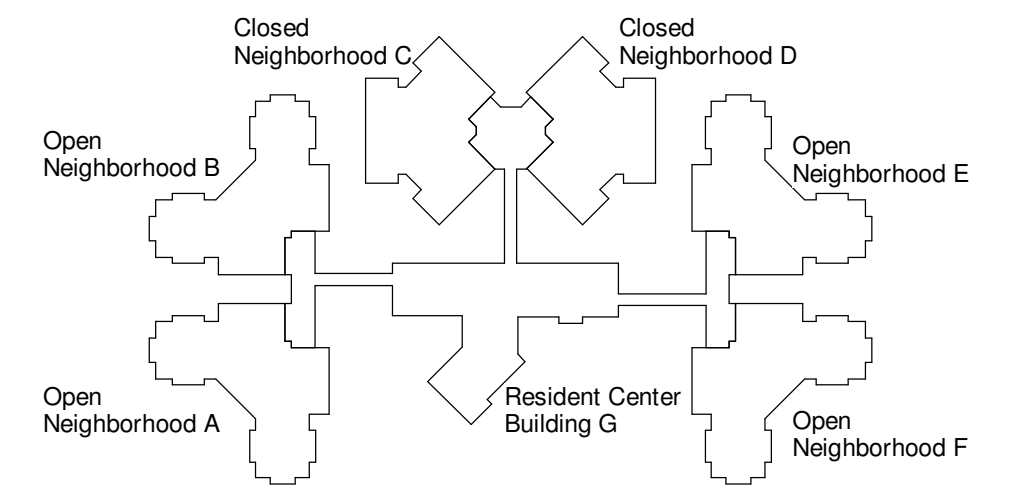
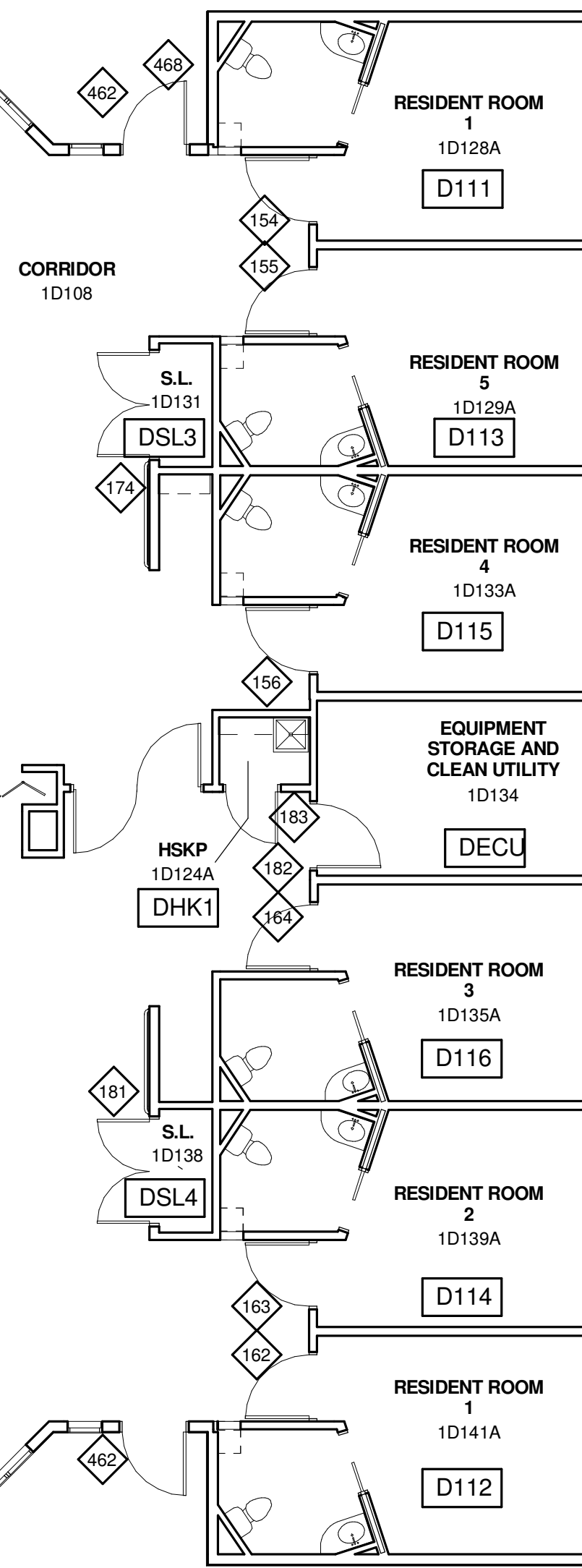

KEYPLAN

1 Areas C&D
1/8" = 1'-0"

WALKING IRON

BRIGHAM

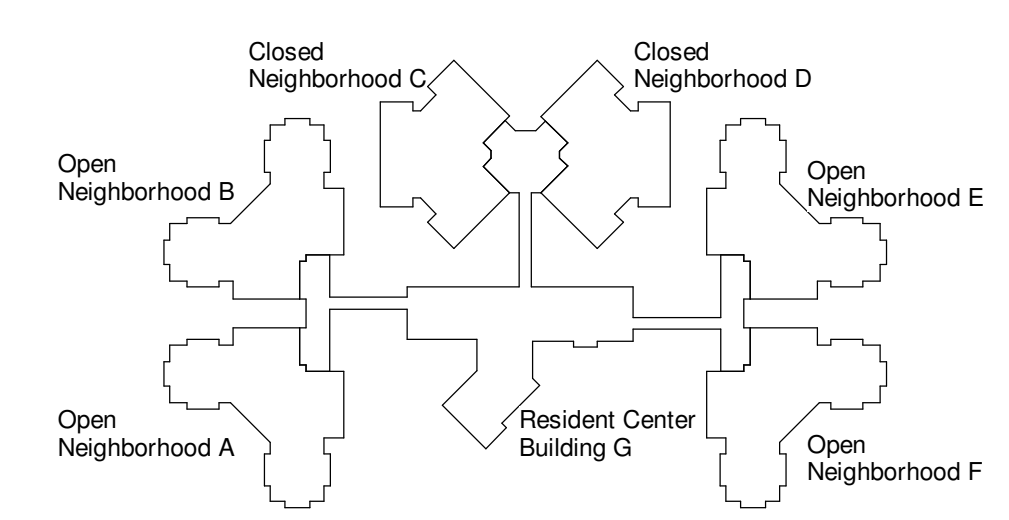
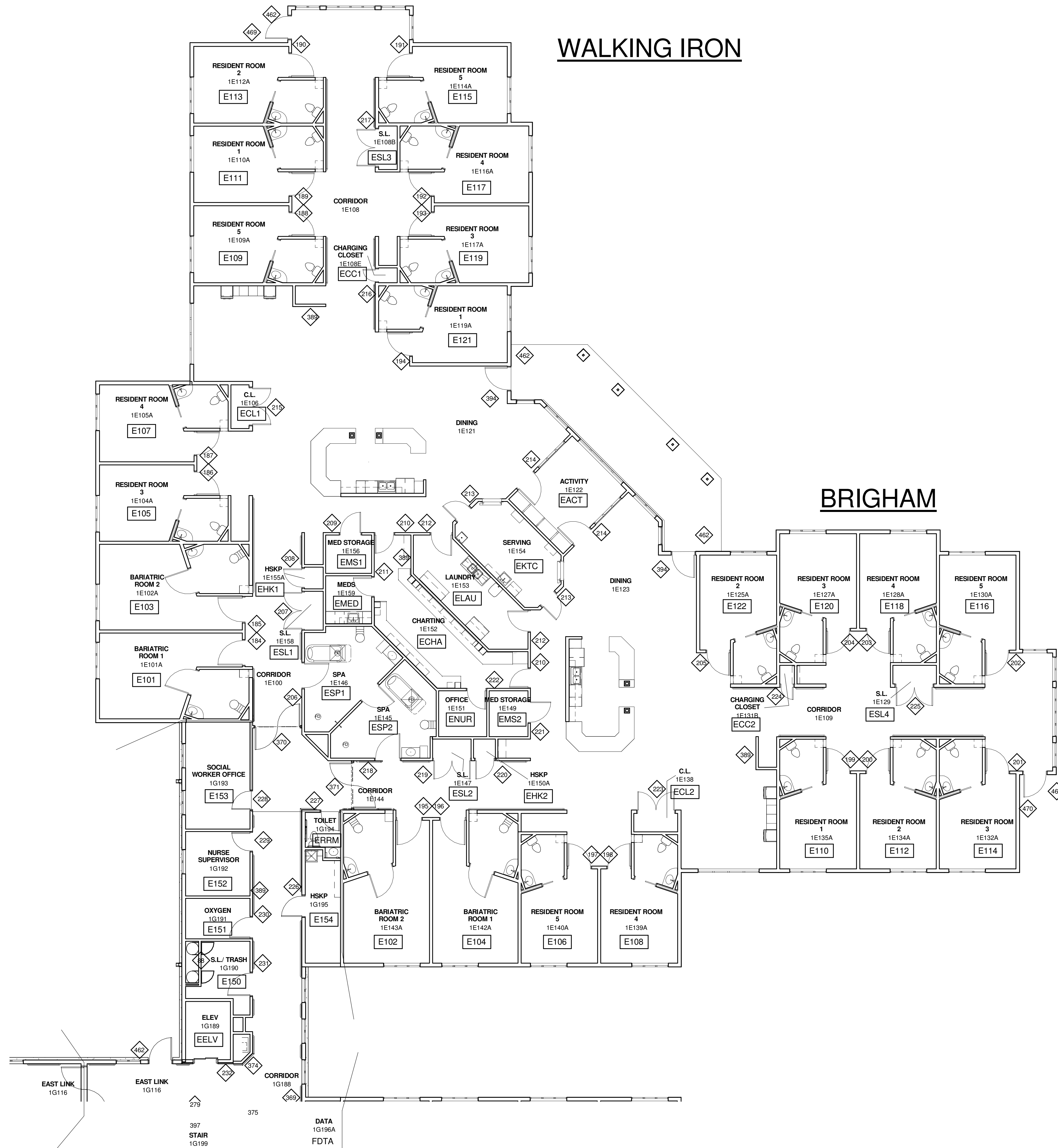

KEYPLAN

1 Area E
1/8" = 1'-0"

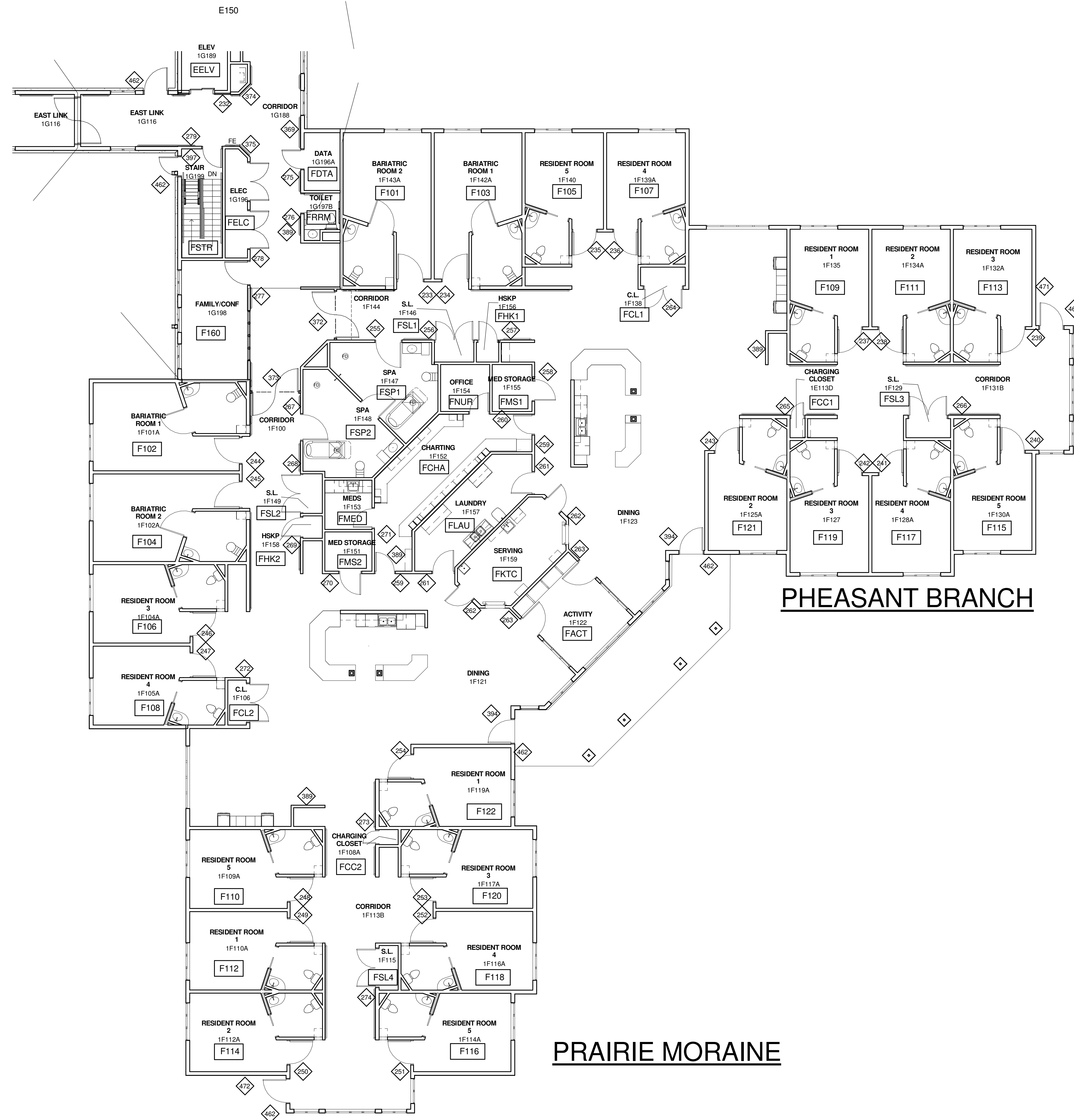

1 Area F
1/8" = 1'-0"

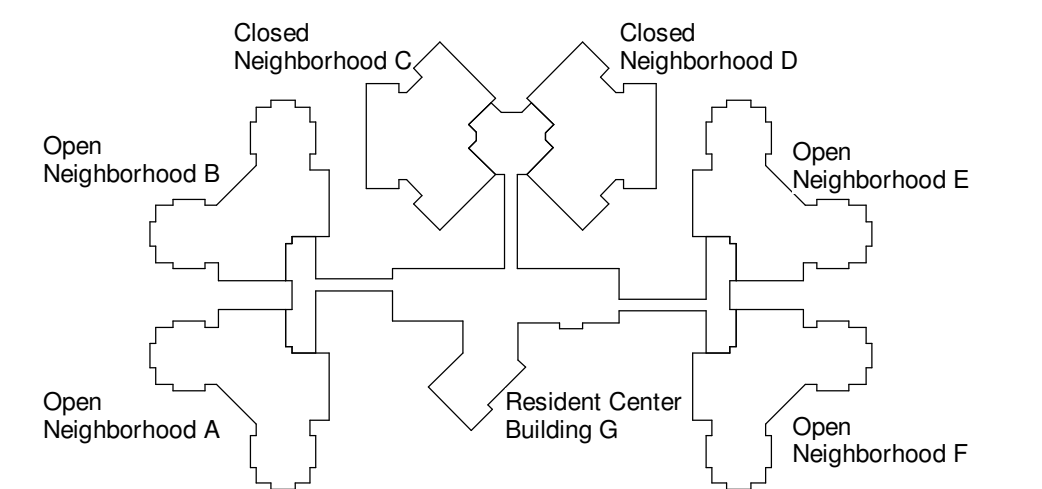

KEYPLAN

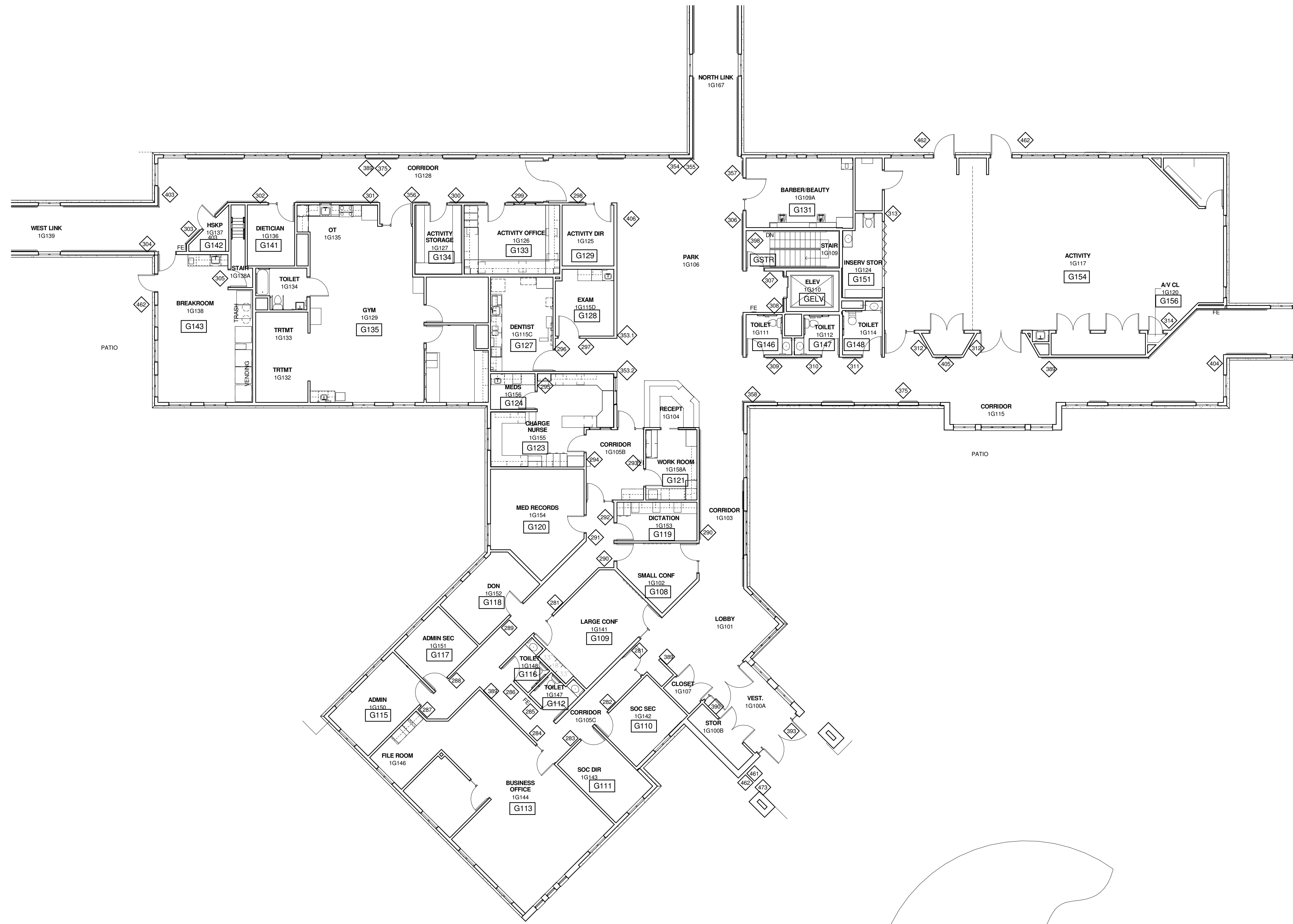

1 Area G
1/8" = 1'-0"

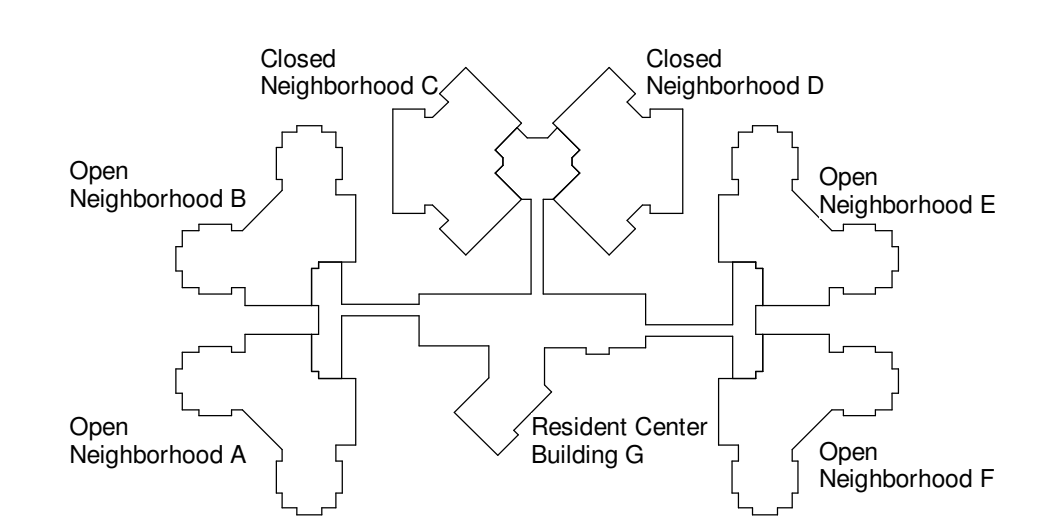

KEYPLAN



Planning
Architecture
Engineering
Interior Design
Construction Management
Design Build
Horty Elving & Associates, Inc.

New Badger Prairie Health Care Center
Dane County
Verona, Wisconsin

Drawn By AL Checked By DJ

This drawing is the copyrighted work product of Architect and reuse, modification or reproduction of these documents without express written consent of Architect is prohibited. The architectural or related services performed or furnished by the Architect for this project are provided subject to the care and skill ordinarily exercised by members of the architectural profession practicing under similar circumstances at the same time and in the same locality. Architect makes no warranties, express or implied, in connection with its services.

505 East Grant Street, Minneapolis, MN 55404-1490
T 612.332.4422 F 612.344.1282 hortyelving.com

DANE COUNTY BID NUMBER 108018

SIGNAGE MAIN LEVEL AREA G

Scale 1/8" = 1'-0" Issue Date 6/23/10

HEA Project Number D61010

SN-6

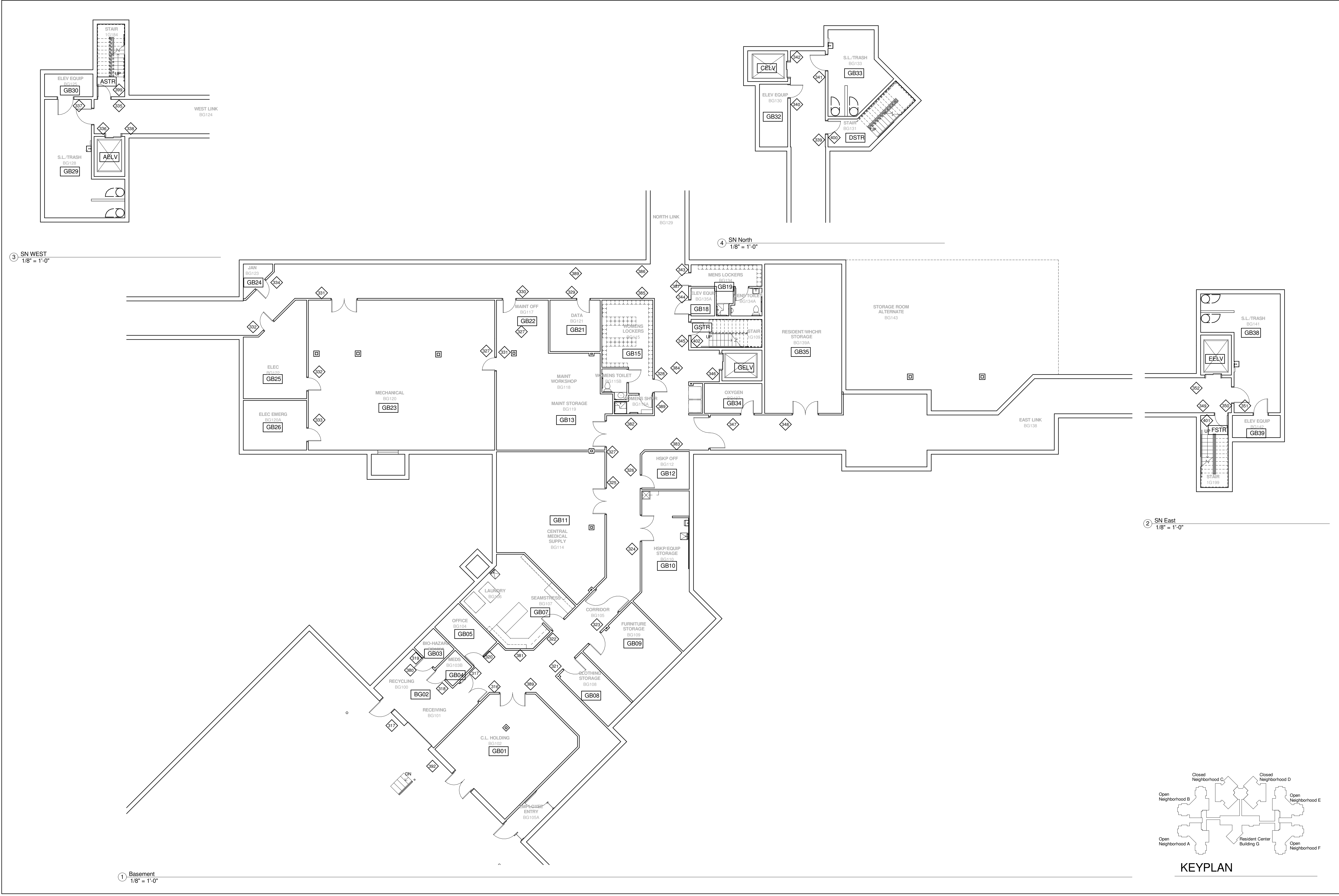

2 SN East
1/8" = 1'-0"

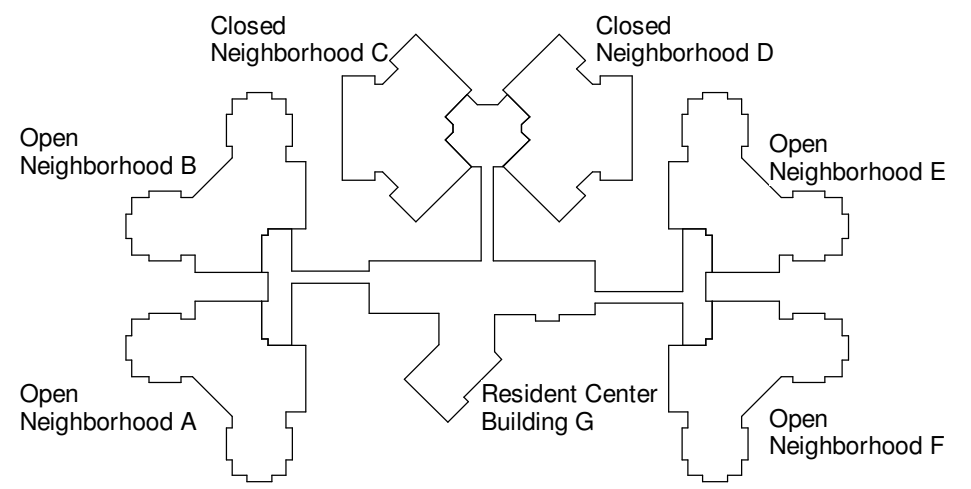

KEYPLAN

1 Basement
1/8" = 1'-0"

Horty Elving
505 East Grant Street, Minneapolis, MN 55404-1490
T 612.332.4422 F 612.344.1282 hortyelving.com

Planning
Architecture
Engineering
Interior Design
Construction Management
Design Build
Horty Elving & Associates, Inc.

New Badger Prairie Health Care Center
Dane County
Verona, Wisconsin

Drawn By AL Checked By DJ

This drawing is the copyrighted work product of Architect and reuse, modification or reproduction of these documents without express written consent of Architect is prohibited. The architectural or related services performed or furnished by the Architect for this project are provided subject to the care and skill ordinarily exercised by members of the architectural profession practicing under similar circumstances at the same time and in the same locality. Architect makes no warranties, express or implied, in connection with its service.

DANE COUNTY BID NUMBER 108018

SIGNAGE BASEMENT
Scale 1/8" = 1'-0" Issue Date 6/23/10

SN-7
HEA Project Number D61010



A101

A ROOM ID
2"h x 3"w

AMS1
MEDICAL SUPPLIES

B ROOM ID W/NAME
3"h x 8"w

AMS1
FAMILY CONFERENCE
IN USE VACANT

C ROOM ID W/SLIDER
4"h x 8"w

G109
CONFERENCE ROOM A

D ROOM ID- AGENDA HOLDER
1'-3"h x 9"w



E ELEVATOR
8"h x 6"w



F RESTROOM
10"h x 8"w



G STAIRS
9"h x 8"w



I FLAG SIGN

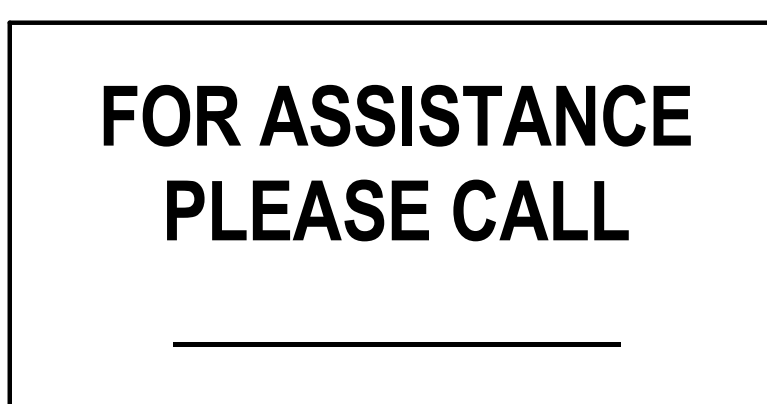

K INFO SIGN
4"h x 8"w



L INFO WITH PICTOGRAM
8.5 "h x 8"w



N STAIR INTERIOR SIGN
8"h x 8"w

BACKER COLORS
BLUE- ASTR
GREEN- DSTR
GOLD- FSTR
No Backer- GSTR



O DIRECTIONAL
3"h x 10"w

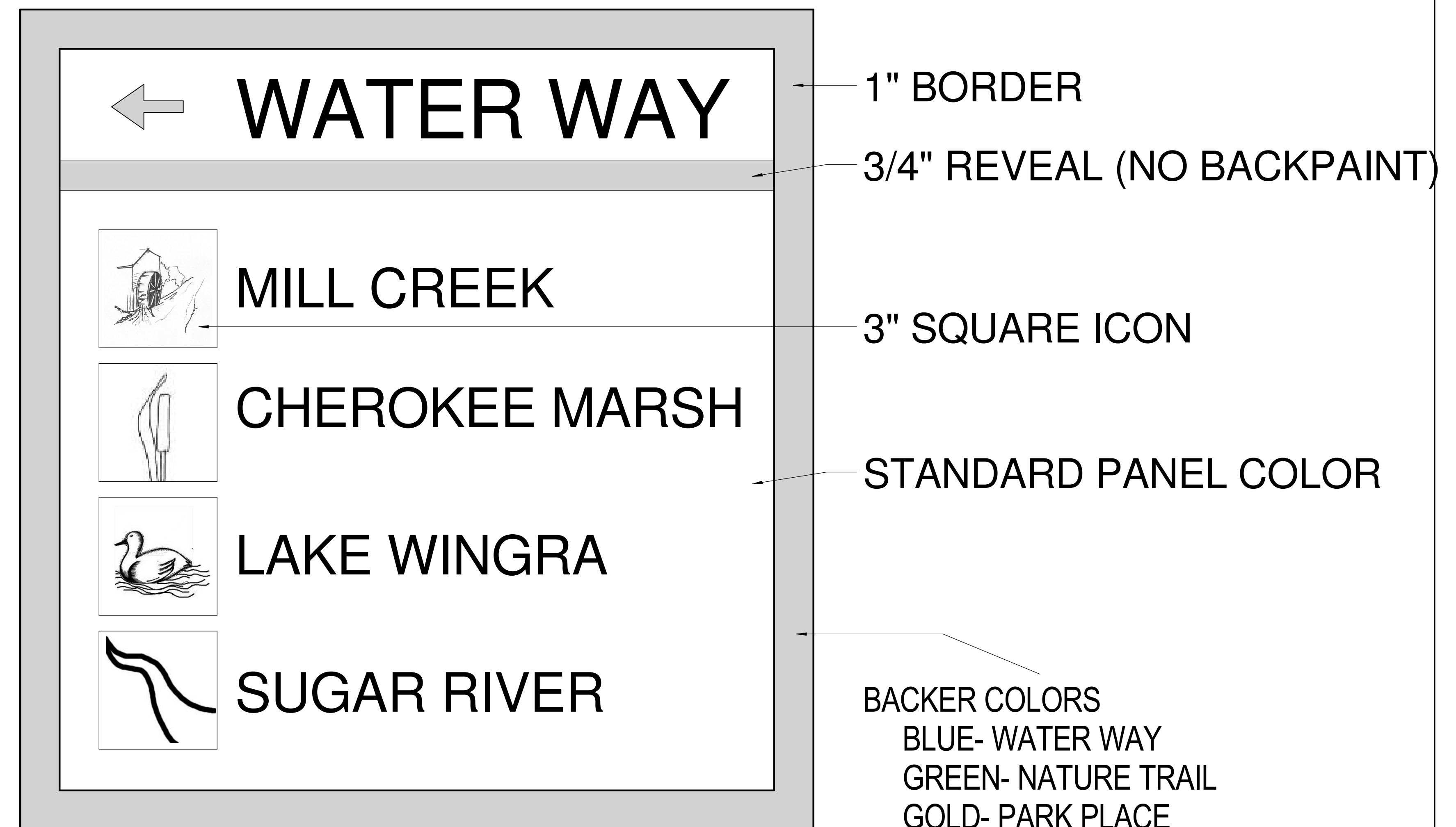

H H-1 DIRECTIONAL
VERIFY SIGN SIZE REQUIRED BY TEXT.

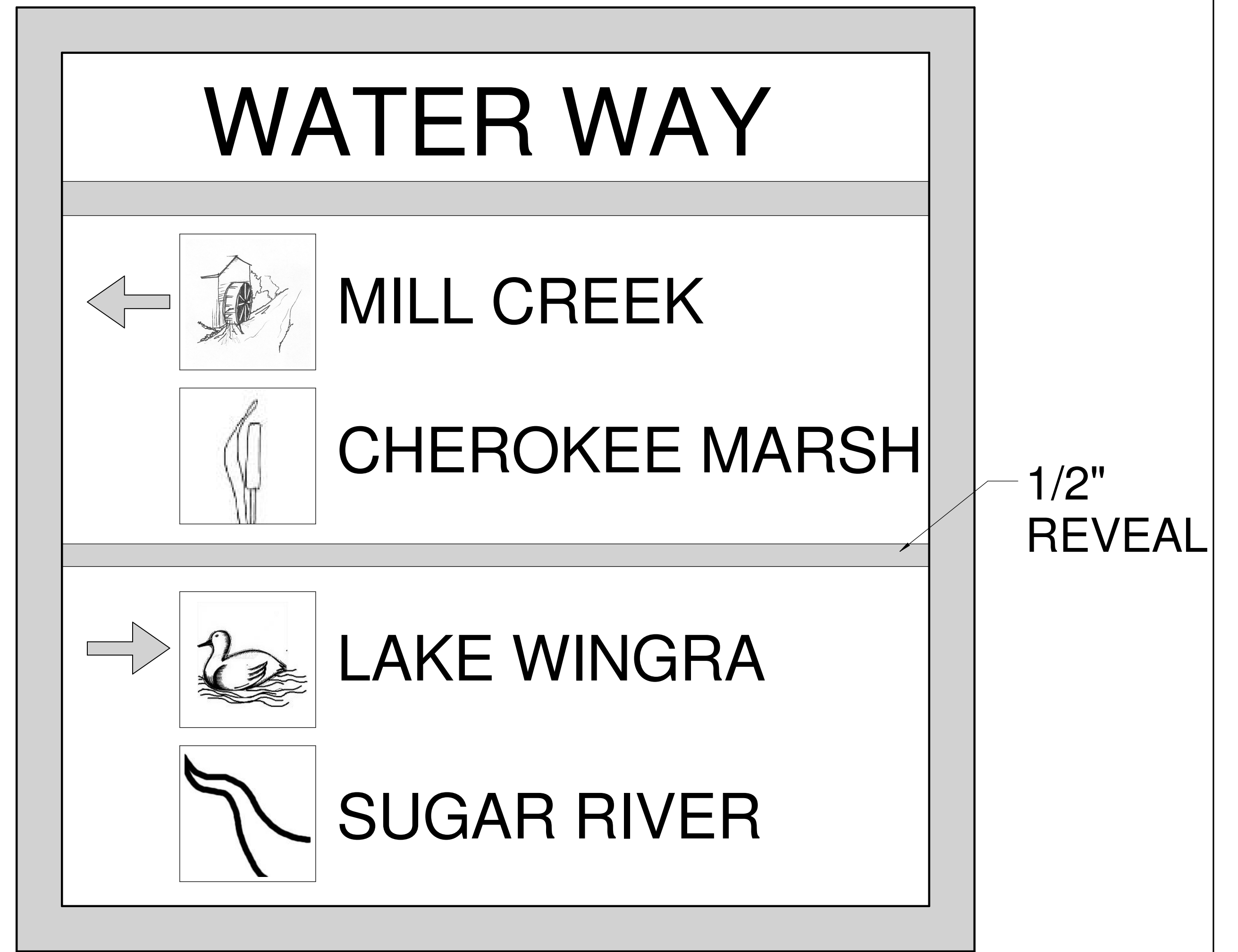

H H-2 DIRECTIONAL
VERIFY SIGN SIZE REQUIRED BY TEXT.

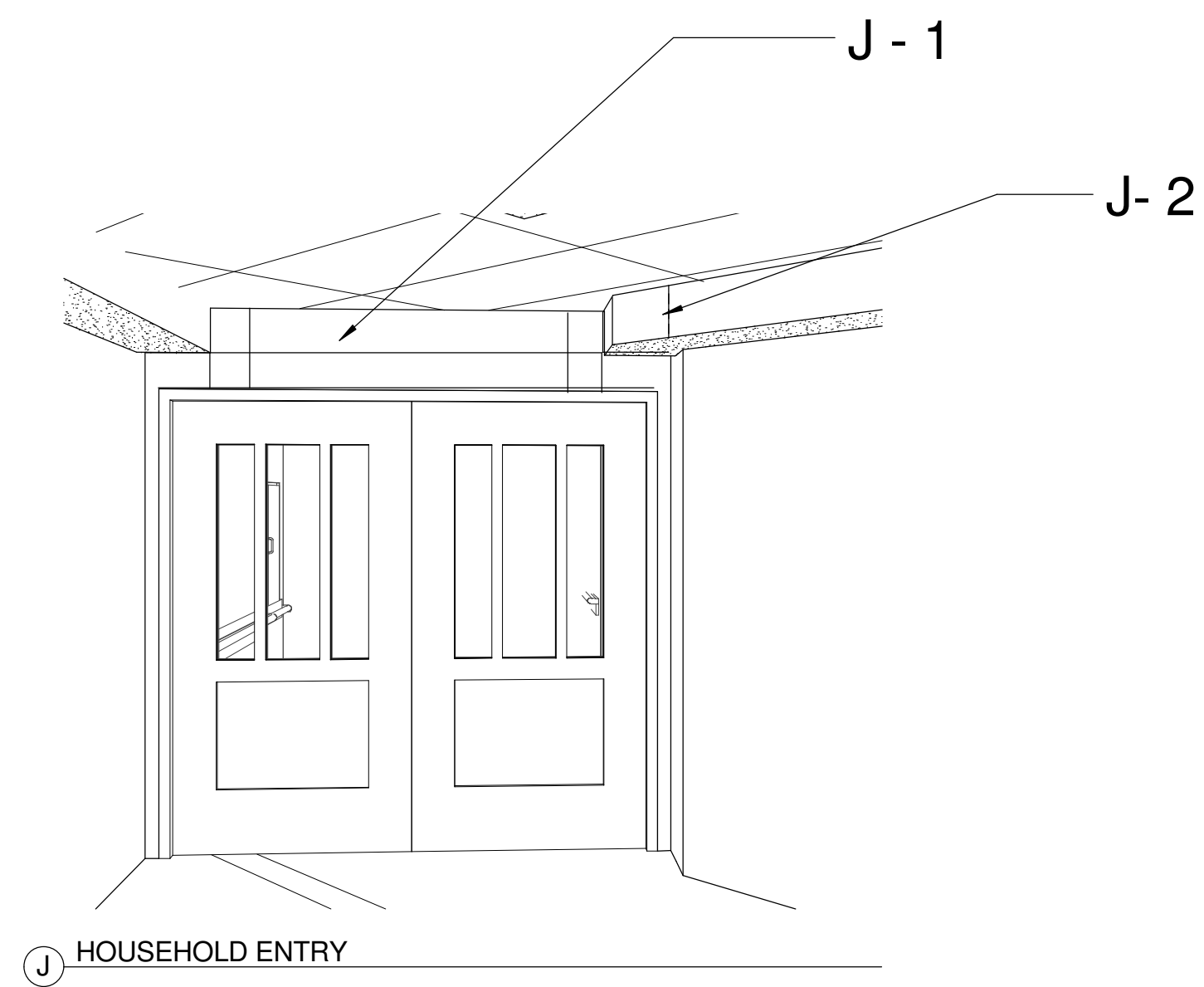

S HISTORY WALL

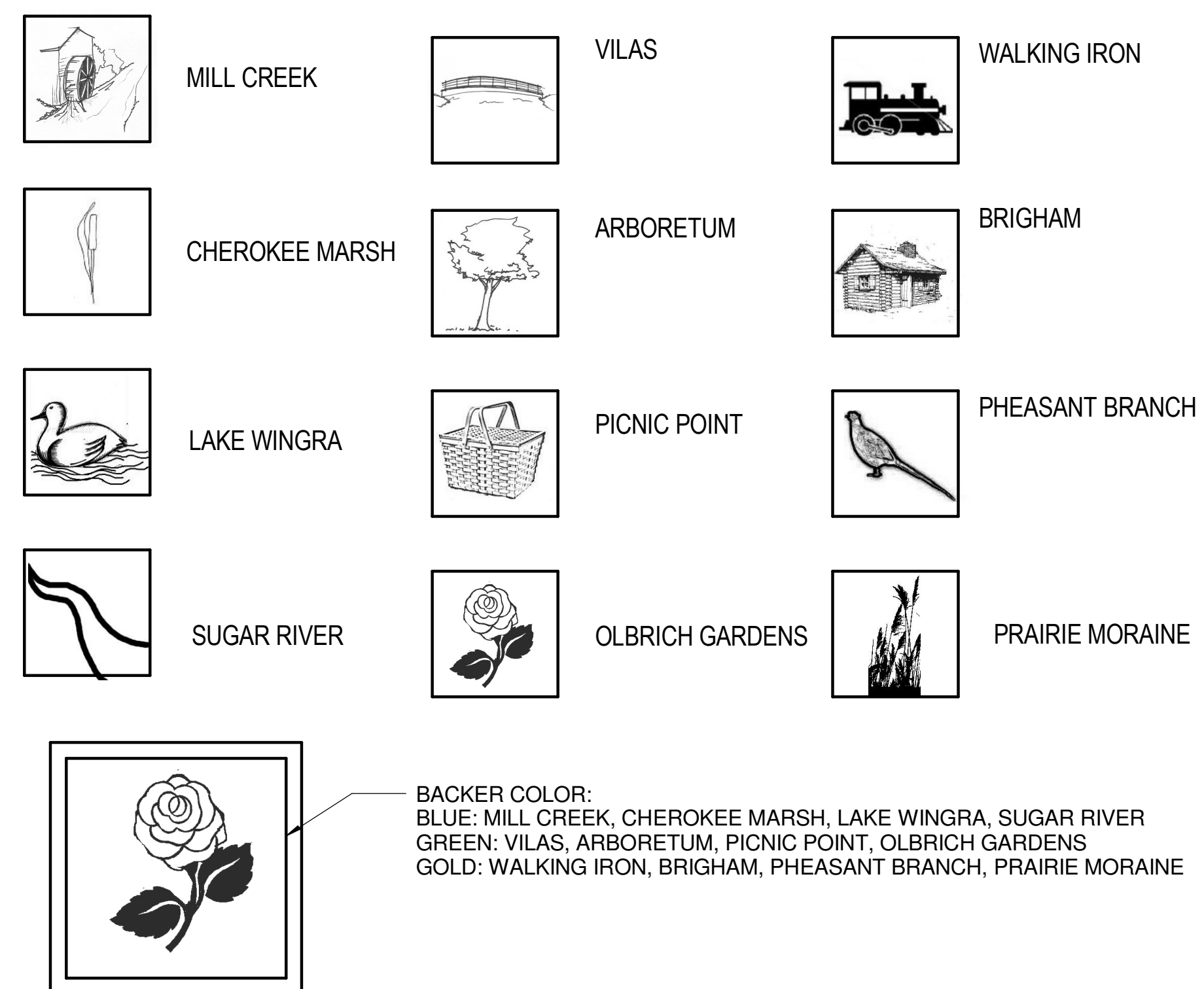

GRAPHICS FOR SIGN TYPE J- 2 AND SIGN TYPE H- TO BE FURTHER DEVELOPED BY SIGNAGE PROVIDER.

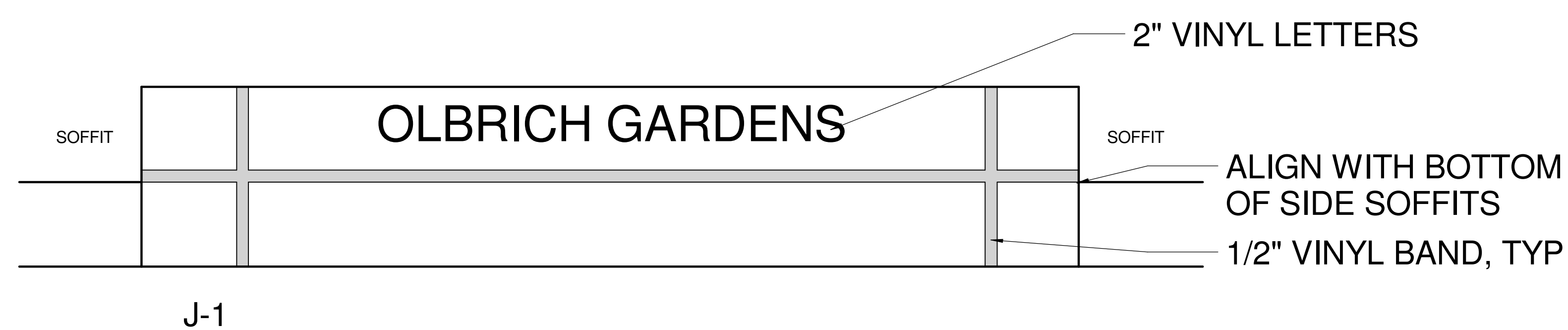
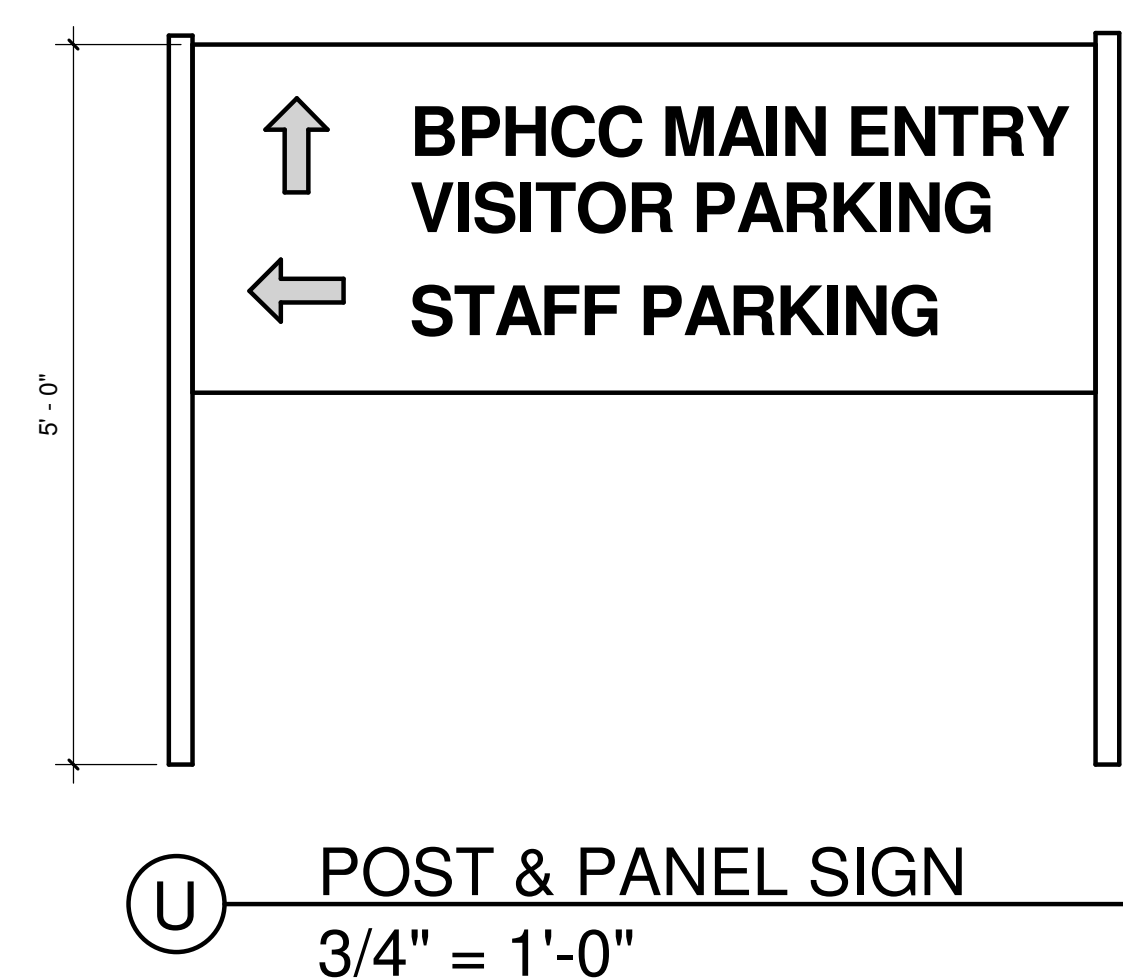

J DECORATIVE NEIGHBORHOOD ID- ABOVE ENTRY DOOR

