



March 28, 2016

**ATTENTION ALL REQUEST FOR BID (RFB) HOLDERS**

**RFB NO. 315047 - ADDENDUM NO. 1**

**HENRY VILAS ZOO – PLAYGROUND RESURFACING**

---

**BIDS DUE:** THURSDAY, APRIL 7, 2016, 2:00 PM. DUE DATE AND TIME ARE **NOT** CHANGED BY THIS ADDENDUM.

---

This Addendum is issued to modify, explain or clarify the original Request for Bid, (RFB) and is hereby made a part of the RFB. Please attach this Addendum to the RFB..

**PLEASE MAKE THE FOLLOWING CHANGES:**

**1. Bid Form - Replace**

Page BF-1 to BF-4 Replace previous BiD Form with the attached Bid Form (BF-1 - BF-4).

Explanation: Alternate was added for Deletion of Concrete Sidewalk Extension.

**2. Sheet ST 2 - Modify**

Modify current Sheet ST 2 as shown on Drawing ST 2, issued with this Addendum.

Storm structure location and type has changed extending the pipe length. Pavement area to be sawcut and concrete added around the storm structure casting following installation. Additional areas of concrete landscaping edging to be removed and replaced are noted.

If any additional information about this Addendum is needed, please call Eric Urtes, AIA at 608/266-4798, [urtes.eric@countyofdane.com](mailto:urtes.eric@countyofdane.com).

Sincerely,

*Eric Urtes*

Project Manager

Enclosures:

Bid Form

Drawing: Sheet ST-2 Site Plan and Utilities

S:\PubWork\Shared\ENGINEERING DIVISION\Scott Carlson\316004 - Army Reserve Bldg Demo\03 - Addendum\316004-Addendum template.docx

Name of Bidding Firm: \_\_\_\_\_

**BID FORM**

**BID NO. 315047**

**PROJECT: HENRY VILAS ZOO – PLAYGROUND RESURFACING**

**TO: DANE COUNTY DEPARTMENT OF PUBLIC WORKS, HIGHWAY & TRANSPORTATION PROJECT MANAGER  
1919 ALLIANT ENERGY CENTER WAY  
MADISON, WISCONSIN 53713**

**NOTE: WISCONSIN STATUTE 77.54 (9M) ALLOWS FOR NO SALES & USE TAX ON THE PURCHASE OF MATERIALS FOR COUNTY PUBLIC WORKS PROJECTS.**

**BASE BID - LUMP SUM:**

Dane County is inviting Bids for removing the existing playground surface to a depth necessary and a new replacement playground surface to be provided. A storm sewer inlet will be placed on the northerly side of the playground area and connected to the existing storm sewer. The existing concrete walkway along the carousel will be widened. The undersigned, having examined the site where the Work is to be executed and having become familiar with local conditions affecting the cost of the Work and having carefully examined the Drawings and Specifications, all other Construction Documents and Addenda thereto prepared by Dane County Department of Public Works, Highway & Transportation hereby agrees to provide all labor, materials, equipment and services necessary for the complete and satisfactory execution of the entire Work, as specified in the Construction Documents, for the Base Bid stipulated sum of:

\_\_\_\_\_ and \_\_\_\_\_ /100 Dollars  
Written Price

\$ \_\_\_\_\_  
Numeric Price

**ALTERNATE BID A – LUMP SUM: DELETE ALL CONCRETE WORK ASSOCIATED WITH WIDINING OF CONCRETE SIDEWALK IN FRONT OF CAROUSEL**

Provide pricing to Delete Concrete Work related to sidewalk:.

\_\_\_\_\_ and \_\_\_\_\_ /100 Dollars  
Written Price

\$ \_\_\_\_\_  
Numeric Price

**UNIT PRICING – PLAYGROUND SURFACE MATERIALS:**

Provide prices to furnish & install any basemat quantities other than listed in the Approximate Quantities shown on Drawing ST-3 BASEMAT THICKNESS (which are to be included in the BASE BID – LUMP SUM above). In the event basemat thickness is to be added or deleted from the square foot quantities shown on Drawing ST-3 provide a square foot cost for each thickness:

- 5 Inch Basemat Thickness: @ \$ \_\_\_\_\_ /square foot

- 3 Inch Basemat Thickness: @ \$ \_\_\_\_\_/square foot
- 1-1/2 Inch Basemat Thickness: @ \$ \_\_\_\_\_/square foot

Receipt of the following addenda and inclusion of their provisions in this Bid is hereby acknowledged:

Addendum No(s). \_\_\_\_\_ through \_\_\_\_\_

Dated \_\_\_\_\_

Dane County Henry Vilas Zoo must have this project completed by June 24, 2016. Assuming this Work can be started by May 16, 2016, what dates can you commence and complete this job?

Commencement Date: \_\_\_\_\_ Completion Date: \_\_\_\_\_  
(final, not substantial)

I hereby certify that all statements herein are made on behalf of:

\_\_\_\_\_  
(Name of Corporation, Partnership or Person submitting Bid)

Select one of the following:

1. A corporation organized and existing under the laws of the State of \_\_\_\_\_, or
2. A partnership consisting of \_\_\_\_\_, or
3. A person conducting business as \_\_\_\_\_;

Of the City, Village, or Town of \_\_\_\_\_ of the State of \_\_\_\_\_.

I have examined and carefully prepared this Bid from the associated Construction Documents and have checked the same in detail before submitting this Bid; that I have full authority to make such statements and submit this Bid in (its) (their) (my) behalf; and that the said statements are true and correct. In signing this Bid, we also certify that we have not, either directly or indirectly, entered into any agreement or participated in any collusion or otherwise taken any action in restraint of free competition; that no attempt has been made to induce any other person or firm to submit or not to submit a Bid; that this Bid has been independently arrived at without collusion with any other bidder, competitor, or potential competitor; that this Bid has not been knowingly disclosed prior to the Bids Due Date to another bidder or competitor; that the above statement is accurate under penalty of perjury.

The undersigned further agrees to honor the Base Bid and the Alternate Bid(s) for sixty (60) calendar days from date of Award of Contract.

**SIGNATURE:** \_\_\_\_\_  
(Bid is invalid without signature)

Print Name: \_\_\_\_\_ Date: \_\_\_\_\_

Title: \_\_\_\_\_

Address: \_\_\_\_\_

Telephone No.: \_\_\_\_\_ Fax No.: \_\_\_\_\_

Email Address: \_\_\_\_\_

Contact Person: \_\_\_\_\_

**THIS PAGE IS FOR BIDDERS' REFERENCE AND NEED NOT BE SUBMITTED WITH BID FORM.**

**BID CHECK LIST:**

These items **must** be included with Bid:

- Bid Form                                       Bid Bond                                       Fair Labor Practices Certification  
 Project Experience / Reference Summary (See Instructions To Bidders – Section 4).

**BIDDERS SHOULD BE AWARE OF THE FOLLOWING:**

**DANE COUNTY VENDOR REGISTRATION PROGRAM**

Any person bidding on any County contract must be registered with the Dane County Purchasing Division & pay an annual registration fee. A contract will not be awarded to an unregistered vendor. Obtain a *Vendor Registration Form* by calling 608/266-4131 or complete a new form or renewal online at:

[www.danepurchasing.com/registration](http://www.danepurchasing.com/registration)

**DANE COUNTY BEST VALUE CONTRACTING PRE-QUALIFICATION**

Contractors must be pre-qualified as a Best Value Contractor with the Dane County Public Works Engineering Division before the award of contract. Obtain a *Best Value Contracting Application* by calling 608/266-4018 or complete one online at:

[www.countyofdane.com/pwht/BVC\\_Application.aspx](http://www.countyofdane.com/pwht/BVC_Application.aspx)

**EQUAL BENEFITS REQUIREMENT**

By submitting a Bid, the contractor acknowledges that a condition of this contract is to provide equal benefits as required by Dane County Code of Ordinances Chapter 25.016. Contractor shall provide equal benefits as required by that Ordinance to all required employees during the term of the contract. Equal Benefits Compliance Payment Certification shall be submitted with final pay request. For more information:

[www.danepurchasing.com/partner\\_benefit.aspx](http://www.danepurchasing.com/partner_benefit.aspx)

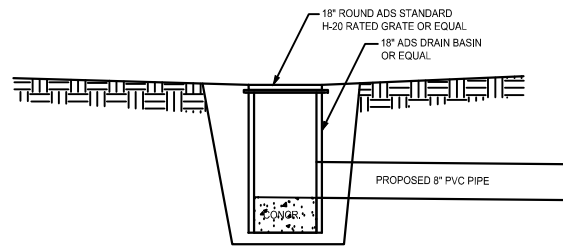

CONTRACTOR SHALL PROVIDE CONCRETE BELOW THE INVERT OF THE 8" PVC PIPE TO REMOVE THE SUMP.  
BACKFILL EXCAVATED HOLE WITH EXISTING MATERIAL, FREE OF LARGESTONES AND DEBRIS.

**18" DRAIN BASIN DETAIL**  
SCALE: NONE

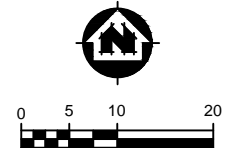

INSTALL POURED-IN PLACE PLAYGROUND RESURFACING SYSTEM

INSTALL 4-INCH LAYER OF MULCH OVER TOPSOIL (4-INCH MINIMUM THICKNESS)

INSTALL 13 LF OF CONCRETE LANDSCAPE EDGING

CONTRACTOR TO SAWCUT AROUND STRUCTURE AND REPLACE WITH CONCRETE.

REMOVE & REPLACE CONCRETE CURBING

REMOVE & REPLACE CONCRETE CURBING

CONNECT TO EXISTING STORM MANHOLE 8-INCH PVC INVERT ELEVATION = 847.80

INSTALL CONCRETE SIDEWALK SEE DETAIL ON SHEET G 2

RELOCATED TURTLE FEATURE LOCATION

REMOVE EXISTING CONCRETE CURBING

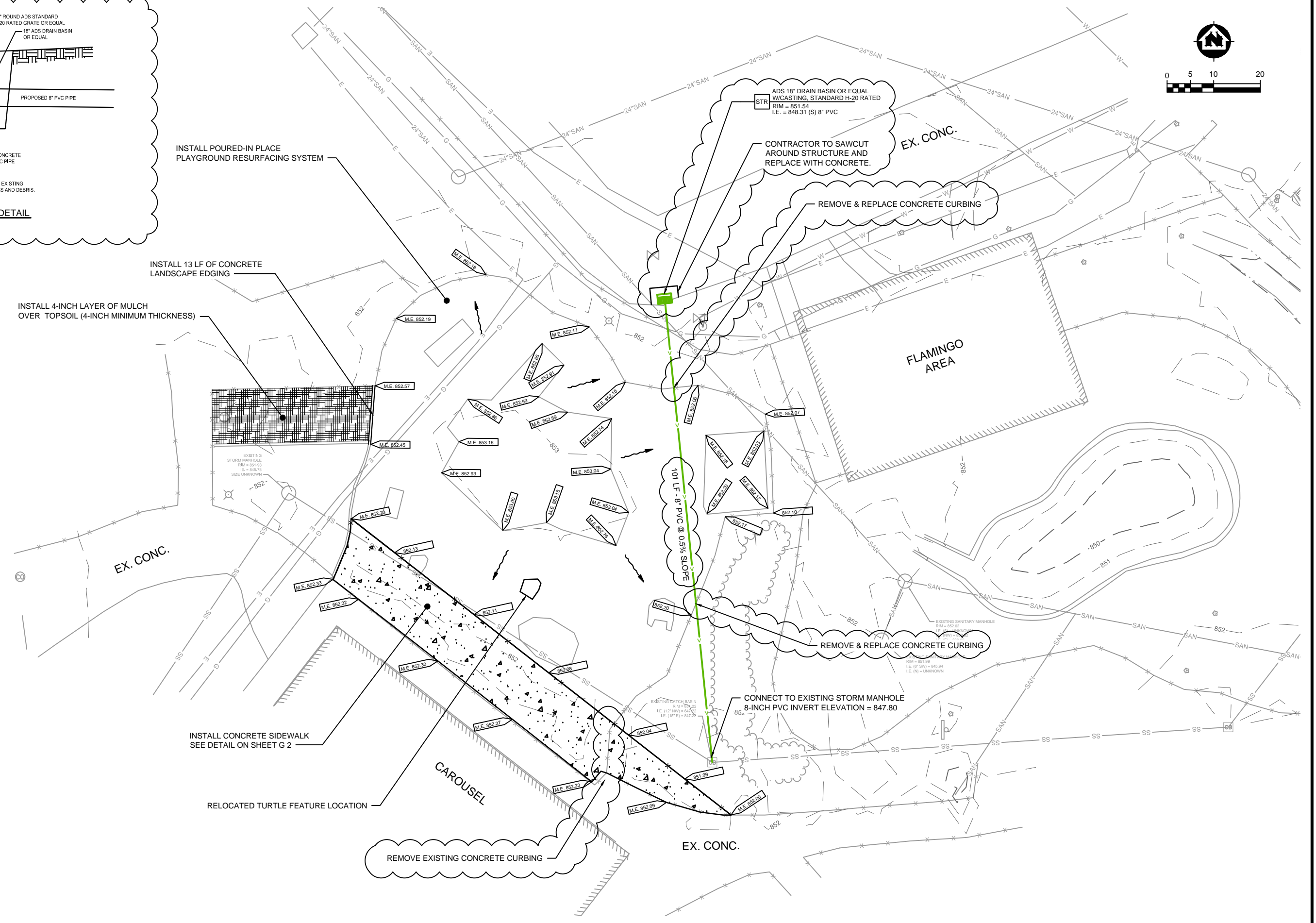

PROJECT NO.	SCALE	AS SHOWN	NO.	DATE	REVISION	BY
12698003	AS SHOWN		1	3/28/16		KNN
PROJECT DATE:	3/16/16	DRAWN BY:	KNN		ADDENDUM NO. 1	
F.B.:		CHECKED BY:	KCL			
PLOT DATE: 3/28/16, P:\1269003\1269003\CADD\C3D\12698003_Design.dwg						

**MSA** ARCHITECTURE | ENGINEERING | ENVIRONMENTAL FUNDING | PLANNING | SURVEYING  
2901 International Ln Madison, WI 53704  
(608) 242-7779 (800) 446-0679 Fax: (608) 242-5664  
Web Address: www.msa-ps.com

**HENRY VILAS ZOO - PLAYGROUND RESURFACING**  
DANE COUNTY PUBLIC WORKS DIVISION  
DANE COUNTY, WISCONSIN

**SITE PLAN & UTILITIES**

FILE NO.  
**12698003**  
SHEET  
**ST 2**