



DANE COUNTY DEPARTMENT of PUBLIC WORKS, HIGHWAY and TRANSPORTATION

County Executive
Joseph T. Parisi

1919 Alliant Energy Center Way ♦ Madison, Wisconsin 53713
Phone: (608) 266-4018 ♦ Fax: (608) 267-1533

Commissioner / Director
Gerald J. Mandli

APRIL 27, 2012

ATTENTION ALL REQUEST FOR PROPOSAL (RFP) HOLDERS

RFP NO. 312008 - ADDENDUM NO. 1

CNG FUELING STATION

PROPOSALS DUE: THURSDAY , MAY 3, 2012, 2:00 PM. DUE DATE AND TIME ARE NOT CHANGED BY THIS ADDENDUM.

This Addendum is issued to modify, explain or clarify the original RFP and is hereby made a part of the RFP. Please acknowledge this Addendum in your Proposal.

PLEASE MAKE THE FOLLOWING CHANGES:

1. BioCNG Priority over CNG

The fueling station must use cleaned up landfill gas as its only fuel whenever vehicle fueling demand allows. When the lower flow from the BioCNG cleanup skid is not enough to feed the CNG fueling station, based on fueling demand, the system must be able to begin using pipeline gas to create CNG at a faster rate. Overall, the entire system should be able to produce a minimum combined 40GGE/hr of CNG when it is using landfill gas and pipeline natural gas as inlet gas to the CNG compressors.

2. Grant Funding – wage rates

As explained in Specification Section 13210, paragraph 1.1.B, a portion of this project is being funded by the Wisconsin State Energy Office – CNG Infrastructure Challenge grant program. This grant does not require Davis-Bacon wage rates, but successful Proposer will still have to comply with all State of Wisconsin regulations, including DWD wage rate regulations.

3. Grant Funding – American-made products

The grant contract states, “It is the sense of Congress that, to the extent practicable, all equipment and products purchased with funds made available under this award should be American-made.” Therefore, Proposers should make every effort to source American-made products, but it is not an absolute requirement.

4. Alternate Proposal Price – No fuel tracking system

Any firm wishing to submit a pricing Proposal for the Base Proposal is required to also submit a pricing Proposal for the Alternate Proposal, as described in Paragraph F, Section 5 of the Requested Services and Business Information.

5. Optional Proposal Price - Installation

Submittal of a pricing Proposal for the system installation, as described in Paragraph F, Section 7 of the Requested Services and Business Information, is optional. In other words, firms submitting a Base Proposal and Alternate Proposal are not required to submit an Optional Installation Proposal if they do not wish to. In addition, Firms may submit an Optional Installation Pricing Proposal without submitting pricing for the Base Proposal or the Alternate Proposal.

Dane County has staff and equipment on-site to off-load the CNG station. Under the Optional Installation Proposal, contractor will be responsible for coordinating off-loading of CNG station, but Dane County staff will use County equipment to perform the actual off-loading.

6. Other Potential Cost Savings

Within the Cost Savings section, Proposers may also list suggested changes that would increase the price of the system if the suggested changes would result in increased system functionality, efficiency, safety, or some other system benefit. For each item listed, provide pricing, a detailed description of the change and how it will affect the performance of the system, and a detailed justification for the change.

7. Inlet Gas from BioCNG Skid

The bioCNG skid that cleans up the landfill gas will provide gas to the CNG station at 17.5-20 scfm, depending on the landfill gas quality. This equals approximately enough gas to produce 10 GGE of BioCNG per hour. This skid is capable of supplying cleaned landfill gas at any pressure up to 100psi.

8. Timeline and Payments

Dane County anticipates a contract will be signed and a PO issued by June 14, 2012. As part of the grant program, \$150,000 must be spent on this project by June 30, 2012. Therefore, successful Proposer should have an invoice ready on June 14, 2012 for \$150,000.00 for a downpayment/mobilization/preparation of plans and submittals. Additional payment terms can be negotiated, but Dane County will not pay for other components of the system unless the items are in successful Proposer's possession, with proof of insurance and items tagged for Dane County.

Dane County wishes to have construction completed in 2012. Please indicate in your Proposal in this is not possible.

9. Product Substitutions

Where definite material is specified, it is not the intention to discriminate against "equal" product made by another manufacturer. Intention is to set definite standard of material quality. Should bidder choose to bid materials other than those specified, bidder shall submit said materials specifications to Public Works Engineer for approval. Identify any request for substitution and give reasons for substitution. Public Works Engineer reserves right to approve or reject substitutions based on Specification requirements and intended use.

Document each request with complete data substantiating compliance of proposed Substitution with Contract Documents.

A request constitutes a representation that Contractor:

1. Has investigated proposed product and determined that it meets or exceeds quality level of specified product.

2. Will provide same warranty for Substitution as for specified product.
3. Will coordinate installation and make changes to other Work that may be required for the Work to be complete with no additional cost to Owner.
4. Waives claims for additional costs or time extension that may subsequently become apparent.

10. Product substitutions determined to be equal to those specified

1. Specification Section 13210, paragraph 3.3.D - GyroLok fittings are approved equal to SwageLok brand for ½” or smaller tubing.
2. Specification Section 13210, paragraph 3.3.DE - ASTM A 269/A213 steel tubing is approved equal.

11. Concrete Pad Required

Specification Section 13210, paragraph 3.1.E

Replace “asphalt” with “concrete”.

Successful Proposer is responsible for installing concrete pad as part of the Optional Price Proposal for Installation work.

12. Planholders

A list of planholders can be viewed online at

<https://www.countyofdane.com/login.aspx?ReturnUrl=/pwht/bid/logon.aspx>. After logging in to the website, click on the “Downloads” tab next to RFP 312008 to see a list of persons that have downloaded the RFP package.

In addition, the following is a list of persons that attended the pre-bid meeting.

Name	Company	Phone Number
Chris Behrendt	J.F. Ahern	920-907-5148
John Nelson	TV John and Son Inc	262-366-9732
Jerry Schueller	Acterra Group	608-568-3900
Chuck Nelson	Clean Energy	562-619-0019
Dan Hicks	ANGI Energy Systems	608-332-8947
Bill Carpenter	Walts Petroleum	715-551-0011

13. Sheet 1 (Cornerstone Sheet 3) – Possible BioCNG system layout

This sheet is for reference only. This is a possible layout for the BioCNG system. Proposing firm is welcome to suggest alternative layouts. Note that the drawing shows an incorrect number of slow-fill pumps. As described in the RFP, there will be a total of two slow fill pumps, which shall each be twin-hose dispensers

14. Sheet 2 (Cornerstone Sheet 2) - Possible BioCNG system layout

This sheet is for reference only. This is another possible layout for the BioCNG system. Proposing firm is welcome to suggest alternative layouts. Note that the drawing shows an incorrect number of slow-fill pumps. As described in the RFP, there will be a total of two slow fill pumps, which shall each be twin-hose dispensers

15. Sheet 3 (Graef Sheet C500) – Other Work By Others

This sheet is for reference only. As mentioned in the pre-bid meeting, Dane County has another construction project at this site that will be starting in June 2012. That project involves the construction of an approximately 27,500 square foot waste transfer station and household hazardous waste building. This drawing shows that work by others. Successful Proposer on RFP 312008 must coordinate work with other contractors that will be on-site.

Specific attention should be made to coordinating the site utilities, including natural gas to the site.

If any additional information about this Addendum is needed, please contact John Welch at 608/516-4154 or Welch@countyofdane.com.

Enclosures:
Sheets 1-3

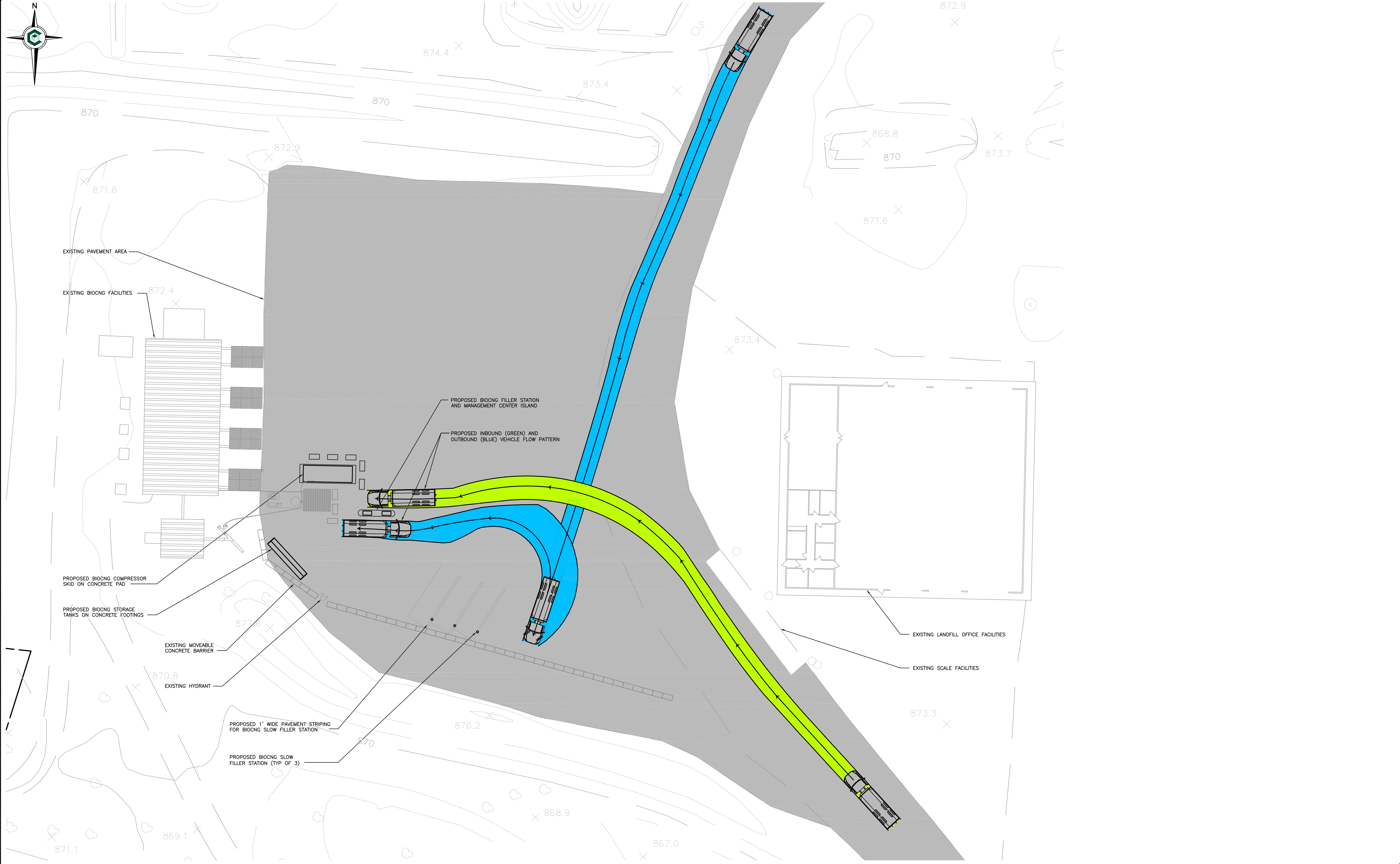
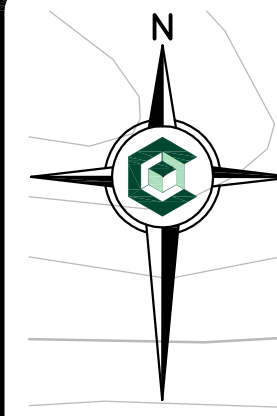

File: X:\PROJECTS\DAKE COUNTY\20084 - LFG and BIOCNG Services PO 20120611\00\PROJECT DRAWINGS\MDC\BSPD0 - CONCEPT PLAN C User: sam.walshengger Feb 23, 2012 - 4:18pm
 1" = 40'
 1/2" = 20'
 0 20 40
 SCALE IN FEET

REV	DATE	DESCRIPTION	OWN BY	DES BY	CHK BY	APP BY
02	02/2012	DATE OF ISSUE				
		DRAWN BY				
		DESIGNED BY				
		CHECKED BY				
		APPROVED BY				

CORNERSTONE
Environmental Group, LLC

This drawing represents intellectual property of Cornerstone Environmental Group, LLC. Any modification to the original by other than Cornerstone Environmental Group, LLC personnel violates its original purpose and as such is rendered void. Cornerstone Environmental Group, LLC will not be held liable for any changes made to this document without express written consent of the originator.

DANE COUNTY, UNISON SOLUTIONS, INC
 LFG & BIOCNG SERVICES
 DANE COUNTY LANDFILL, MADISON, WI 53718

CONCEPTUAL PLAN C

SHEET NO.
3
 PROJECT NO.
 120204

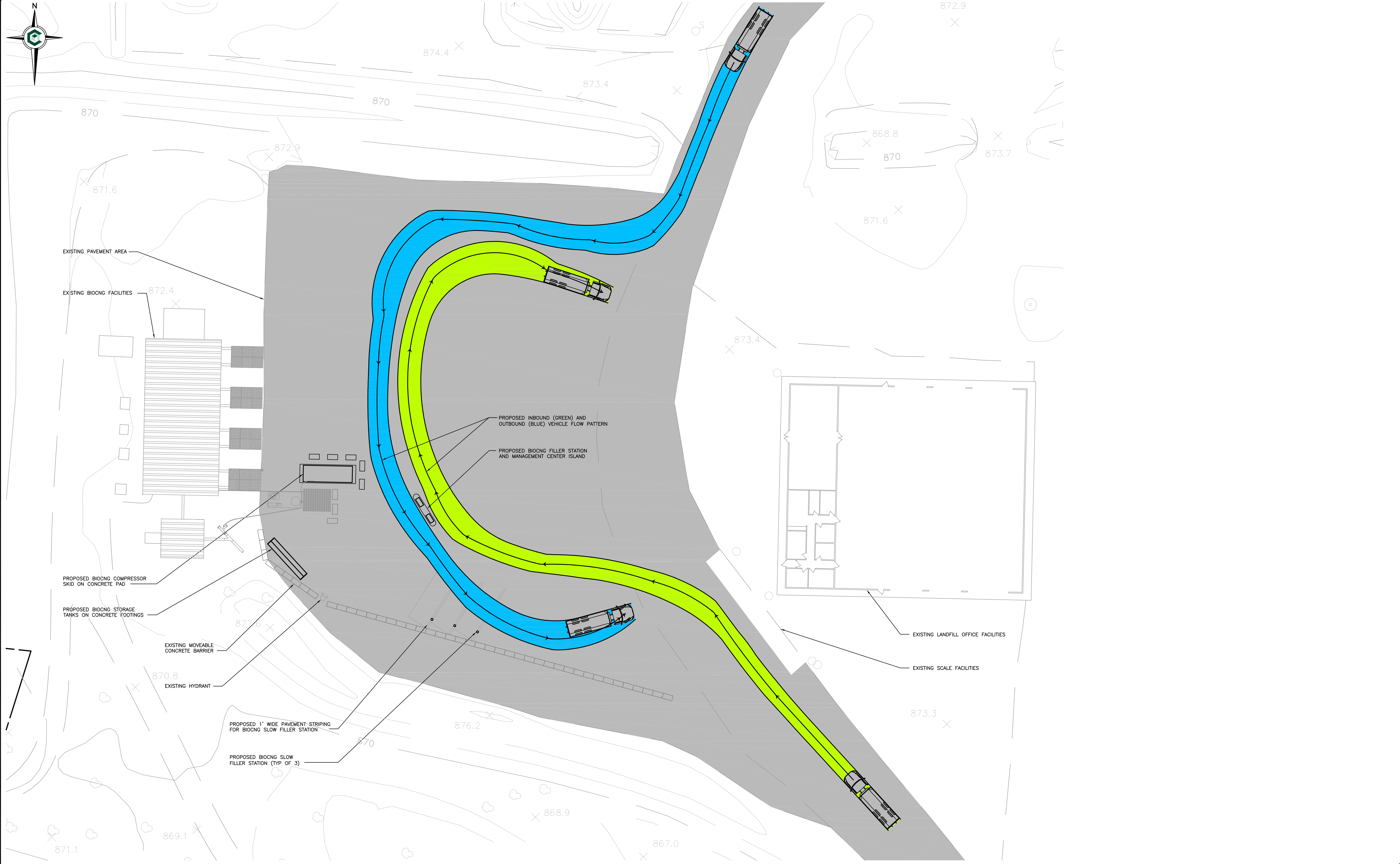
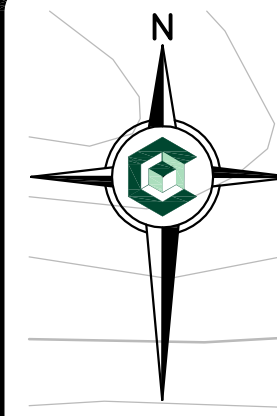

File: X:\PROJECTS\DANE COUNTY\20084 - LFG and BIOCNG Services PO 20120611\00\PROJECT DRAWINGS\MDC\BSPD02 - CONCEPT PLAN B User: sam.walshengrger Feb 23, 2012 - 4:20pm
 1" = 20'
 0" 20' 40'
 SCALE IN FEET

REV	DATE	DESCRIPTION	OWN BY	DES BY	CHK BY	APP BY
02	02/2012	DATE OF ISSUE				
		DRAWN BY				
		DESIGNED BY				
		CHECKED BY				
		APPROVED BY				



This drawing represents intellectual property of Cornerstone Environmental Group, LLC. Any modification to the original by other than Cornerstone Environmental Group, LLC personnel violates its original purpose and as such is rendered void. Cornerstone Environmental Group, LLC will not be held liable for any changes made to this document without express written consent of the originator.

DANE COUNTY, UNISON SOLUTIONS, INC
LFG & BIOCNG SERVICES
DANE COUNTY LANDFILL, MADISON, WI 53718

CONCEPTUAL PLAN B

SHEET NO.
2
PROJECT NO.
120204

GENERAL NOTES

1. BASE SURVEY WAS PREPARED BY QUAM ENGINEERING, SEPTEMBER 2009. UNDERGROUND UTILITIES HAVE BEEN SHOWN TO A REASONABLE DEGREE OF ACCURACY AND IT SHALL BE THE CONTRACTOR'S RESPONSIBILITY TO VERIFY THEIR EXACT LOCATION.
2. BUILDING LATERALS SHALL BE CONSTRUCTED IN ACCORDANCE WITH LOCAL AND STATE PLUMBING CODES. SITE UTILITY CONTRACTOR TO STUB LATERALS TO 5 FEET OUTSIDE OF BUILDING. SEE PLUMBING DRAWINGS FOR CONTINUATION OF PIPING INSIDE OF BUILDING BY PLUMBING CONTRACTOR.
3. CONTRACTOR SHALL VERIFY ELEVATION OF EXISTING INVERTS PRIOR TO INSTALLATION OF PROPOSED UTILITIES. AT WATER MAIN CROSSINGS, CENTER ONE FULL LENGTH OF WATER PIPE ON SEWER THAT BOTH JOINTS WILL BE AS FAR FROM SEWER AS POSSIBLE.
4. CONTRACTOR TO COORDINATE WITH LOCAL GAS, TELEPHONE AND ELECTRIC UTILITIES FOR EXACT LOCATION, SIZE AND DEPTH OF NEW SERVICE.
5. SANITARY SEWER SHALL BE SDR-35, PVC. STORM SEWER ROOF DRAINS SHALL BE SDR-35, PVC. STORM SEWER SHALL BE HERCP, RCP AND HDPE, SEE PLANS FOR LOCATIONS OF DIFFERENT PIPE MATERIALS. WATER MAIN SHALL BE PVC PIPE, AWWA C900, DR 18.
6. SEE MECHANICAL DRAWINGS FOR DETAILS RELATING TO ALTERNATE HYDRONIC PIPING.
7. EXISTING 12 INCH GAS LINE EXISTS BELOW EXISTING BERM SOUTH OF GAS/ENERGY PLANT. VERIFY LOCATION PRIOR TO INSTALLATION OF SANITARY SEWER. NOTIFY ENGINEER OF CONFLICTS.
8. EXISTING 2 INCH WATER LINE EXISTS FROM APPROXIMATELY 5 FEET NORTH OF THE EXISTING HYDRANT TO THE EXISTING SCALE BUILDING. COORDINATE TEE CONNECTION TO NEW SERVICE TO WASTE TRANSFER STATION WITH CONNECTION TO SCALE BUILDING.
9. ALTERNATE HEAT PIPING SHALL FOLLOW THE PROPOSED WATER MAIN ALIGNMENT BOTH HORIZONTALLY AND VERTICALLY. SEE DETAIL 6/C902.

LEGEND

- STM- - PROPOSED STORM SEWER
- SAN- - PROPOSED SANITARY SEWER
- W- - PROPOSED WATER MAIN
- - PROPOSED CATCH BASIN
- - PROPOSED CLEANOUT
- ▽ - PROPOSED FLARED END SECTION
- - PROPOSED MANHOLE
- ⊙ - PROPOSED HYDRANT
- ⊙ - PROPOSED GATE VALVE
- - PROPOSED SITE LIGHT

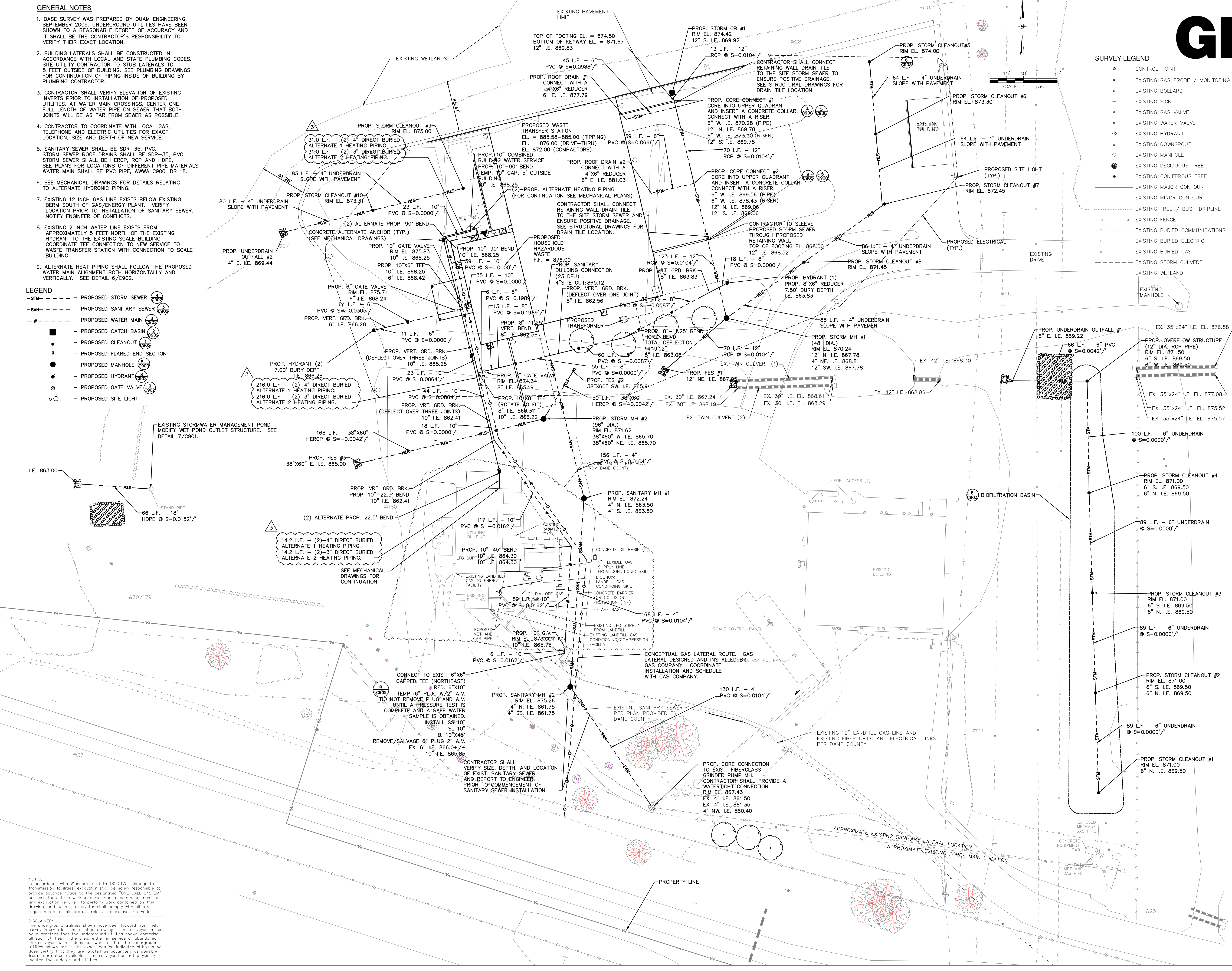

NOTICE:
In accordance with Wisconsin statute 182.0175, damage to transmission facilities, excavator shall be solely responsible to provide advance notice to the designated "ONE CALL SYSTEM" not less than three working days prior to commencement of any excavation required to perform work contained on this drawing, and further, excavator shall comply with all other requirements of this statute relative to excavator's work.

DISCLAIMER:
The underground utilities shown have been located from field survey information and existing drawings. The surveyor makes no guarantee that the underground utilities shown comprise all such utilities in the area, either in service or abandoned. The surveyor further does not warrant that the underground utilities shown are in the exact location indicated although he does certify that they are located as accurately as possible from information available. The surveyor has not physically located the underground utilities.