

2015 RESTORATION CAPITOL SQUARE SOUTH PARKING RAMP DANE COUNTY, WI



113 S. HENRY STREET
MADISON, WI 53703

DANE COUNTY RFB # 315024
APRIL 16, 2015

PROJECT LOCATION



NORTH

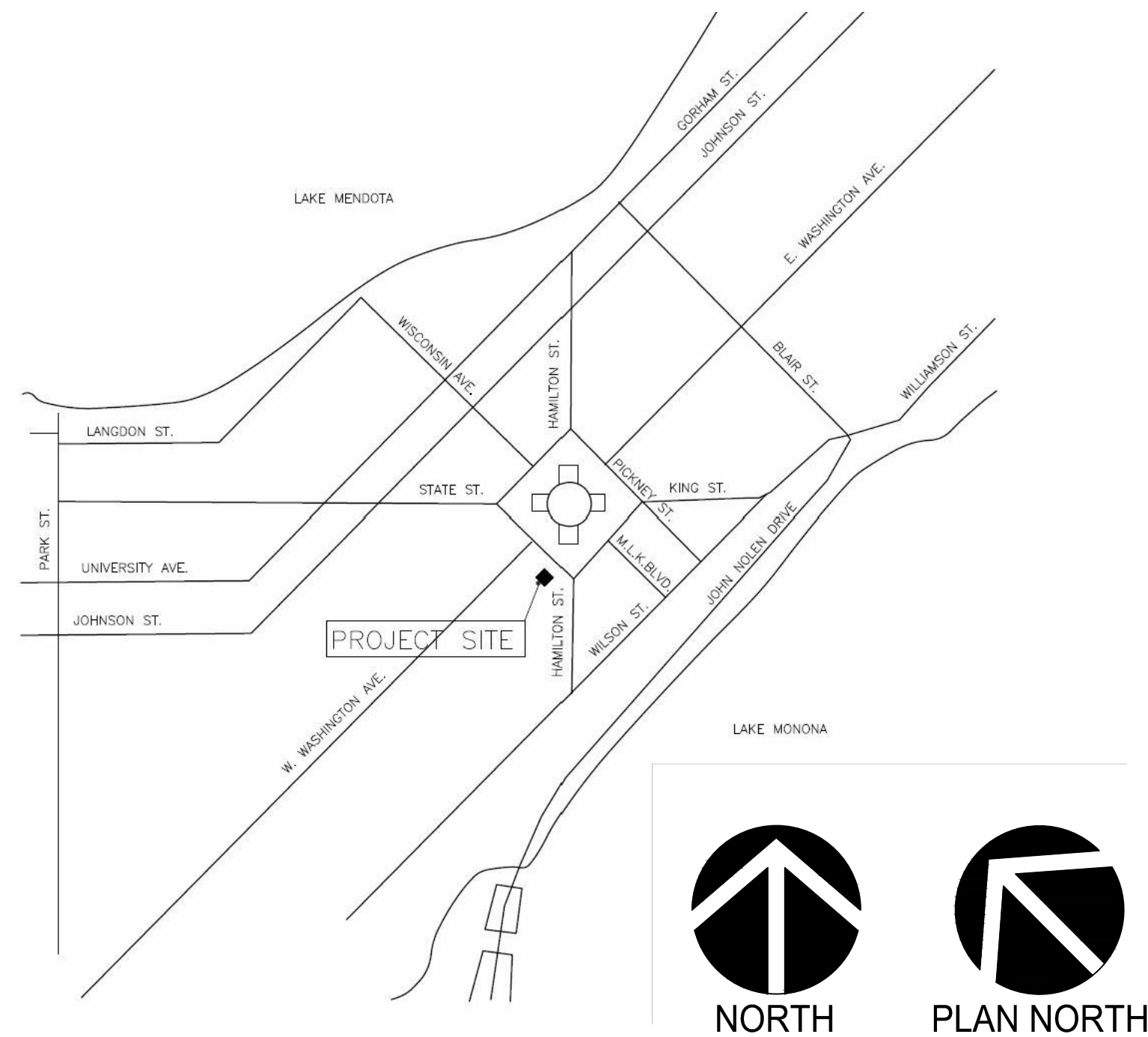

NORTH



PLAN NORTH

DRAWING INDEX

TITLE SHEET	T-1
LEVEL 5 TOPSIDE PLAN	S-1
LEVEL 6 TOPSIDE PLAN	S-2
LEVEL 7 TOPSIDE PLAN	S-3
LEVEL 6 UNDERSIDE PLAN	S-4
LEVEL 7 UNDERSIDE PLAN	S-5
DETAILS	D-1
DETAILS	D-2

JSD Professional Services, Inc.
• Engineers • Surveyors • Planners

"BUILDING RELATIONSHIPS WITH A COMMITMENT TO CLIENT SATISFACTION THROUGH TRUST, QUALITY AND EXPERIENCE"

- CIVIL ENGINEERING
- SURVEYING & MAPPING
- CONSTRUCTION SERVICES
- WATER RESOURCES
- PLANNING & DEVELOPMENT
- TRANSPORTATION ENGINEERING
- STRUCTURAL ENGINEERING
- LANDSCAPE ARCHITECTURE

MADISON REGIONAL OFFICE
161 HORIZON DRIVE, SUITE 101
VERONA, WISCONSIN 53593
608.848.5060 PHONE | 608.848.2255 FAX

MADISON | MILWAUKEE
KENOSHA | APPLETON
www.jsdinc.com

SERVICES PROVIDED TO:

DANE
COUNTY
PUBLIC
WORKS



1919 ALLIANT ENERGY CENT. WAY
MADISON, WI 53713

PROJECT:

2015 RESTORATION
CAPITOL SQUARE
SOUTH
PARKING RAMP

PROJECT LOCATION:

113 S. HENRY STREET
MADISON, WI 53703

RFB #: 315024

SEAL/SIGNATURE:

ALTHOUGH EVERY EFFORT HAS BEEN MADE IN PREPARING THESE PLANS AND CHECKING THEM FOR ACCURACY, THE CONTRACTOR AND SUBCONTRACTORS MUST CHECK ALL DETAIL AND DIMENSIONS OF THEIR TRADE AND BE RESPONSIBLE FOR THE SAME.

DESIGN: PGB
DRAWN: PGB
APPROVED: JJE

PLAN MODIFICATIONS: DATE:

DIGGERS HOTLINE

Toll Free (800) 242-8511
Milwaukee Area (414) 259-1181
Hearing Impaired TDD (800) 542-2289
www.DiggersHotline.com

SHEET TITLE:

TITLE SHEET

SHEET NUMBER:

T-1

INFORMATION PERTAINING TO EXISTING CONDITIONS GIVEN ON THESE DRAWINGS REPRESENTS TO THE BEST OF OUR KNOWLEDGE THE ACTUAL EXISTING FIELD CONDITIONS. JSD PROFESSIONAL SERVICES, INC. MAKES NO WARRANTY AS TO THEIR ACCURACY. CONTRACTOR TO FIELD VERIFY EXISTING CONDITIONS IMPERATIVE TO THE NEW WORK. REPORT DISCREPANCIES BETWEEN DRAWINGS AND FIELD CONDITIONS TO THE ENGINEER FOR REVIEW. ANY WORK PERFORMED PRIOR TO RESOLUTION OF DISCREPANCIES BY THE ENGINEER IS SUBJECT TO REMOVAL AND REPLACEMENT AT NO ADDITIONAL COST TO THE CONTRACT.

CONTRACTORS ARE RESPONSIBLE FOR THE MEANS, METHODS, TECHNIQUES, SEQUENCES, AND PROCEDURES OF CONSTRUCTION INCLUDING, BUT NOT LIMITED TO TEMPORARY SUPPORTS, SHORING, AND FORMING TO SUPPORT IMPOSED LOADS AND OTHER SIMILAR ITEMS.

THE LOCATION OF DETERIORATED CONCRETE AND CRACKS SHOWN ARE FOR REFERENCE PURPOSES ONLY. DETERIORATED CONCRETE AND CRACKS TO BE REPAIRED WILL BE DESIGNATED BY THE ENGINEER AT THE TIME OF CONSTRUCTION.

- NUMBER IN HEXAGON REPRESENTS BID/WORK ITEM FOUND IN SECTION 01 15 10 OF TECHNICAL SPECIFICATIONS
- ▨ UNSOUND CONCRETE
- CRACK

SERVICES PROVIDED TO:

DANE COUNTY PUBLIC WORKS



1919 ALLIANT ENERGY CENT. WAY
 MADISON, WI 53713

PROJECT:

**2015 RESTORATION
 CAPITOL SQUARE
 SOUTH
 PARKING RAMP**

PROJECT LOCATION:

113 S. HENRY STREET
 MADISON, WI 53703

RFB #: 315024

SEAL/SIGNATURE:

ALTHOUGH EVERY EFFORT HAS BEEN MADE IN PREPARING THESE PLANS AND CHECKING THEM FOR ACCURACY, THE CONTRACTOR AND SUBCONTRACTORS MUST CHECK ALL DETAIL AND DIMENSIONS OF THEIR TRADE AND BE RESPONSIBLE FOR THE SAME.

DESIGN: PGB
 DRAWN: PGB
 APPROVED: JJE

PLAN MODIFICATIONS: DATE:



Toll Free (800) 242-8511
 Milwaukee Area (414) 259-1181
 Hearing Impaired TDD (800) 542-2289
 www.DiggersHotline.com

SHEET TITLE:

**LEVEL 5
 TOPSIDE
 PLAN**

SHEET NUMBER:

S-1

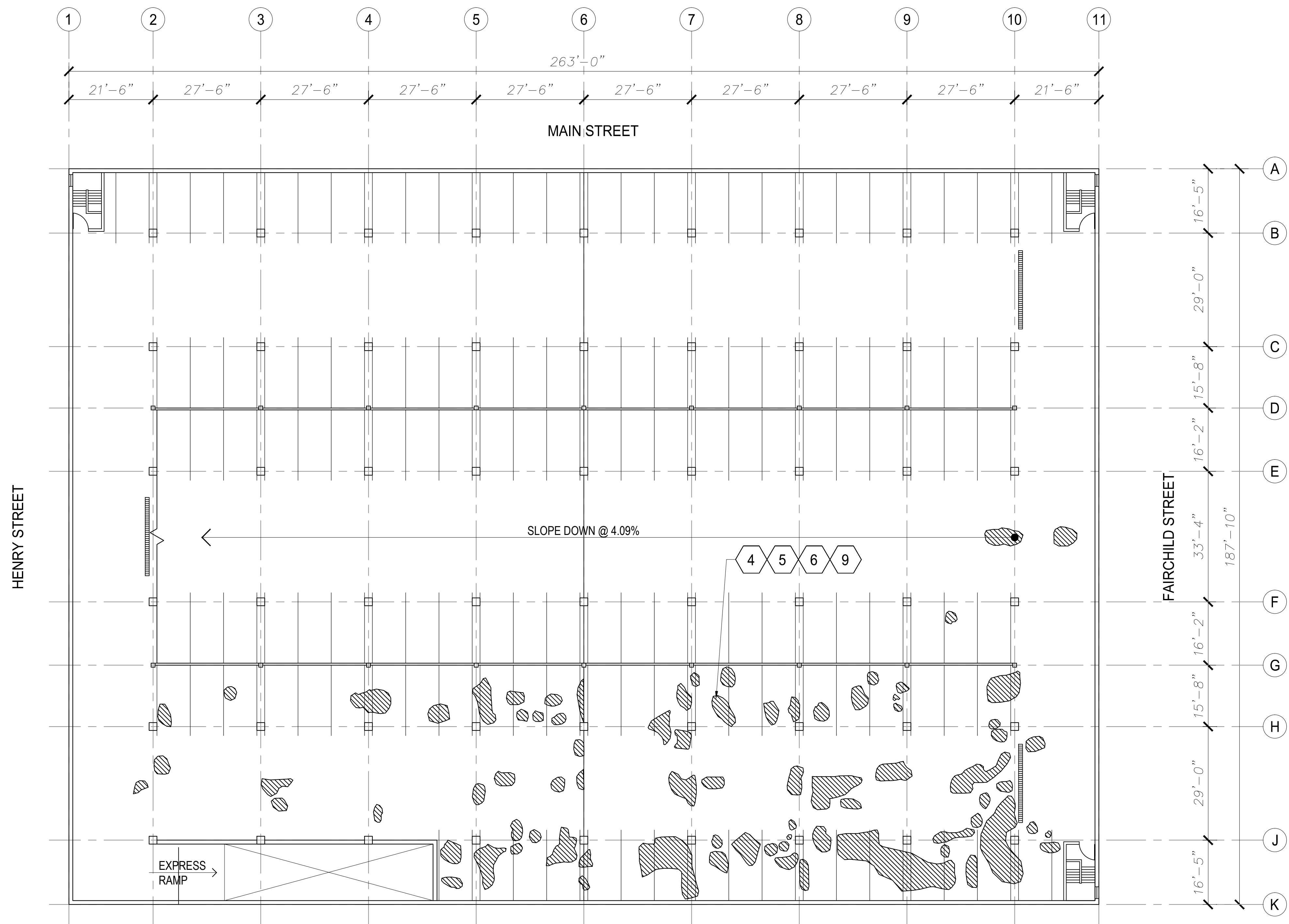

1
 S-1

LEVEL 5 FLOOR PLAN

SCALE: 1/16" = 1'-0"

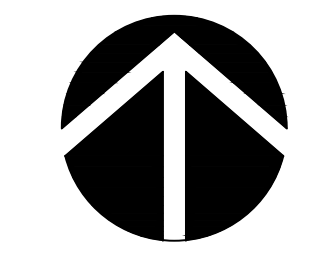

PLAN NORTH

LEGEND

- CONCRETE DELAMINATION AREA
- HYDRODEMOLITION OR MILLING AREA
- ⊗ REPAIR ITEM REFERRING TO SECTION 01 15 10

File: c:\2013\135982\2015 Restoration\DWG\2015 Restoration - GSS Ramp.dwg Layout: S-1 User: pbaker PlotDate: Apr 15, 2015 - 2:39pm Xref's:

SERVICES PROVIDED TO:

DANE COUNTY PUBLIC WORKS



1919 ALLIANT ENERGY CENT. WAY
 MADISON, WI 53713

PROJECT:

**2015 RESTORATION
 CAPITOL SQUARE
 SOUTH
 PARKING RAMP**

PROJECT LOCATION:

113 S. HENRY STREET
 MADISON, WI 53703

RFB #: 315024

SEAL/SIGNATURE:

ALTHOUGH EVERY EFFORT HAS BEEN MADE IN PREPARING THESE PLANS AND CHECKING THEM FOR ACCURACY, THE CONTRACTOR AND SUBCONTRACTORS MUST CHECK ALL DETAIL AND DIMENSIONS OF THEIR TRADE AND BE RESPONSIBLE FOR THE SAME.

DESIGN: PGB
 DRAWN: PGB
 APPROVED: JJE

PLAN MODIFICATIONS: DATE:

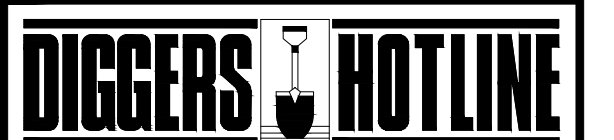

Toll Free (800) 242-8511
 Milwaukee Area (414) 259-1181
 Hearing Impaired TDD (800) 542-2289
 www.DiggersHotline.com

SHEET TITLE:

**LEVEL 6
 TOPSIDE
 PLAN**

SHEET NUMBER:

S-2

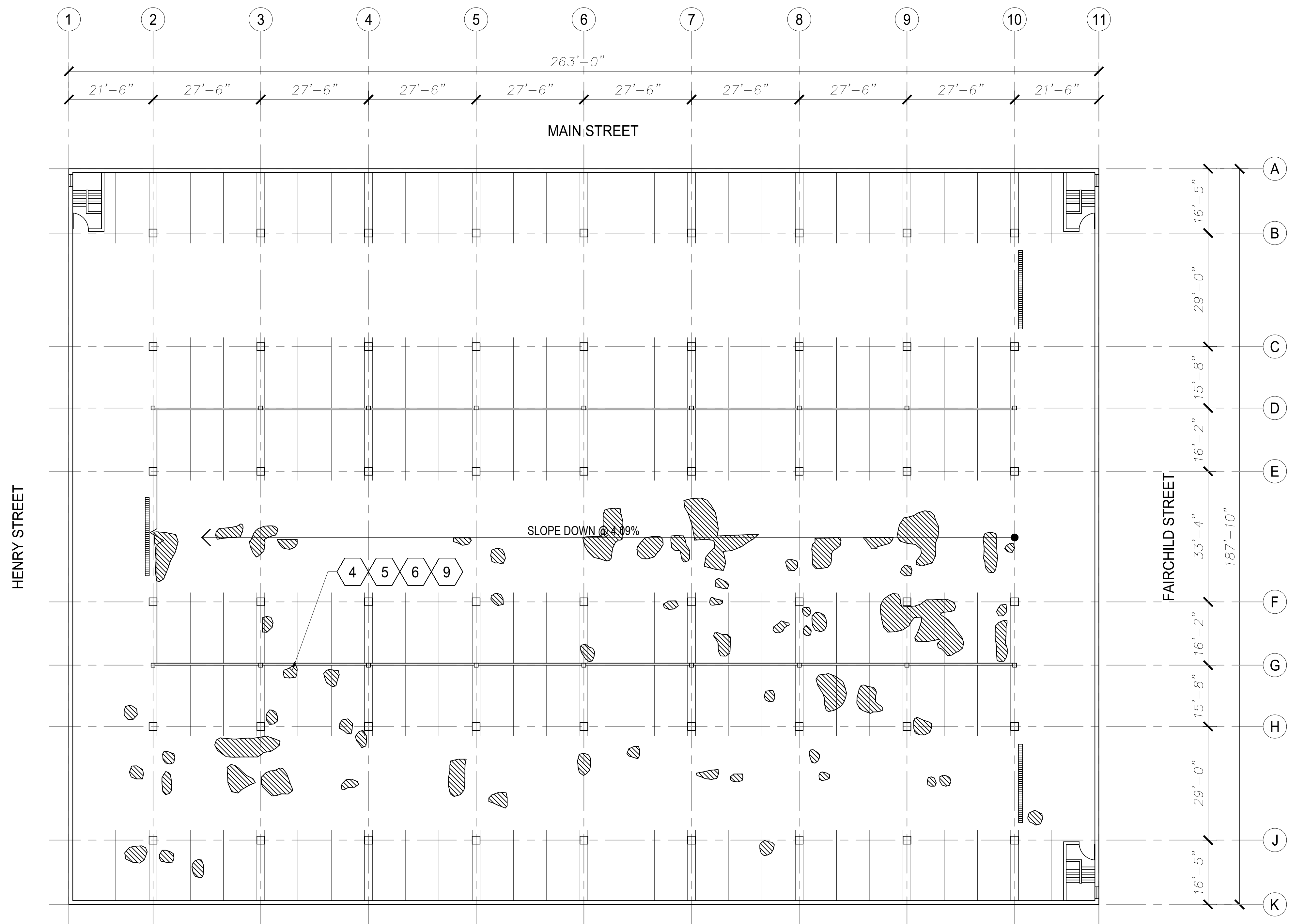

1
 S-2

LEVEL 6 FLOOR PLAN

SCALE: 1/16" = 1'-0"

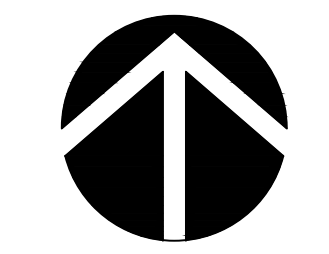

PLAN NORTH

LEGEND

- CONCRETE DELAMINATION AREA
- HYDRODEMOLITION OR MILLING AREA
- ⊗ REPAIR ITEM REFERRING TO SECTION 01 15 10

SERVICES PROVIDED TO:

DANE COUNTY PUBLIC WORKS



1919 ALLIANT ENERGY CENT. WAY
 MADISON, WI 53713

PROJECT:

**2015 RESTORATION
 CAPITOL SQUARE
 SOUTH
 PARKING RAMP**

PROJECT LOCATION:

113 S. HENRY STREET
 MADISON, WI 53703

RFB #: 315024

SEAL/SIGNATURE:

ALTHOUGH EVERY EFFORT HAS BEEN MADE IN PREPARING THESE PLANS AND CHECKING THEM FOR ACCURACY, THE CONTRACTOR AND SUBCONTRACTORS MUST CHECK ALL DETAIL AND DIMENSIONS OF THEIR TRADE AND BE RESPONSIBLE FOR THE SAME.

DESIGN: PGB
 DRAWN: PGB
 APPROVED: JJE

PLAN MODIFICATIONS: DATE:

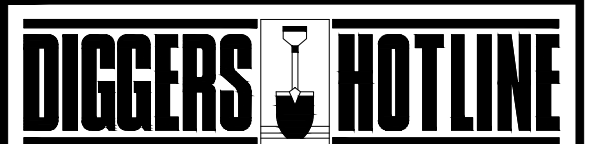

Toll Free (800) 242-8511
 Milwaukee Area (414) 259-1181
 Hearing Impaired TDD (800) 542-2289
 www.DiggersHotline.com

SHEET TITLE:

**LEVEL 7
 TOPSIDE
 PLAN**

SHEET NUMBER:

S-3

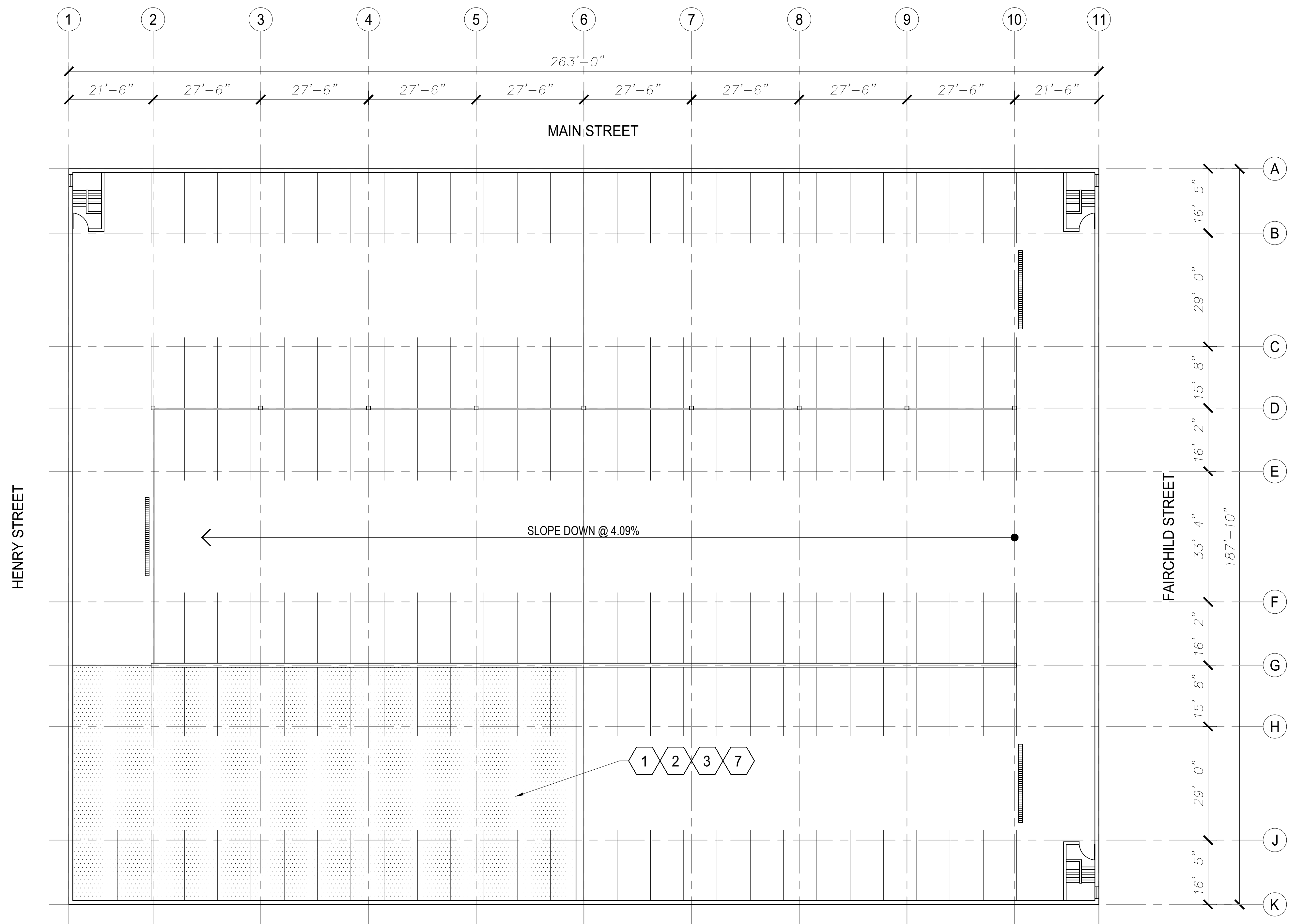

1
 S-3

LEVEL 7 FLOOR PLAN

SCALE : 1/16" = 1'-0"

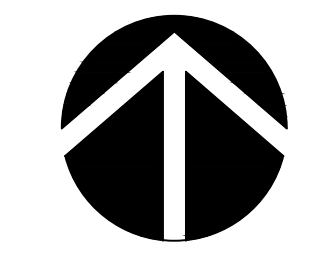

PLAN NORTH

LEGEND

- CONCRETE DELAMINATION AREA
- HYDRODEMOLITION OR MILLING AREA
- ⊗ REPAIR ITEM REFERRING TO SECTION 01 15 10

SERVICES PROVIDED TO:

DANE COUNTY PUBLIC WORKS



1919 ALLIANT ENERGY CENT. WAY
 MADISON, WI 53713

PROJECT:

**2015 RESTORATION
 CAPITOL SQUARE
 SOUTH
 PARKING RAMP**

PROJECT LOCATION:

113 S. HENRY STREET
 MADISON, WI 53703

RFB #: 315024

SEAL/SIGNATURE:

ALTHOUGH EVERY EFFORT HAS BEEN MADE IN PREPARING THESE PLANS AND CHECKING THEM FOR ACCURACY, THE CONTRACTOR AND SUBCONTRACTORS MUST CHECK ALL DETAIL AND DIMENSIONS OF THEIR TRADE AND BE RESPONSIBLE FOR THE SAME.

DESIGN: PGB
 DRAWN: PGB
 APPROVED: JJE

PLAN MODIFICATIONS: DATE:

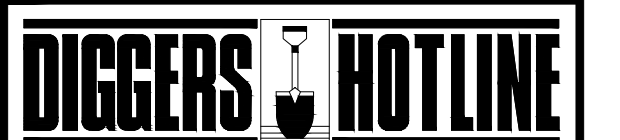

Toll Free (800) 242-8511
 Milwaukee Area (414) 259-1181
 Hearing Impaired TDD (800) 542-2289
 www.DiggersHotline.com

SHEET TITLE:

**LEVEL 6
 UNDERSIDE
 PLAN**

SHEET NUMBER:

S-4

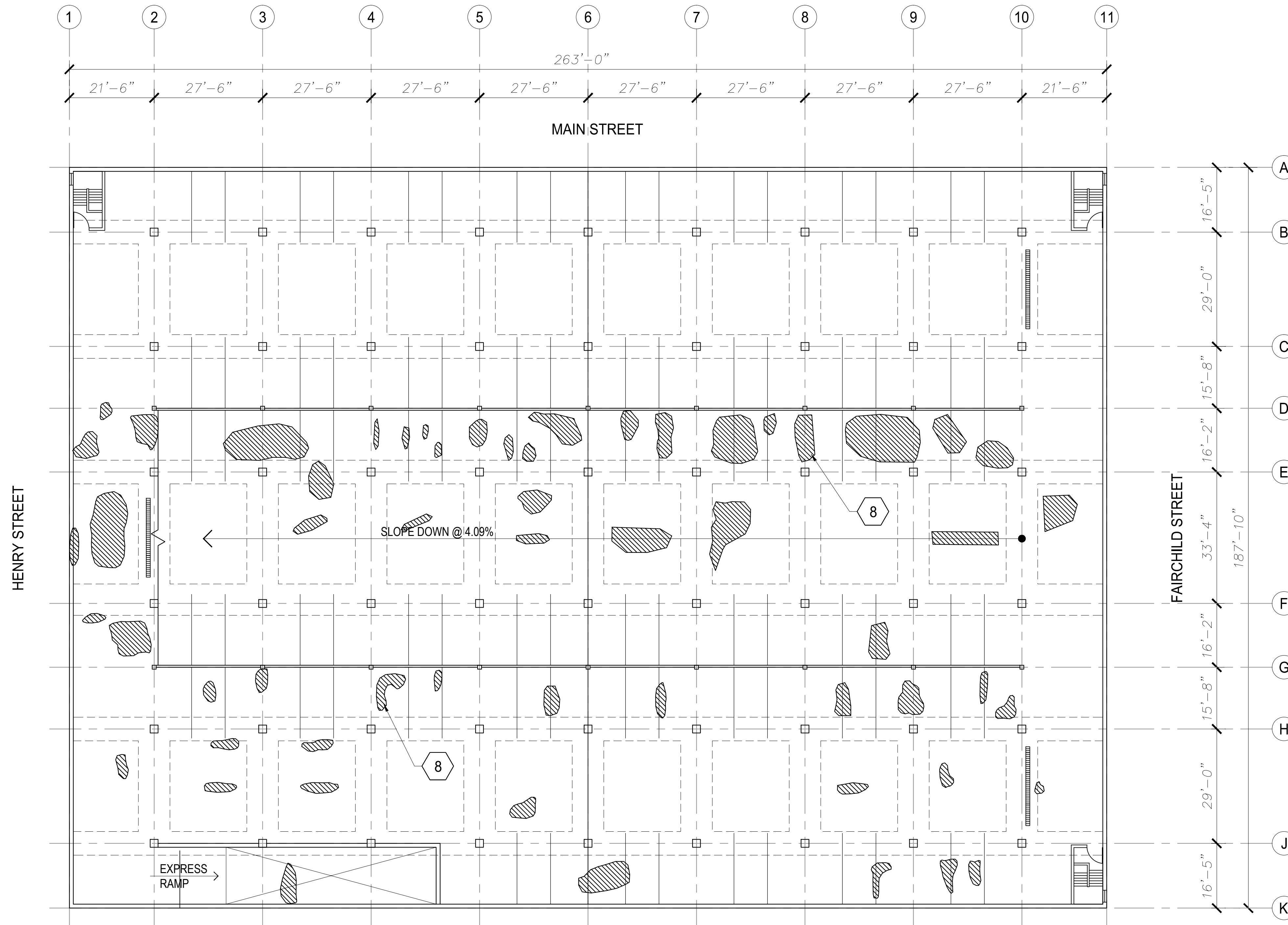

1
 S-4

LEVEL 6 UNDERSIDE PLAN

SCALE: 1/16" = 1'-0"

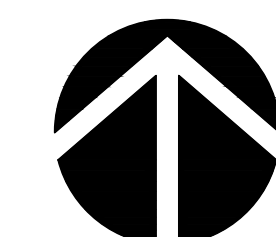

PLAN NORTH

LEGEND

- CONCRETE DELAMINATION AREA
- REPAIR ITEM REFERRING TO SECTION 01 15 10

SERVICES PROVIDED TO:

DANE COUNTY PUBLIC WORKS



1919 ALLIANT ENERGY CENT. WAY
 MADISON, WI 53713

PROJECT:

**2015 RESTORATION
 CAPITOL SQUARE
 SOUTH
 PARKING RAMP**

PROJECT LOCATION:

113 S. HENRY STREET
 MADISON, WI 53703

RFB #:

315024

SEAL/SIGNATURE:

ALTHOUGH EVERY EFFORT HAS BEEN MADE IN PREPARING THESE PLANS AND CHECKING THEM FOR ACCURACY, THE CONTRACTOR AND SUBCONTRACTORS MUST CHECK ALL DETAIL AND DIMENSIONS OF THEIR TRADE AND BE RESPONSIBLE FOR THE SAME.

DESIGN: PGB
 DRAWN: PGB
 APPROVED: JJE

PLAN MODIFICATIONS: DATE:



Toll Free (800) 242-8511
 Milwaukee Area (414) 259-1181
 Hearing Impaired TDD (800) 542-2289
 www.DiggersHotline.com

SHEET TITLE:

**LEVEL 7
 UNDERSIDE
 PLAN**

SHEET NUMBER:

S-5

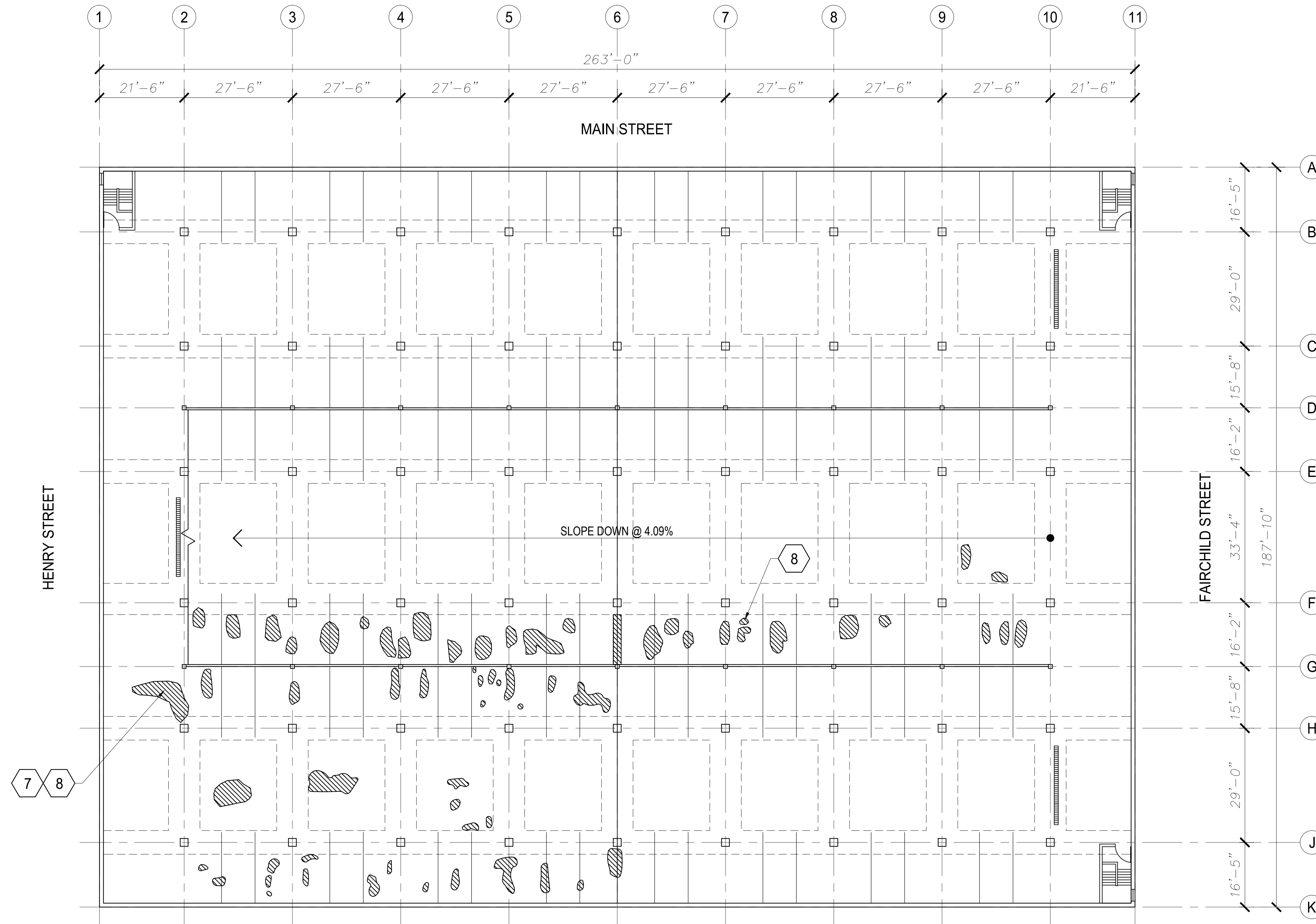

1
 S-5

LEVEL 7 UNDERSIDE PLAN

SCALE : 1/16" = 1'-0"

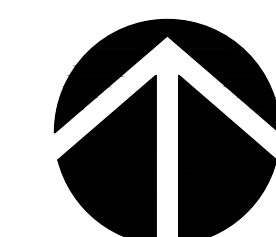

PLAN NORTH

LEGEND

- CONCRETE DELAMINATION AREA
- REPAIR ITEM REFERRING TO SECTION 01 15 10

- CIVIL ENGINEERING
- SURVEYING & MAPPING
- CONSTRUCTION SERVICES
- WATER RESOURCES
- PLANNING & DEVELOPMENT
- TRANSPORTATION ENGINEERING
- STRUCTURAL ENGINEERING
- LANDSCAPE ARCHITECTURE

MADISON REGIONAL OFFICE
 161 HORIZON DRIVE, SUITE 101
 VERONA, WISCONSIN 53593
 608.848.5060 PHONE | 608.848.2255 FAX

MADISON | MILWAUKEE
 KENOSHA | APPLETON

www.jsdinc.com

SERVICES PROVIDED TO:

DANE COUNTY PUBLIC WORKS



1919 ALLIANT ENERGY CENT. WAY
 MADISON, WI 53713

PROJECT:

**2015 RESTORATION
 CAPITOL SQUARE
 SOUTH
 PARKING RAMP**

PROJECT LOCATION:

113 S. HENRY STREET
 MADISON, WI 53703

RFB #: 315024

SEAL/SIGNATURE:

ALTHOUGH EVERY EFFORT HAS BEEN MADE IN PREPARING THESE PLANS AND CHECKING THEM FOR ACCURACY, THE CONTRACTOR AND SUBCONTRACTORS MUST CHECK ALL DETAIL AND DIMENSIONS OF THEIR TRADE AND BE RESPONSIBLE FOR THE SAME.

DESIGN: JJE
 DRAWN: PGB
 APPROVED: JJE

PLAN MODIFICATIONS: DATE:



Toll Free (800) 242-8511
 Milwaukee Area (414) 259-1181
 Hearing Impaired TDD (800) 542-2289
 www.DiggersHotline.com

SHEET TITLE:

DETAILS

SHEET NUMBER:

D-1

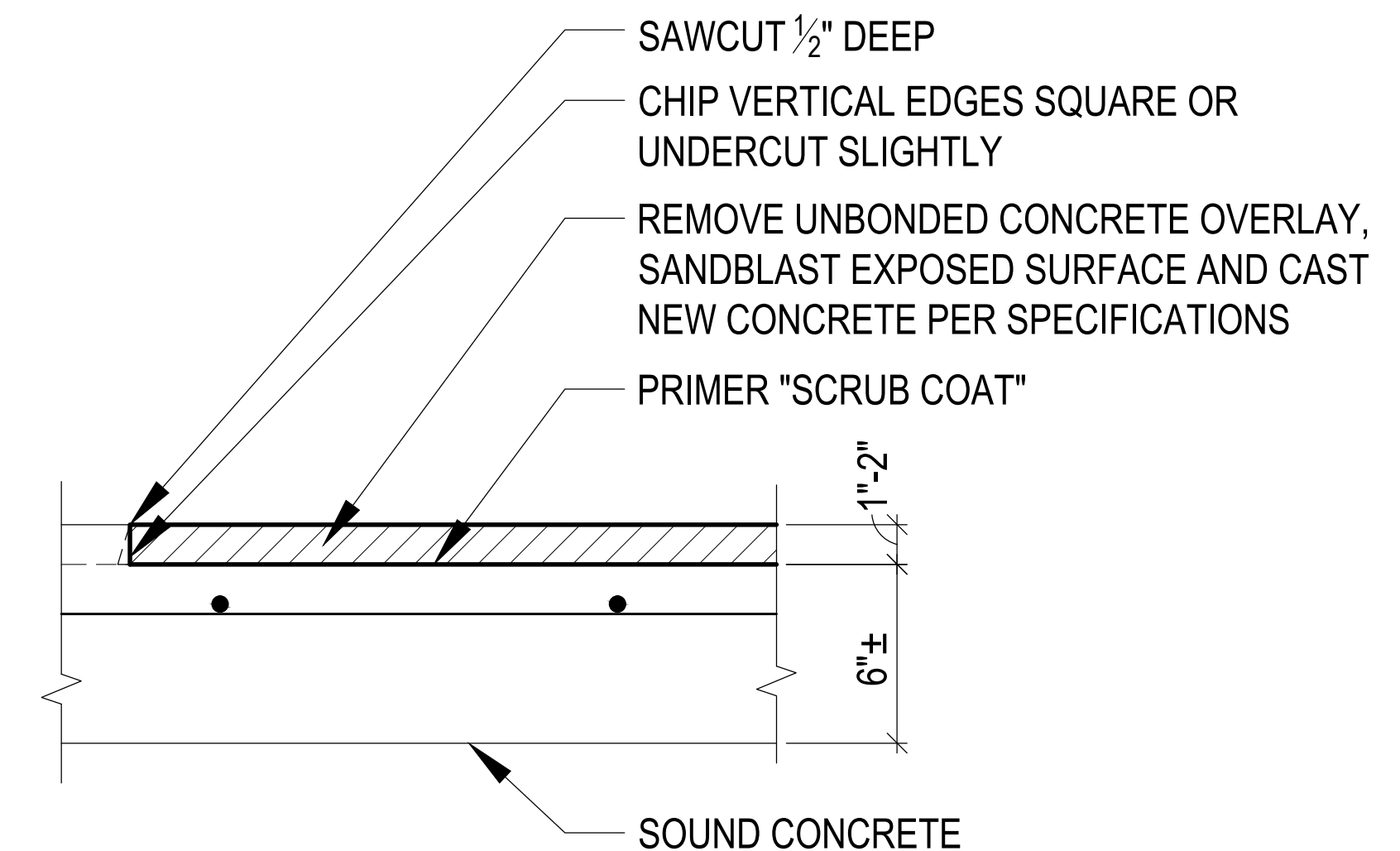

NOTE: REMOVAL OF CONCRETE TO TOP OF UNDERLYING REINFORCING IS AT NO ADDITIONAL CHARGE

3
 D-1
TOPSIDE SLAB RESTORATION
 SCALE : NTS (UNBONDED OVERLAY)

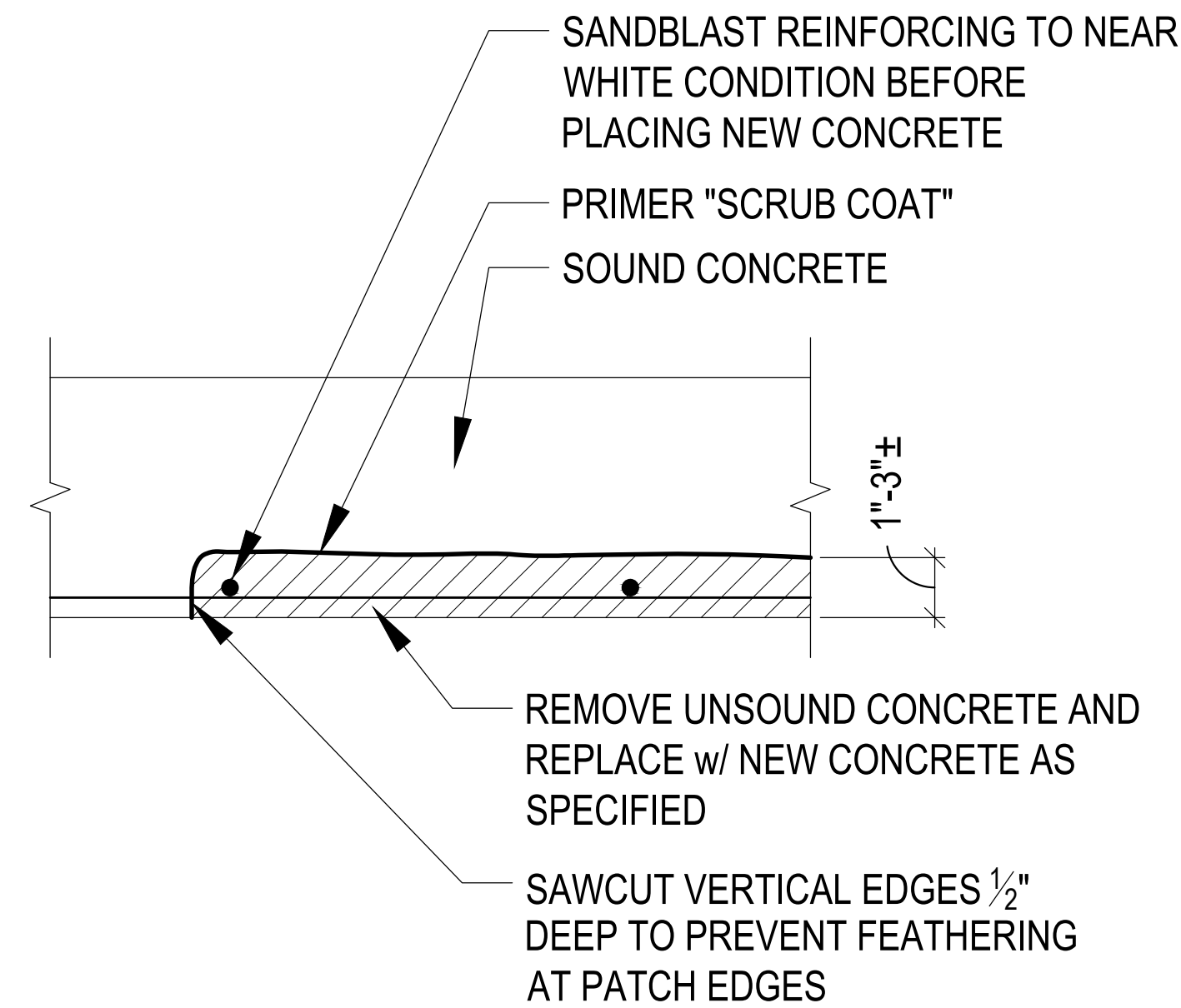

2
 D-1
UNDERSIDE SLAB RESTORATION
 SCALE : NTS

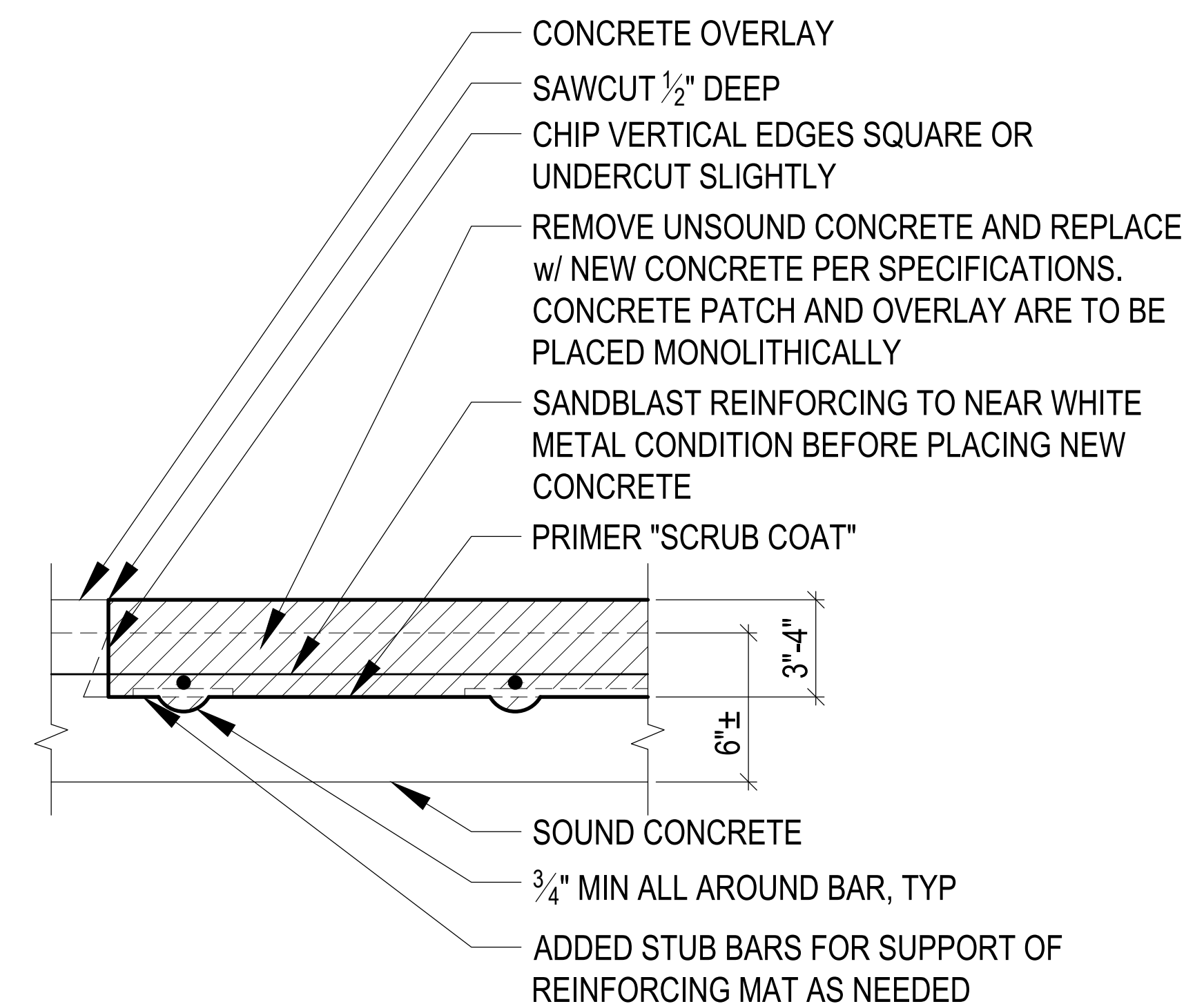

NOTE: REMOVAL OF CONCRETE BELOW SUPPORT BARS IS REQUIRED BY SPECIFICATION. NO ADDITIONAL PAYMENT FOR DEEPER REMOVAL IN THESE AREAS

6
 D-1
TOPSIDE SLAB RESTORATION
 SCALE : NTS (2 LAYERS REINFORCING)

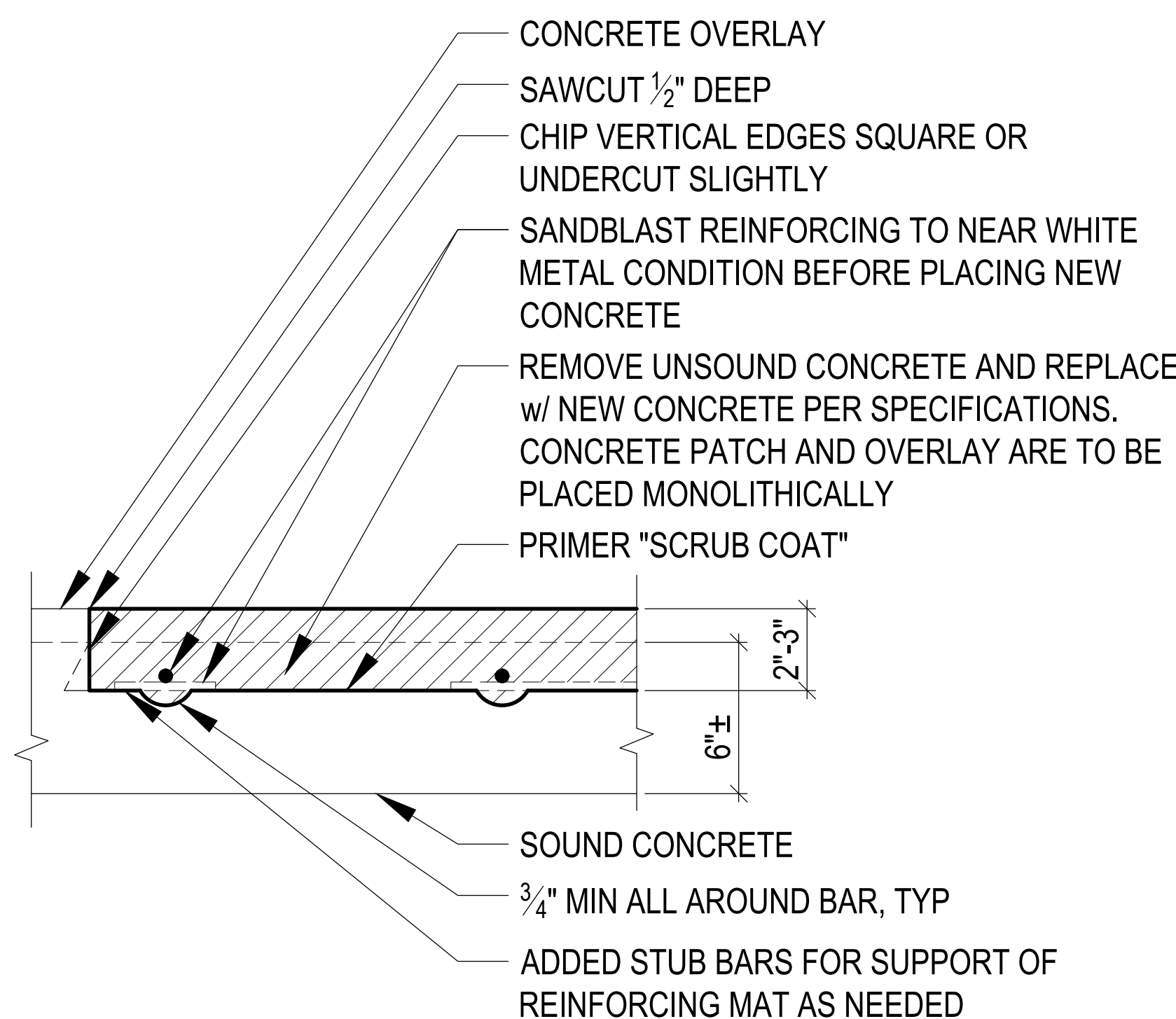

NOTE: REMOVAL OF CONCRETE BELOW SUPPORT BARS IS REQUIRED BY SPECIFICATION. NO ADDITIONAL PAYMENT FOR DEEPER REMOVAL IN THESE AREAS

5
 D-1
TOPSIDE SLAB RESTORATION
 SCALE : NTS (1 LAYER REINFORCING)

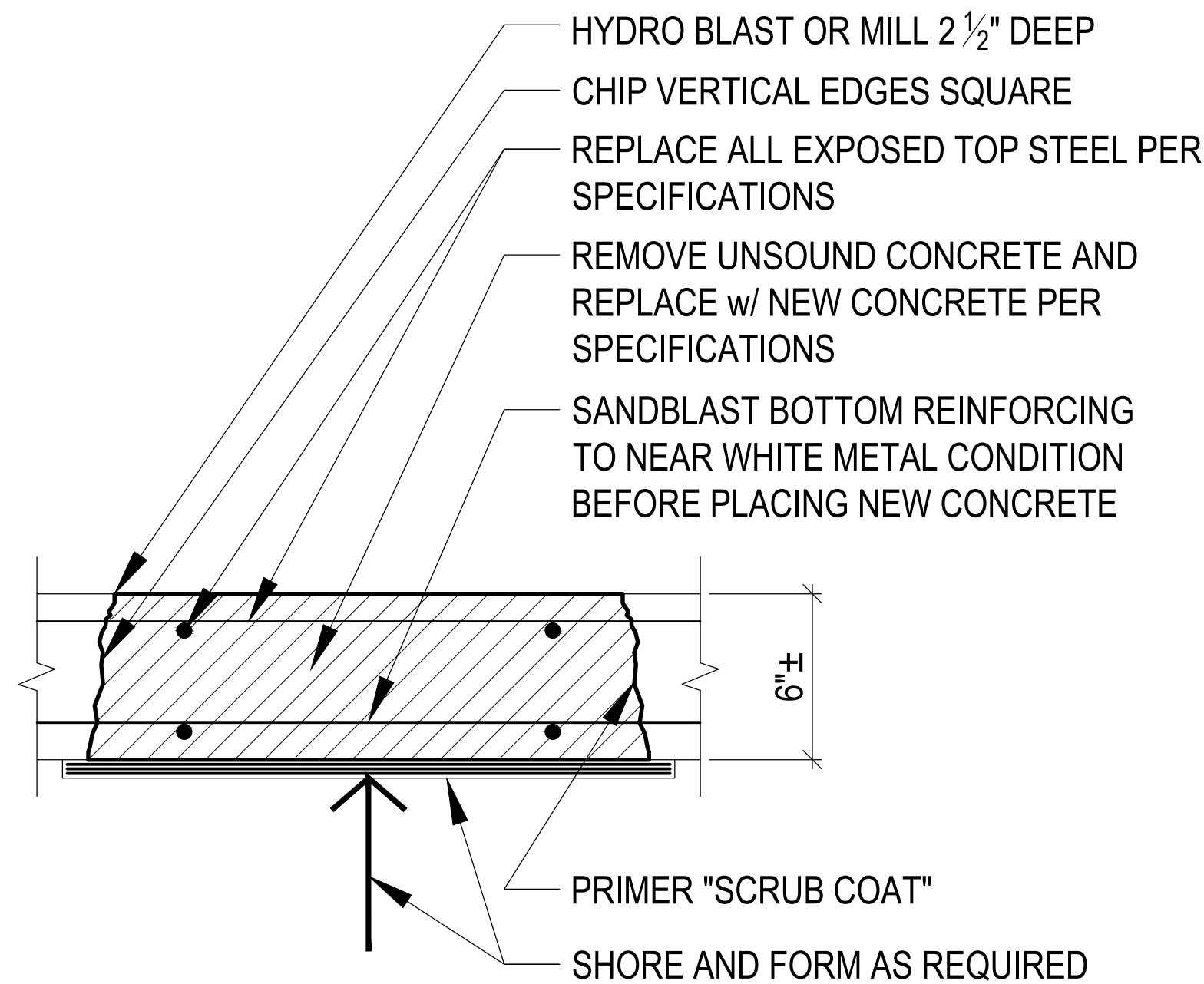

NOTE: REINFORCING SHOWN FOR REFERENCE ONLY. LOCATION AND SPACING TO BE FIELD VERIFIED

1
 D-1
FULL DEPTH SLAB REPLACEMENT
 SCALE : NTS

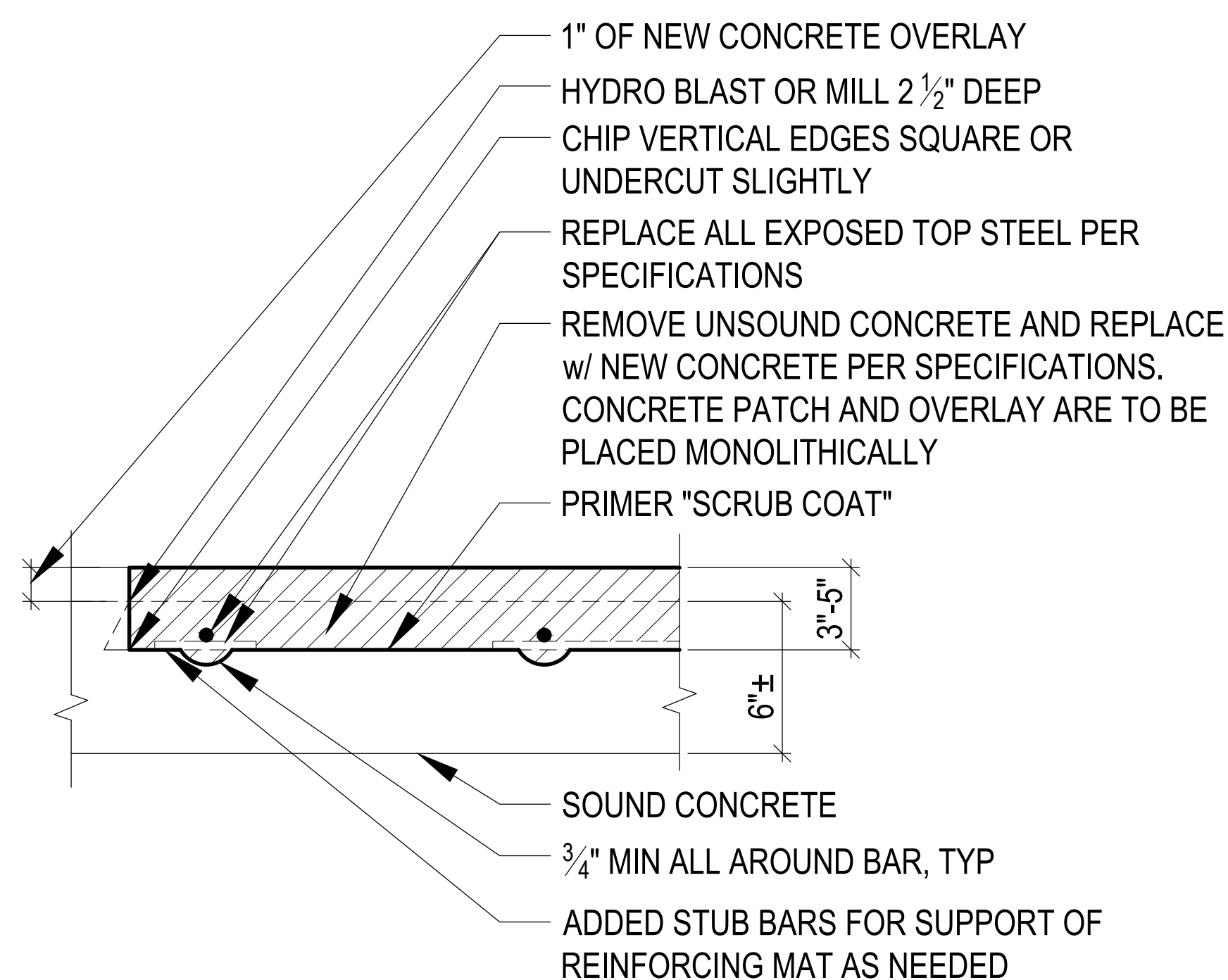

NOTE: REMOVAL OF CONCRETE BELOW SUPPORT BARS IS REQUIRED BY SPECIFICATION. ADDITIONAL PAYMENT FOR DEEPER REMOVAL IN THESE AREAS IS PERMITTED.

4
 D-1
TOPSIDE SLAB RESTORATION - LEVEL 7
 SCALE : NTS (HYDRO-DEMOLITION OR MILLING)

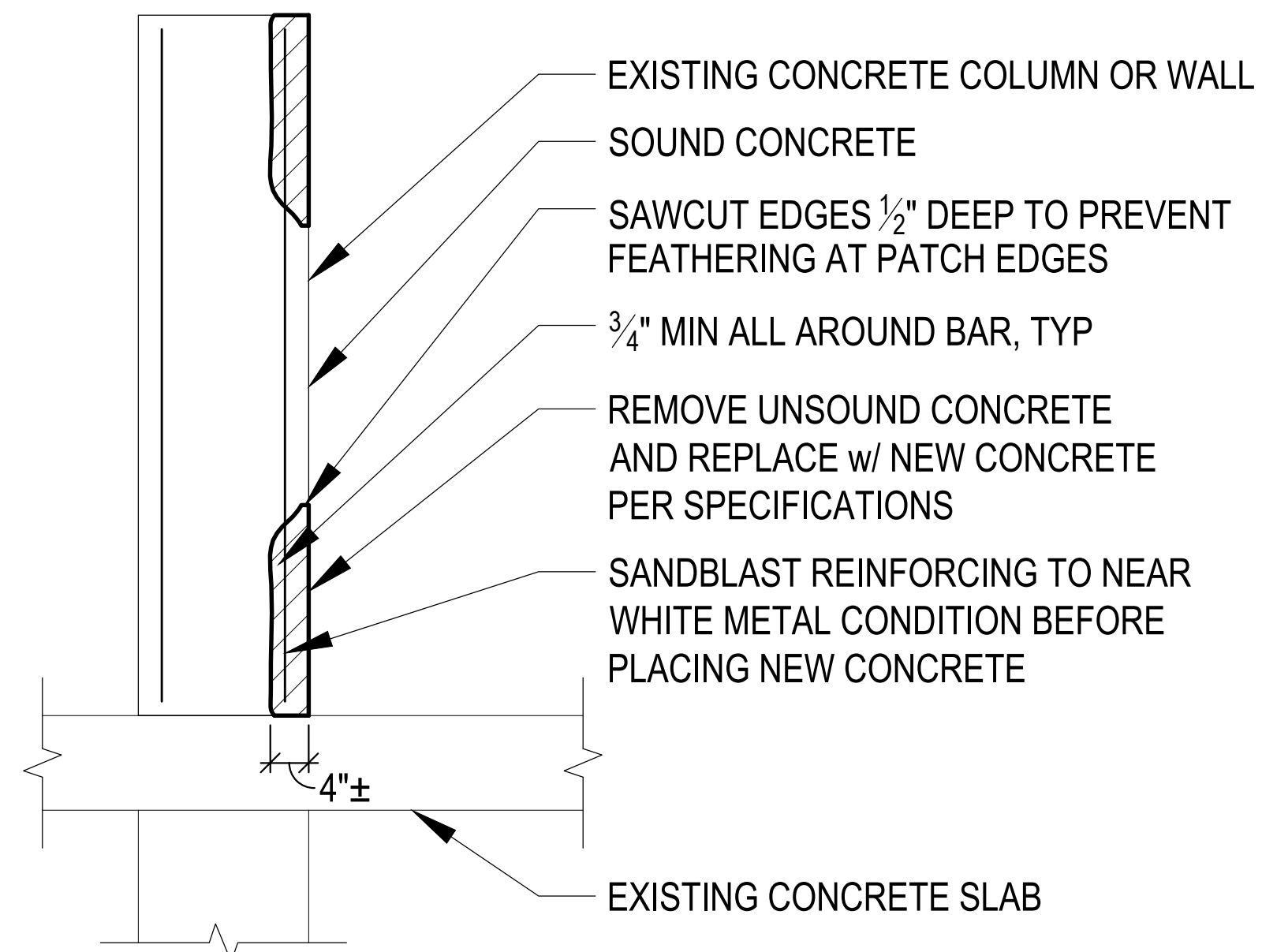

1
D-2
REPAIR AT VERTICAL SURFACES
SCALE : NTS

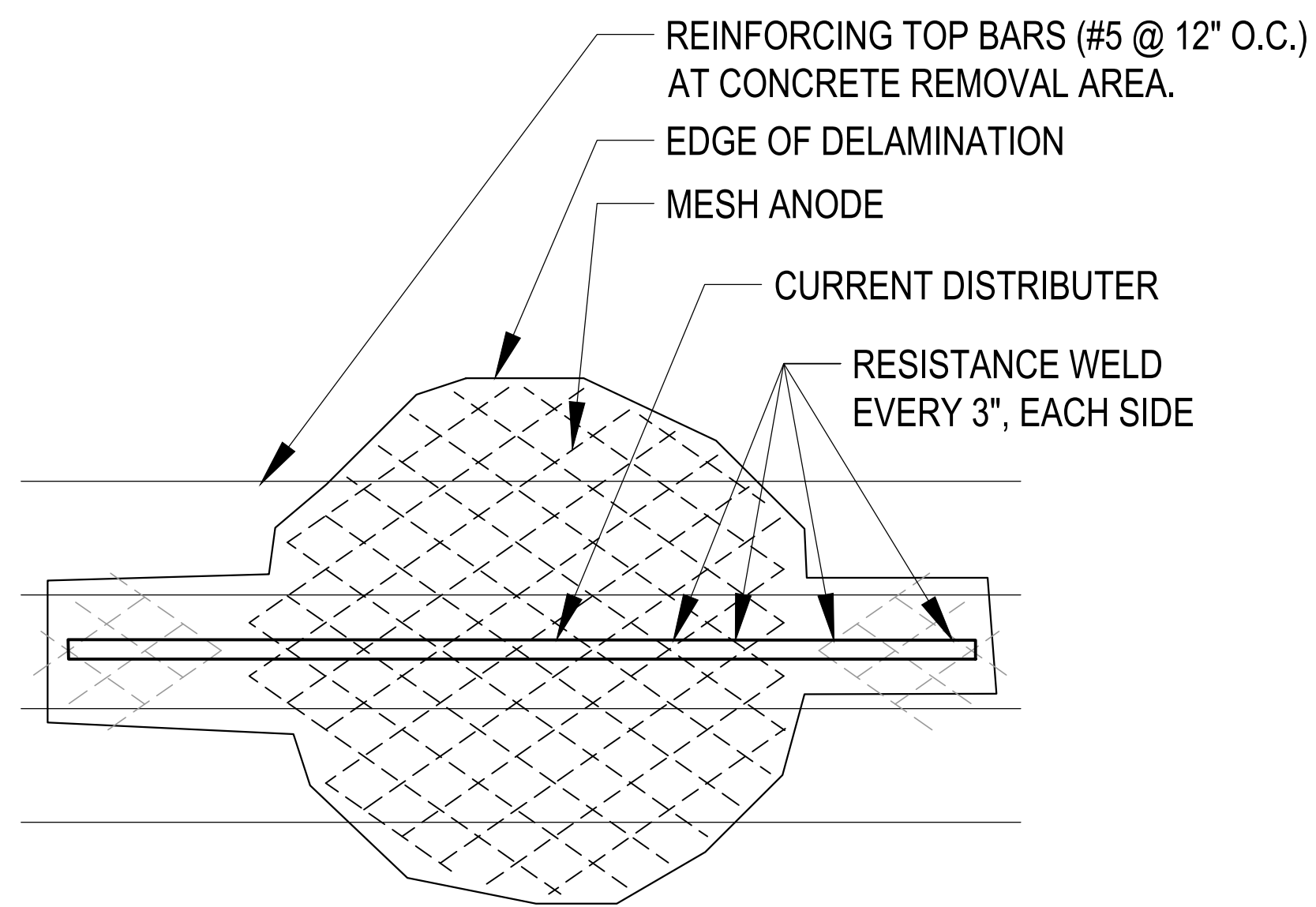

1. WITH A CONCRETE CHISEL, CAREFULLY EXPOSE TWO (2) DIAMONDS OF MESH AT EACH OF TWO (2) LOCATIONS ON OPPOSING SIDES OF THE EXCAVATION. MEASURE AND CUT A LENGTH OF CURRENT DISTRIBUTOR TO FIT ACROSS THE EXCAVATION, ENSURING THAT THE CURRENT DISTRIBUTOR IS SUFFICIENTLY LONG TO OVERLAP THE EXPOSED TWO (2) DIAMONDS ON EITHER SIDE. WELD THE CURRENT DISTRIBUTOR TO THE EXPOSED MESH AT THE JUNCTIONS OF THE DIAMONDS.
2. CUT A PIECE OF ELGARD MESH TO FIT THE SIZE OF EXCAVATION. PLACE THE NEW ELGARD MESH IN THE EXCAVATION. WELD THE NEW MESH TO THE CURRENT DISTRIBUTOR AT EACH JUNCTION POINT OR EVERY THREE (3) INCHES. FASTEN THE MESH TO THE CONCRETE CONCRETE USING THE XMAS TREE FASTENERS PROVIDED BY ELGARD CORPORATION.
3. IF THE ELIMINATION EXTENDS ACROSS THE WIDTH OF THE MESH, THEN ADDITIONAL CURRENT DISTRIBUTOR MUST BE USED TO SPLICE THE EMBEDDED MESH TO THE MESH USED FOR REPAIR. THIS STEP WILL ENSURE THAT THE PIECE OF MESH ON THE FAR SIDE OF THE REPAIR FROM THE POWER FEED IS ELECTRICALLY CONTINUOUS WITH THE NEW MESH.

2
D-2
CP ANODE REPLACEMENT @ REMOVAL AREA
SCALE : NTS

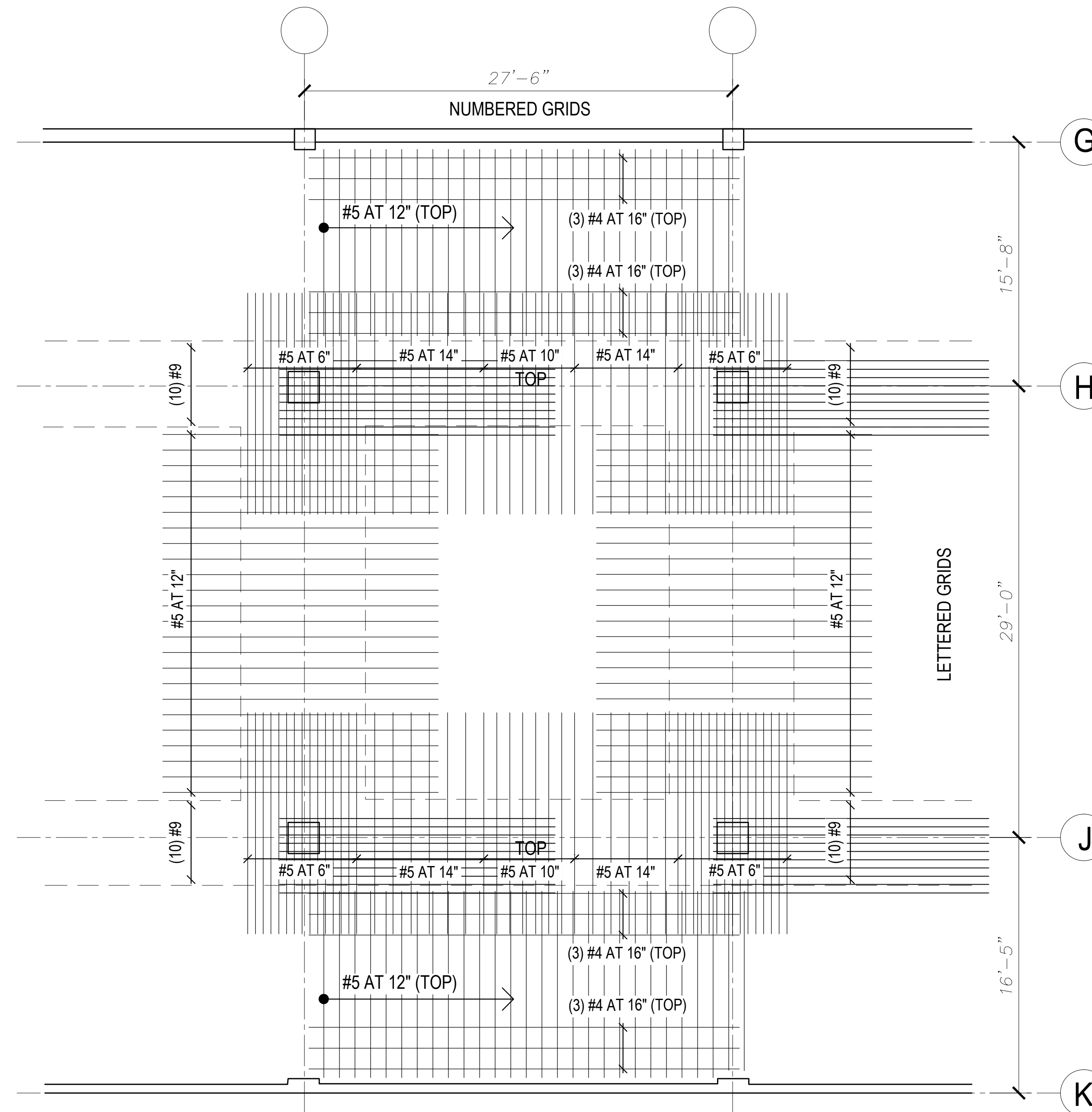

3
D-2
TOP STEEL REINFORCING LAYOUT
SCALE : 3/16" = 1'-0"

